

T3-110E-TW - R.5,85

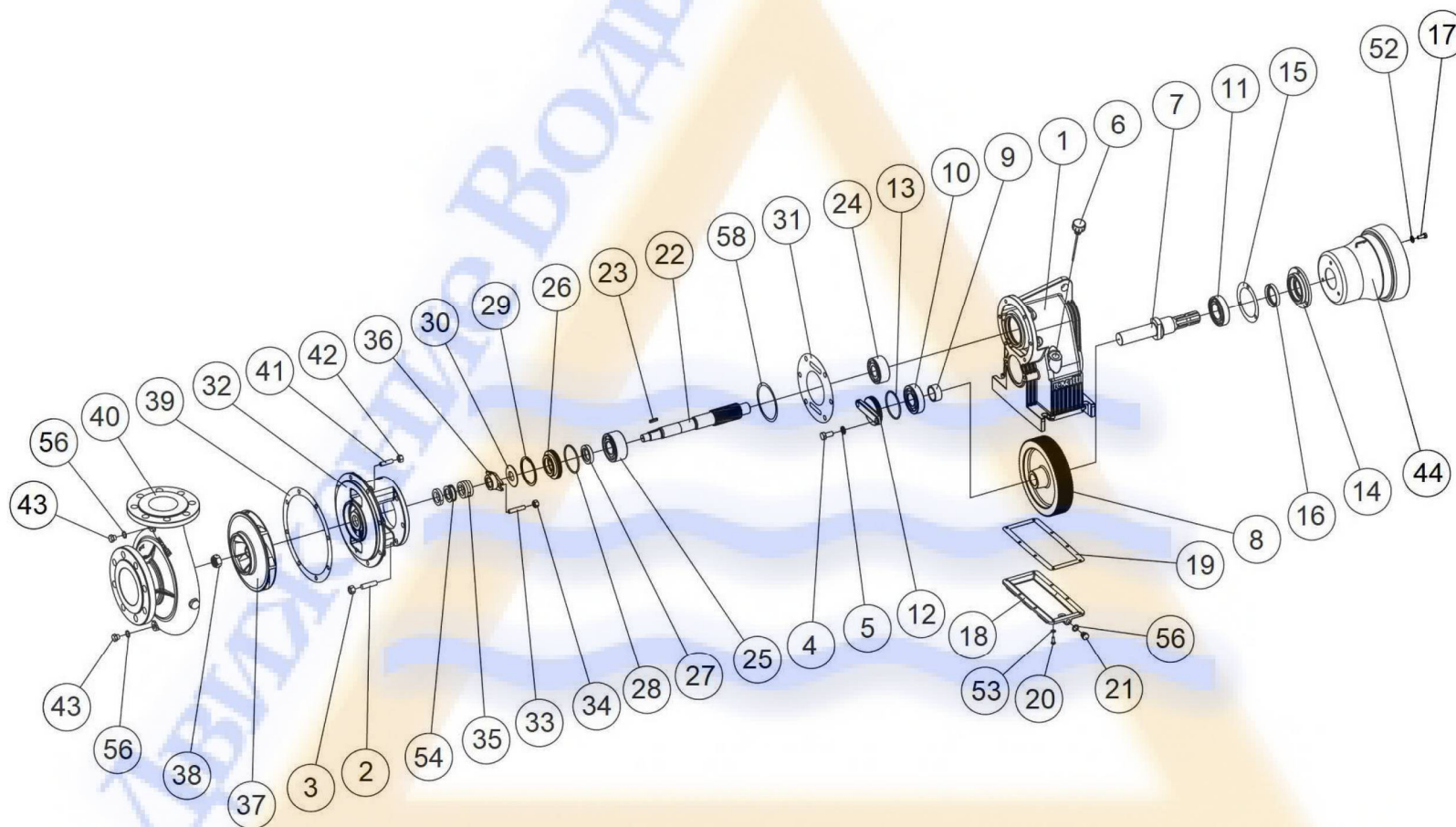

T3-110E-TW - R.5,85

Q		Code	Description	Qty
1		205153A/A	Gear box	1
2		3VP016	Stud bolt	6
3		3DEA012Z	Nut	6
4		3VTE027Z	Screw	2
5		3RE012Z	Washer	2
6		213820P	Breather plug	1
7		205131G	PTO shaft	1
8		205141G	Gear	1
9		205132N	Spacer	1
10		3CU009	Ball bearing	1
11		3CU134	Ball bearing	1
12		205129A/A	Cover	1
13		3OR004	O-Ring	1
14		205127A/A	Cover	1
15		205148F	Gasket	1
16		3AT010	Seal ring	1
17		3VTE002	Screw	3
18		205154B	Cover	1
19		205147F	Gasket	1
20		3VTE001Z	Screw	8

T3-110E-TW - R.5,85

			Code	Description	Qty
21			204470B	Magnetic plug	1
22			205137G	Shaft with pinion	1
23			3LI020	Key	1
24			3CU020	Ball bearing	1
25			3CU021	Ball bearing	1
26			205128A/A	Cover	1
27			3AT006	Seal ring	1
28			3OR004	O-Ring	1
29			3AFI008	Seeger	1
30			3AP003	Seal ring	1
31			205149F	Gasket	1
32			205135A	Pump support	1
33			3VP006T	Stud bolt	2
34			3DEA010T	Nut	2
35			205640F	Stuffing-box ring	4
36			214892T/A	Twiner stuffing-box flange	1
37			204418A00	Impeller	1
38			217274N	Self-locking nut	1
39			202374F	Gasket	1
40			203342A	Pump body	1

T3-110E-TW - R.5,85

			Code	Description	Qty
41			3VP003	Stud bolt	8
42			3DEA010Z	Nut	8
43			3NO019	Plug	2
44			204477P	Universal joint guard	1
52			3RB008T	Washer	3
53			3RB006	Washer	8
54			207219C	Hydraulic weir ring	1
56			3RA004	Washer	3
58			205464F	Gasket	1



Поставщик в Республике Беларусь Частное предприятие "Движение Воды"
 Тел.  +375(29)183-85-06  МТС+375(33)386-80-72  +375(17)515-23-69