

A	B	C	D
1	B18 115	2156	570 1/4
2	B18 116	2156	570 1/4
3	B18 903	1990	430 1/4
4	LH 1962	1962	14 1/4
5	B18 315	834	539 2/4
6	B18 404	834	117 2/4
7	B18 420	834	80 2/4
8	B18 504	745	120 2/4

A	B	C	D
9	B18 507	500	120 2/4
10	B18 508	500	120 2/4
11	B18 908	760	499 2/4
12	DR 829	829	2/4
13	B18 001	796	229 3/4
14	B18 005	1292	396 4/4
15	B18 014	1292	396 4/4

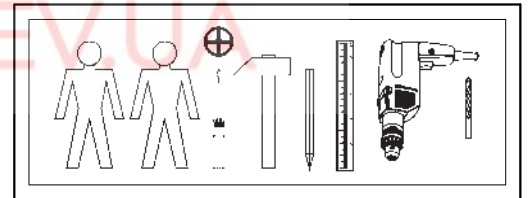
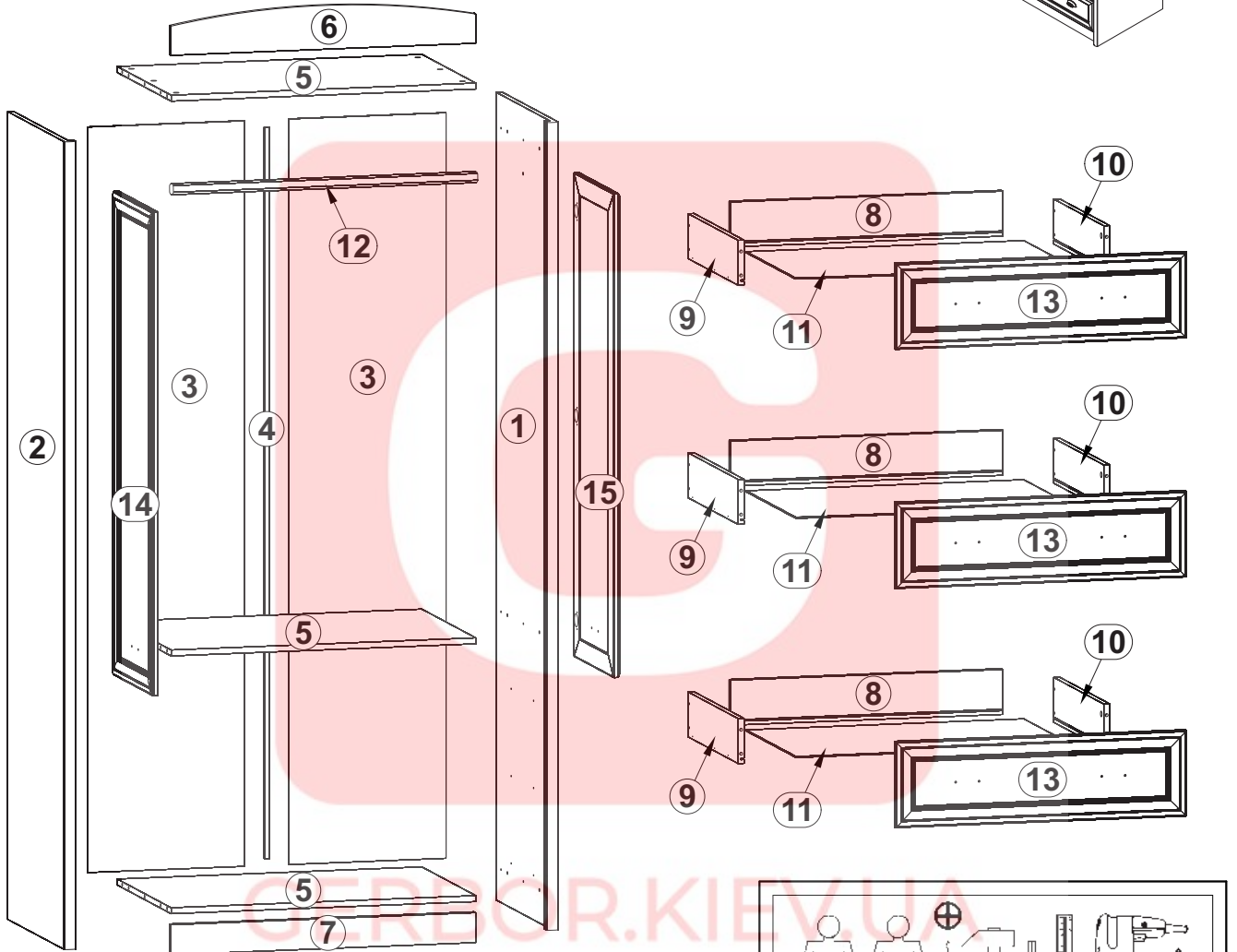
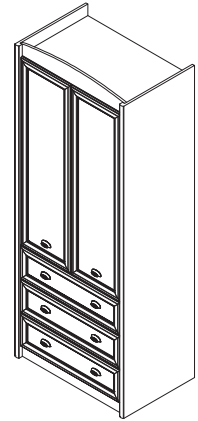

6x K16 a43	6x D22.5 b18	8x φ84 φ84	12x φ6.3x13 mm e2	18x φ6x28 mm e25	12x φ5x50 mm e32	20x φ8x30 mm f1	16x M4x10 mm j106
5x k1	75x l1	2x n1	1x n26\1	2x φ3,5x13 mm p1	6x φ3,5x16 mm p25	1x φ3,5x16 mm p38	12x φ3,5x15 mm p51
18x φ3x12 mm p54	30x φ15x12mm #16 r1	30x 20/11 r42	12x φ16 s2	3x 483 mm t17	3x 500 mm w26 ^{CL}	3x 500 mm w26 ^{CR}	3x 500 mm w26 ^{DL}
3x 500 mm w26 ^{DR}	18x h 16 mm w47						

1

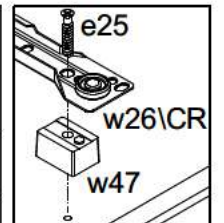
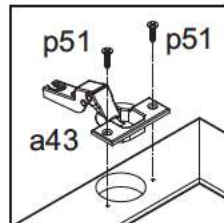
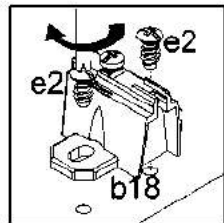
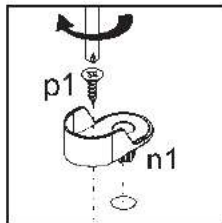
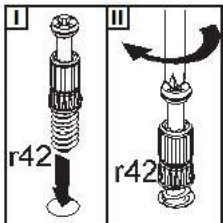
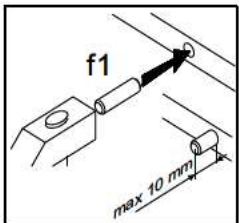
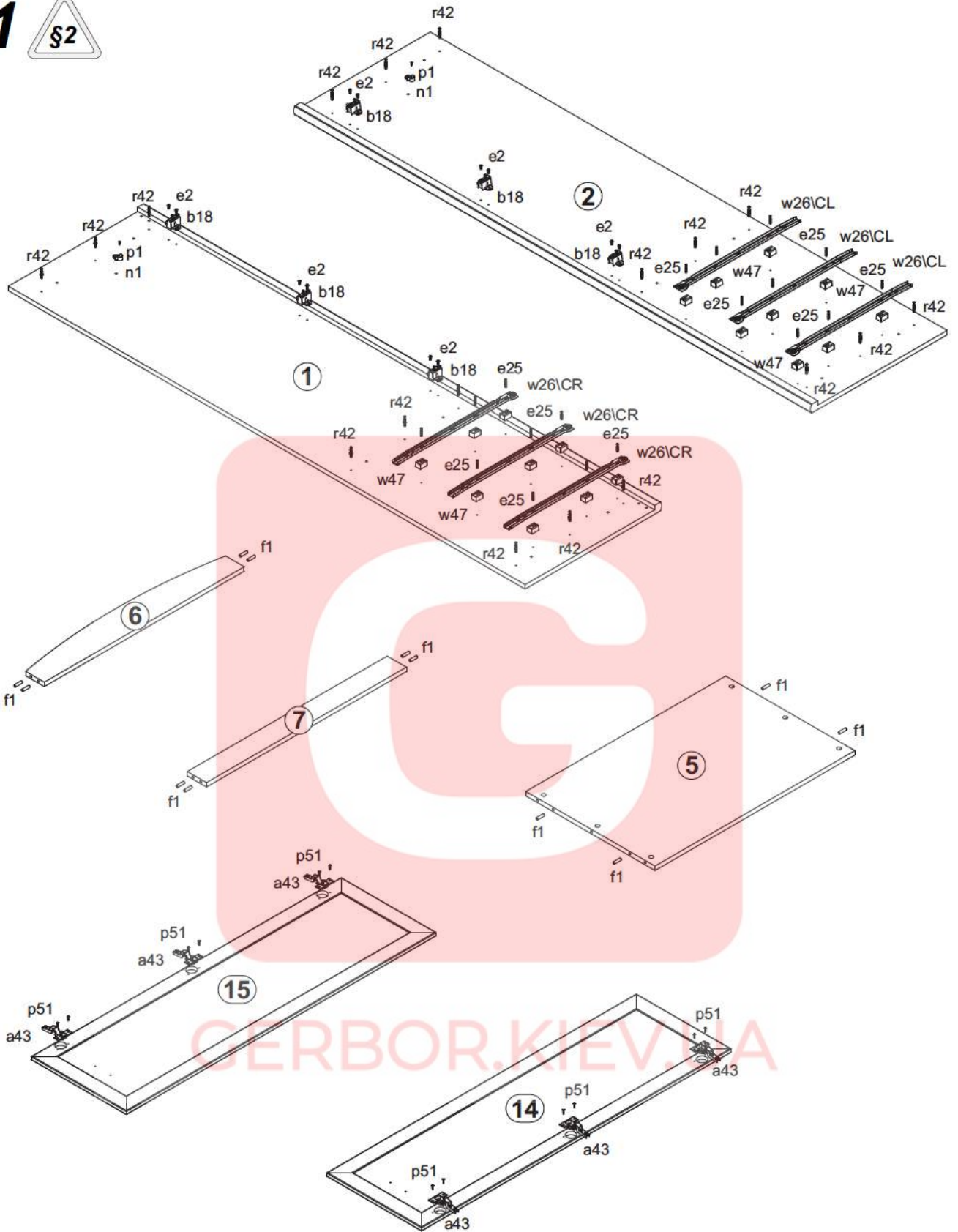

2

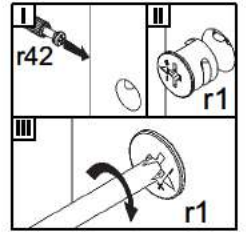
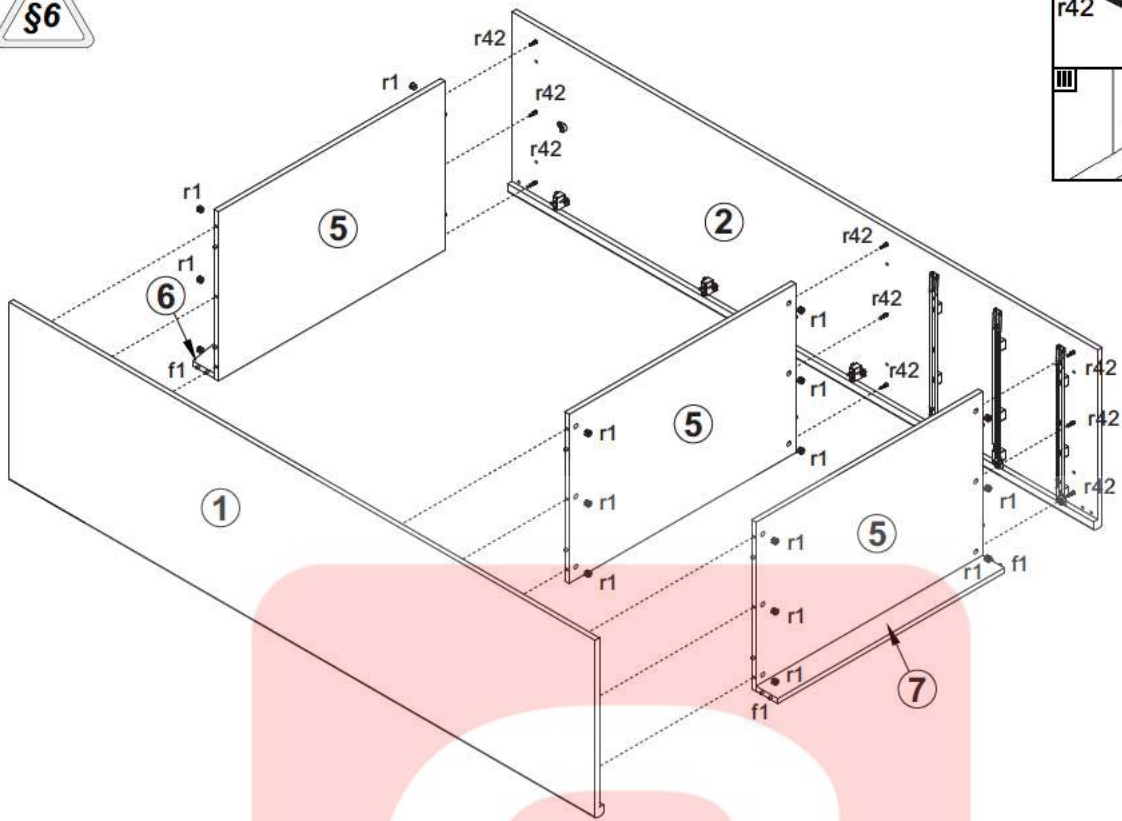

3

