

# CR 1620

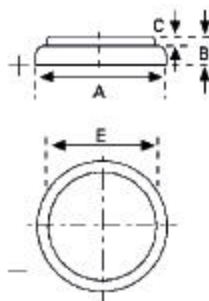

Type Number ..... 6620  
 Designation IEC ..... CR 1620  
 System ..... Li-Manganese dioxide/  
 Organic Electrolyte

UL Recognition ..... MH 13654 (N)  
 Nominal Voltage ..... 3 V  
 Typical Capacity C ..... 70 mAh (Load 20 kOhm,  
 at 20°C down to 2 V)

Weight (approx.) ..... 1,2 g  
 Volume ..... 0,4 ccm  
 Coding ..... Date of Manufacturing  
 Month/Year

Temperature Ranges min. max.  
 Storage ..... -55°C 70°C  
 Discharge ..... -20°C 70°C<sup>1</sup>

Dimensions min. max.  
 Diameter (A) ..... 15,70 16,00  
 Height (B) ..... 1,80 2,00  
 Shoulder Diameter [E] ..... 12,90  
 Shoulder Height [C] ..... 0,20

## Typical Capacities (at 20°C)

Discharge Type	Load	End Voltage: 2,0 V
Continuous 24 h/d, 7 d/w Current [µA]	20000 Ω	Time: 500 h Capacity: 70 mAh Energy: 200 mWh

## Performance Data

### Temperature Characteristics

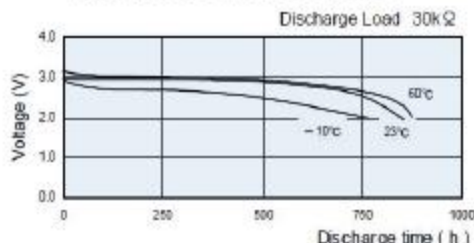

### Operating Voltage vs. load resistance\*

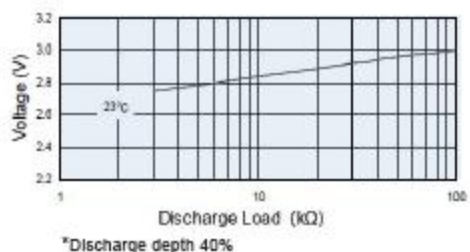

### Capacity vs. load resistance

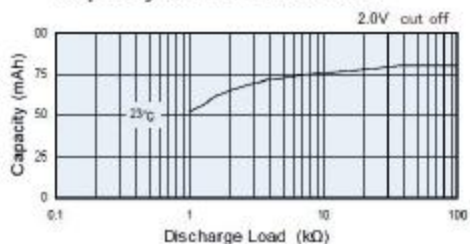

### Discharge Characteristics

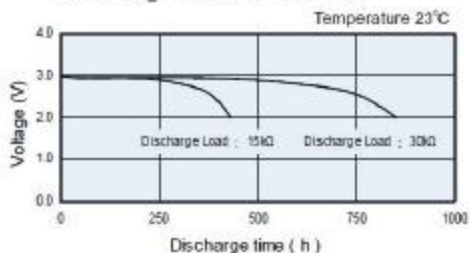

<sup>1</sup> Contact VARTA if the application is intended to be outside the range of -20°C to +70°C.

<sup>2</sup> depending on environmental condition and energy consumption

- Self-discharge rate < 1% at room temperature
- Storage life > 10 years
- Operating life<sup>2</sup> > 10 years