

### 1. TEE YS/90

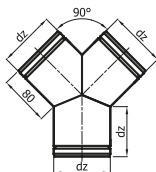

"Spiro" diameter	ø80	ø100	ø110	ø115	ø120	ø125	ø130	ø140	ø150	ø160	ø180	ø200
dz	78	98	108	113	118	123	128	138	148	158	178	198
Weight [kg]	0.23	0.26	0.27	0.28	0.29	0.33	0.35	0.38	0.42	0.45	0.51	0.56

#### YS x / 90 - OC

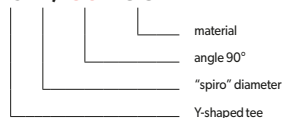

Destination	W	W - ventilation
	O	O - air heating
Material	OC	OC - galvanised steel sheet

### 2. TEE YS/120

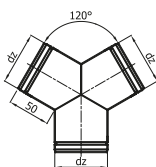

"Spiro" diameter	ø80	ø100	ø110	ø115	ø120	ø125	ø130	ø140	ø150	ø160	ø180	ø200
dz	78	98	108	113	118	123	128	138	148	158	178	198
Weight [kg]	0.19	0.21	0.22	0.23	0.24	0.26	0.28	0.30	0.33	0.34	0.38	0.42

#### YS x / 120 - OC

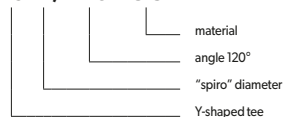

Destination	W	W - ventilation
	O	O - air heating
Material	OC	OC - galvanised steel sheet

### 3. TEE TRS/90

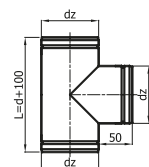

"Spiro" diameter	ø80	ø100	ø110	ø115	ø120	ø125	ø130	ø140	ø150	ø160	ø180	ø200
dz	78	98	108	113	118	123	128	138	148	158	178	198
Weight [kg]	0.23	0.30	0.35	0.38	0.40	0.43	0.45	0.50	0.57	0.62	0.72	0.80

#### TRS x / 90 - OC



Destination	W	W - ventilation
	O	O - air heating
Material	OC	OC - galvanised steel sheet

### 4. TEE TRS/45

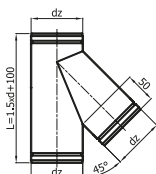

"Spiro" diameter	ø80	ø100	ø110	ø115	ø120	ø125	ø130	ø140	ø150	ø160	ø180	ø200
dz	78	98	108	113	118	123	128	138	148	158	178	198
Weight [kg]	0.33	0.48	0.55	0.61	0.66	0.71	0.76	0.87	0.98	1.05	1.15	1.28

#### TRS x / 45 - OC

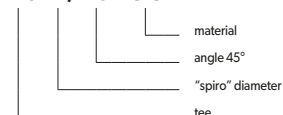

Destination	W	W - ventilation
	O	O - air heating
Material	OC	OC - galvanised steel sheet

### 5. REDUCING TEE YRS/90

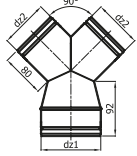

"Spiro" diameter	ø100-2xø80		ø125-2xø100		ø150-2xø100		ø150-2xø125		ø160-2xø125		ø160-2xø100		ø200-2xø150		ø200-2xø160	
dz1 / dz2	98	78	123	98	148	98	148	123	158	123	158	98	198	148	198	158
Weight [kg]	0.30		0.35		0.39		0.40		0.40		0.40		0.50		0.52	

#### YRS x-2x y / 90 - OC

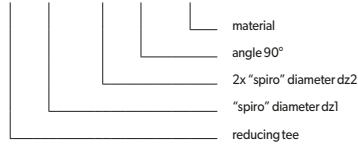

Destination	W	W - ventilation
	O	O - air heating
Material	OC	OC - galvanised steel sheet

### 6. REDUCING TEE YRS/120

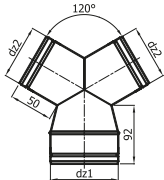

"Spiro" diameter	ø100-2xø80		ø125-2xø100		ø150-2xø125		ø150-2xø100		ø160-2xø125		ø160-2xø100		ø200-2xø150		ø200-2xø160	
dz1 / dz2	98	78	123	98	148	123	148	98	158	123	158	98	198	148	198	158
Weight [kg]	0.28		0.30		0.35		0.35		0.35		0.35		0.50		0.52	

#### YRS x-2x y / 120 - OC

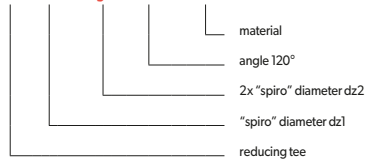

Destination	W	W - ventilation
	O	O - air heating
Material	OC	OC - galvanised steel sheet

### 7. ADJUSTABLE ELBOW KNS/90

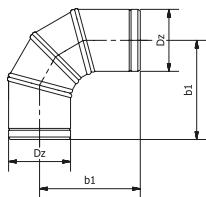

"Spiro" diameter	ø80	ø90	ø100	ø110	ø115	ø120	ø125	ø130	ø135	ø140	ø150	ø160	ø180	ø200
b1 [mm]	156	161	166	168	168	168	170	170	170	178	185	199	205	213
Weight [kg]	0.30	0.35	0.39	0.43	0.45	0.47	0.48	0.51	0.55	0.70	0.75	0.87	1.00	1.14

#### KNS x / 90 - OC

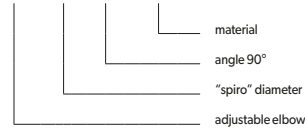

Destination	W	W - ventilation
	O	O - air heating
Material	OC	OC - galvanised steel sheet

### 8. ADJUSTABLE ELBOW KNS/30

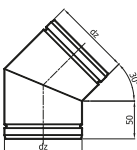

"Spiro" diameter	ø80	ø100	ø110	ø115	ø120	ø125	ø130	ø140	ø150	ø160	ø180	ø200
dz	78	98	108	113	118	123	128	138	148	158	178	198
Weight [kg]	0.18	0.25	0.29	0.31	0.33	0.35	0.38	0.42	0.45	0.48	0.58	0.63

#### KNS x / 30 - OC

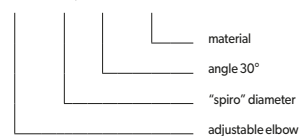

Destination	W	W - ventilation
	O	O - air heating
Material	OC	OC - galvanised steel sheet

### 9. QUADRUPED TEE CZO/90

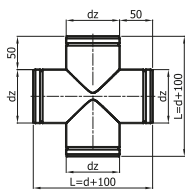

"Spiro" diameter	ø80	ø100	ø110	ø115	ø120	ø125	ø130	ø140	ø150	ø160	ø180	ø200
dz	78	98	108	113	118	123	128	138	148	158	178	198
Weight [kg]	0.27	0.35	0.38	0.41	0.43	0.45	0.47	0.52	0.58	0.63	0.84	1.00

#### CZO x/90 - OC

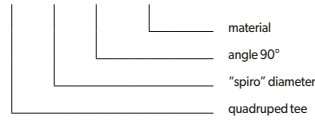

Destination	W	W - ventilation
	O	O - air heating
Material	OC	OC - galvanised steel sheet

### 10. QUADRUPED TEE CZO/45

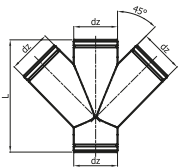

"Spiro" diameter	ø80	ø100	ø110	ø115	ø120	ø125	ø130	ø140	ø150	ø160	ø180	ø200
dz	78	98	108	113	118	123	128	138	148	158	178	198
Weight [kg]	0.50	0.58	0.66	0.73	0.79	0.88	0.92	1.05	1.18	1.26	1.38	1.54

#### CZO x/45 - OC

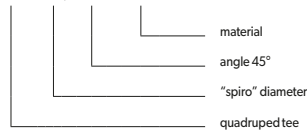

Destination	W	W - ventilation
	O	O - air heating
Material	OC	OC - galvanised steel sheet

### 11. QUADRUPED REDUCING TEE CZOR/90

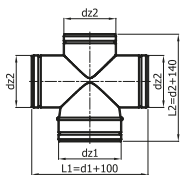

"Spiro" diameter	ø125-3xø80	ø125-3xø100	ø150-3xø100	ø150-3xø125
dz1 / dz2	123/78	123/98	148/98	148/123
Weight [kg]	0.35	0.45	0.52	0.58

Destination	W	W - ventilation
	O	O - air heating
Material	OC	OC - galvanised steel sheet

#### CZOR x/3xy/90 - OC

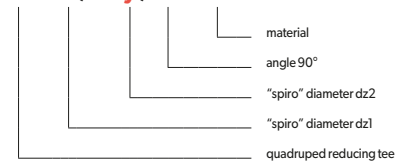

### 12. QUADRUPED REDUCING TEE CZOR/45

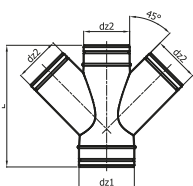

"Spiro" diameter	ø125-3xø80	ø125-3xø100	ø150-3xø100	ø150-3xø125
dz1 / dz2	123/78	123/98	148/98	148/123
Weight [kg]	0.85	0.88	1.05	1.18

Destination	W	W - ventilation
	O	O - air heating
Material	OC	OC - galvanised steel sheet

#### CZOR x/3xy/45 - OC

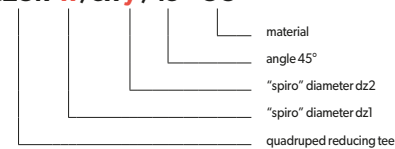

### 13. DAMPER PJS/1 (FOR PVC PIPES)

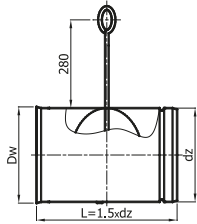

"Spiro" diameter	ø110	ø160	ø200
dz	108	158	198
Dw	110	160	200
Weight [kg]	0.29	0.58	0.96

Destination	W	W - ventilation
	O	O - air heating
Material	OC	OC - galvanised steel sheet

#### PJS x/1 - OC

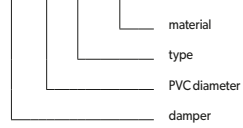

### 14. DAMPER PJS/2

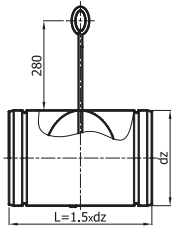

"Spiro" diameter	ø80	ø100	ø110	ø115	ø120	ø125	ø130	ø140	ø150	ø160	ø180	ø200
dz	78	98	108	113	118	123	128	138	148	158	178	198
Weight [kg]	0.18	0.26	0.29	0.30	0.33	0.35	0.38	0.45	0.50	0.58	0.71	0.84

#### PJS x/2 - OC

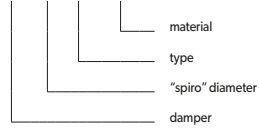

Destination	W	W - ventilation
	O	O - air heating
Material	OC	OC - galvanised steel sheet

### 15. DAMPER PJS/3

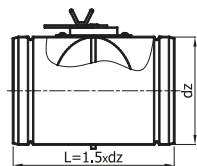

"Spiro" diameter	ø80	ø100	ø110	ø115	ø120	ø125	ø130	ø140	ø150	ø160	ø180	ø200
dz	78	98	108	113	118	123	128	138	148	158	178	198
Weight [kg]	0.18	0.26	0.29	0.30	0.33	0.35	0.38	0.45	0.50	0.58	0.71	0.84

#### PJS x/3 - OC

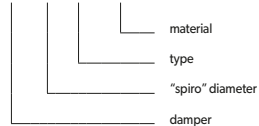

Destination	W	W - ventilation
	O	O - air heating
Material	OC	OC - galvanised steel sheet

### 16. DAMPER WITH WIRE CORD PJS/C

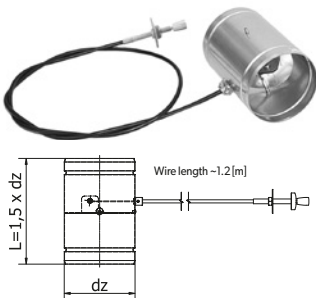

"Spiro" diameter	ø80	ø100	ø110	ø115	ø120	ø125	ø130	ø140	ø150	ø160	ø180	ø200
dz	78	98	108	113	118	123	128	138	148	158	178	198
Weight [kg]	0.38	0.46	0.50	0.52	0.55	0.58	0.60	0.64	0.70	0.77	0.93	1.15

#### PJS x/C - OC

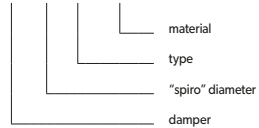

Destination	W	W - ventilation
	O	O - air heating
Material	OC	OC - galvanised steel sheet

### 17. DAMPER WITH WIRE CORD AND SEAL PJSS



"Spiro" diameter	ø80	ø100	ø110	ø115	ø120	ø125	ø130	ø140	ø150	ø160	ø180	ø200
dz	78	98	108	113	118	123	128	138	148	158	178	198
Weight [kg]	0.45	0.50	0.57	0.59	0.62	0.66	0.67	0.73	0.80	0.87	1.03	1.25

#### PJSS x/C-OC-SILICON

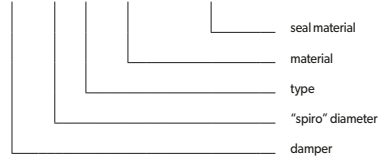

Destination	W	W - ventilation
	O	O - air heating
PJSS/...SILICON	W	Maximal temperature of flowing air: 150°C
	O	
Material	OC	OC - galvanised steel sheet

### 18. DAMPER WITH WIRE CORD AND SEAL PJSS/C/OS

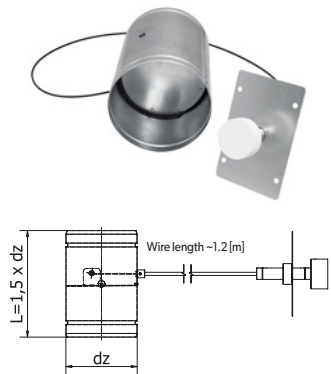

"Spiro" diameter	ø80	ø100	ø110	ø115	ø120	ø125	ø130	ø140	ø150	ø160	ø180	ø200
dz	78	98	108	113	118	123	128	138	148	158	178	198
Weight [kg]	0.45	0.50	0.57	0.59	0.62	0.66	0.67	0.73	0.80	0.87	1.03	1.25

#### PJSS x/C/OS/P-ML... - OC-SILICON

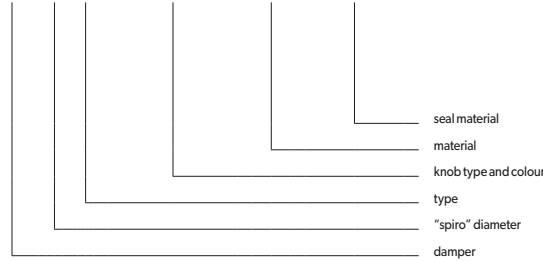

Destination	W	W - ventilation
	O	O - air heating
PJSS/...SILICON	W	Maximal temperature of flowing air: 150°C
	O	
Material	OC	OC - galvanised steel sheet
Knob colour	ML	B - white
	ML	CZ - black

### 19. LATCH ZAS

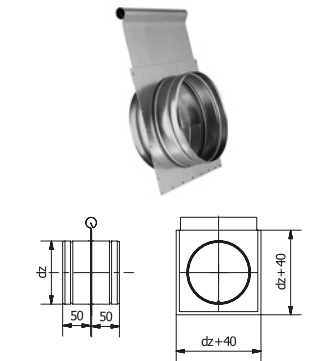

"Spiro" diameter	ø80	ø100	ø110	ø115	ø120	ø125	ø130	ø140	ø150	ø160	ø180	ø200
dz	78	98	108	113	118	123	128	138	148	158	178	198
Weight [kg]	0.20	0.30	0.35	0.38	0.40	0.43	0.45	0.50	0.55	0.60	0.75	0.90

#### ZAS x-OC



Destination	W	W - ventilation
	O	O - air heating
Material	OC	OC - galvanised steel sheet

### 20. SUMMER-WINTER TEE TZL

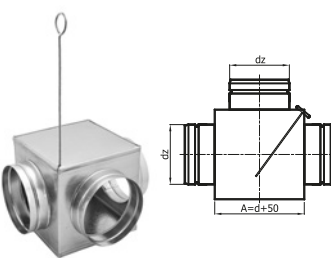

"Spiro" diameter	ø80	ø100	ø110	ø115	ø120	ø125	ø130	ø140	ø150	ø160	ø180	ø200
dz	78	98	108	113	118	123	128	138	148	158	178	198
Weight [kg]	0.60	0.75	0.85	0.90	0.95	1.00	1.05	1.15	1.25	1.35	1.50	1.65

#### TZL x-OC

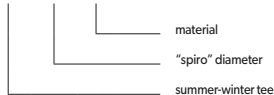

Destination	W	W - ventilation
	O	O - air heating
Material	OC	OC - galvanised steel sheet

## 21. SUMMER-WINTER TEE WITH WIRE CORD TZL/C

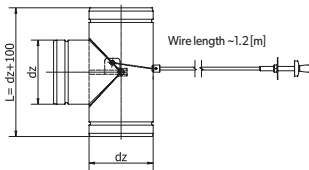

"Spiro" diameter	ø80	ø100	ø110	ø115	ø120	ø125	ø130	ø140	ø150	ø160	ø180	ø200
dz	78	98	108	113	118	123	128	138	148	158	178	198
Weight [kg]	0.53	0.60	0.65	0.68	0.70	0.73	0.75	0.80	0.87	0.92	1.02	1.10

**TZL/C ... - OC**

- material
- "spiro" diameter
- tee with wire cord

Destination	W	W - ventilation
	O	O - air heating
Material	OC	OC - galvanised steel sheet

## 22. SUMMER-WINTER TEE WITH WIRE CORD TZL/C/OS

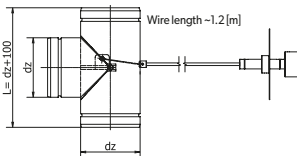

"Spiro" diameter	ø80	ø100	ø110	ø115	ø120	ø125	ø130	ø140	ø150	ø160	ø180	ø200
dz	78	98	108	113	118	123	128	138	148	158	178	198
Weight [kg]	0.53	0.60	0.65	0.68	0.70	0.73	0.75	0.80	0.87	0.92	1.02	1.10

**TZL/C ... / OS/P-ML... - OC**

- material
- knob type and colour
- "spiro" diameter
- tee with wire cord

Destination	W	-	W - ventilation
	-	O	O - air heating
Material	OC	OC	OC - galvanised steel sheet
	ML	ML	B - white
Knob colour	ML	ML	CZ - black

## 23. Δ-TYPE TEE WITH DAMPER YPS

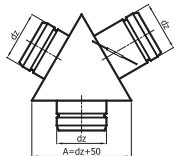

"Spiro" diameter	ø80	ø100	ø110	ø115	ø120	ø125	ø130	ø140	ø150	ø160	ø180	ø200
dz	78	98	108	113	118	123	128	138	148	158	178	198
Weight [kg]	0.45	0.55	0.65	0.68	0.71	0.75	0.80	0.85	0.95	1.00	1.15	1.30

**YPS x - OC**

- material
- "spiro" diameter
- Δ-type tee with damper

Destination	W	W - ventilation
	O	O - air heating
Material	OC	OC - galvanised steel sheet

## 24. ROUND FILTER (CHANNEL TYPE) FOK

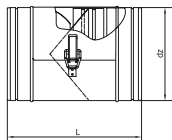

"Spiro" diameter	ø100	ø125	ø150	ø160	ø180	ø200
dz	98	123	148	158	178	198
L	200	210	225	230	240	250
Weight [kg]	0.60	0.90	1.20	1.30	1.40	1.50

**FOK / x / FM - OC**

- material
- metal filter
- "spiro" diameter
- round filter

Destination	W	W - ventilation
	O	O - air heating
Material	OC	OC - galvanised steel sheet
	FM	FM - metal filter

## 25. ROUND FILTER (CHANNEL TYPE) - REPLACEMENT FILTER FOK

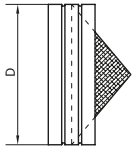
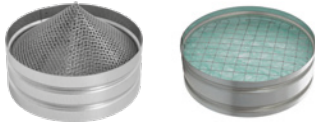

### FM-FOK - x - STOZEK



### FW-FOK - x - PASTYLKA

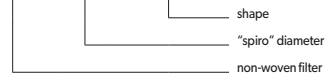

"Spiro" diameter	ø100	ø125	ø150	ø160	ø180	ø200
D	97	122	147	157	177	197
Weight [kg]	0.11	0.17	0.23	0.25	0.28	0.30

Destination	W	W - ventilation
	O	O - air heating
Material	OC	OC - galvanised steel sheet

- Temperature resistance:
- FM: 250°C
  - FW: 120°C

## 26. DIRECTIONAL VALVE ZZ

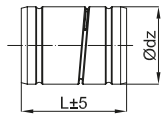

"Spiro" diameter	ø80	ø100	ø110	ø115	ø120	ø125	ø130	ø140	ø150	ø160	ø180	ø200	ø250	ø315
dz	78	98	108	113	118	123	128	138	148	158	178	198	248	313
L	103	103	103	117	117	117	117	134	134	152	172	192	242	305
Weight [kg]	0.16	0.20	0.23	0.26	0.28	0.30	0.31	0.38	0.40	0.47	0.60	0.72	1.13	1.78

### ZZ x - CH

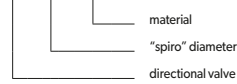

Destination	W	W - ventilation
	O	O - air heating
Material	CH	CH - chrome-nickel steel sheet

## 27. AIR OUTLET KSP

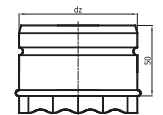

"Spiro" diameter	ø80	ø100	ø110	ø115	ø120	ø125	ø130	ø140	ø150	ø160	ø180	ø200
dz	78	98	108	113	118	123	128	138	148	158	178	198
Weight [kg]	0.08	0.08	0.08	0.08	0.08	0.10	0.10	0.10	0.12	0.12	0.14	0.16

### KSP x - OC

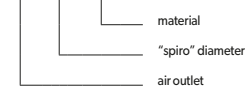

Destination	W	W - ventilation
	O	O - air heating
Material	OC	OC - galvanised steel sheet

## 28. ROUND AIR INTAKE CZNP

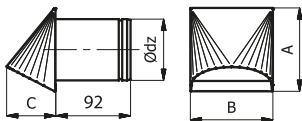
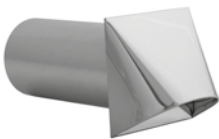

"Spiro" diameter	ø80	ø100	ø110	ø125	ø150	ø160	ø180	ø200
dz	79	99	108	123	148	158	178	198
A	105	147	147	147	197	197	228	228
B	104	146	146	146	196	196	226	226
C	62	87	87	87	117	117	134	134
Weight [kg]	0.48	0.53	0.53	0.62	0.78	0.80	0.85	0.95

### CZNP x - m



Destination	W	W - ventilation
	CH	CH - chrome-nickel steel sheet
Material	OC	OC - galvanised steel sheet
	ML	ML - galvanised steel sheet powder coated

## 29. ROUND AIR INTAKE CZNP II

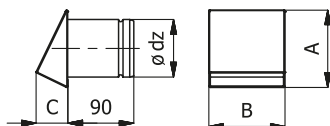

"Spiro" diameter	ø80	ø100	ø110	ø125	ø150	ø160	ø180	ø200
dz	79	99	108	123	148	158	178	198
A	106	147	147	147	197	197	228	228
B	104	146	146	146	196	196	226	226
C	44	60	60	60	80	80	91	91
Weight [kg]	0.21	0.33	0.34	0.34	0.54	0.54	0.67	0.67

### CZNP-II x - m

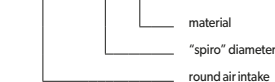

Destination	W	W - ventilation
	CH	CH - chrome-nickel steel sheet
Material	OC	OC - galvanised steel sheet
	ML	ML - galvanised steel sheet powder coated

### 30. ROUND AIR INTAKE RAINSTOP CZNP-RS

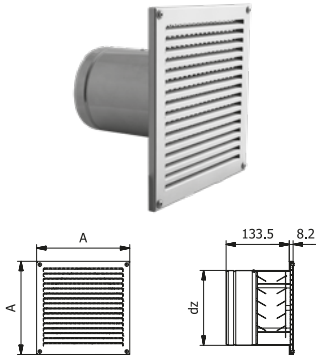

"Spiro" diameter	ø80	ø100	ø110	ø125	ø150	ø160	ø180	ø200
dz	79	99	108	123	148	158	178	198
A	197	197	197	197	197	197	227	227
Weight [kg]	0.60	0.70	0.70	0.80	0.90	0.90	1.10	1.30

#### CZNP x - m - RS

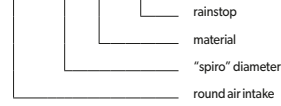

Destination	W	W - ventilation
Material	CH	CH - chrome-nickel steel sheet
	ML	ML - chrome-nickel sheet powder coated

### 31. EXTENSION PO

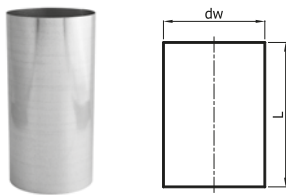

"Spiro" diameter	ø80	ø100	ø110	ø115	ø120	ø125	ø130	ø140	ø150	ø160	ø180	ø200
dw	79.4	99.4	109.3	114.4	119.3	124.3	129.5	139.4	149.4	159.3	179.3	199.4

Available lengths L = 150, 200, 250 [mm]

#### PO x - L - OC



Destination	W	W - ventilation
	O	O - air heating
Material	OC	OC - galvanised steel sheet

### 32. PLUGS ZS AND ZSR

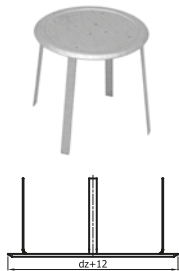

#### ZS x - OC

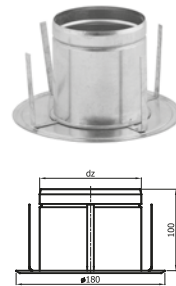
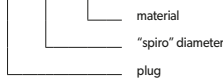

#### ZSR x - OC

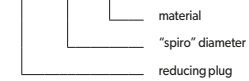

"Spiro" diameter	ø80	ø100	ø110	ø115	ø120	ø125	ø130	ø140	ø150	ø160	ø180	ø200
dz	78	98	108	113	118	123	128	138	148	158	178	198
Weight [kg]	0.11	0.13	0.14	0.15	0.16	0.17	0.17	0.18	0.20	0.22	0.26	0.31

Destination	W	W - ventilation
	O	O - air heating
Material	OC	OC - galvanised steel sheet

### 33. TUBING CLAMP OPS

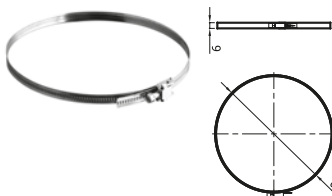

#### OPS x - CH

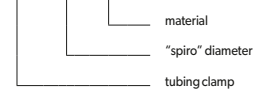

"Spiro" d diameter range	ø80-160	ø160-200
Weight [kg]	0.025	0.032

Destination	W	W - ventilation
	O	O - air heating
Material	CH	CH - chrome-nickel steel sheet

### 34. ALUMINIUM TAPE TA50

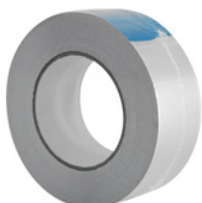

#### TA 50xL/T

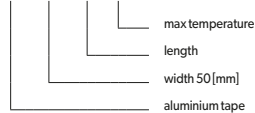

Symbol	Length L [m]			Weight [kg]
	5	10	50	
TA50x.../150	-	0.11	0.48	0.48
TA50x.../350	0.07	0.11	0.48	

TA50x.../150 - max. working temperature: 150 [°C]  
TA50x.../350 - max. inst. temperature: 350 [°C]

Destination	W	W - ventilation
	O	O - air heating
Material	AL	AL - aluminium



### 35. ROSETTE ROZ

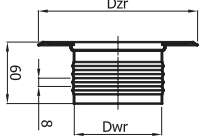

Diameter DN	ø80	ø85	ø90	ø95	ø100	ø105	ø110	ø115	ø120	ø125	ø130	ø135
Dwr [mm]	86	91	96	101	106	111	116	121	126	131	136	141
DZR [mm]	157	162	167	172	177	182	187	192	207	212	217	222
Weight [kg]	0.12	0.12	0.13	0.13	0.14	0.15	0.16	0.17	0.18	0.18	0.19	0.20

Diameter DN	ø140	ø145	ø150	ø160	ø180	ø200	ø225	ø250	ø280	ø300	ø315	ø350	ø400	ø450	ø500
Dwr [mm]	146	151	156	166	186	206	231	256	286	306	321	356	406	456	506
DZR [mm]	227	242	247	257	277	297	322	347	377	397	412	448	498	548	598
Weight [kg]	0.21	0.22	0.23	0.25	0.28	0.30	0.34	0.37	0.41	0.44	0.46	0.51	0.58	0.65	0.72

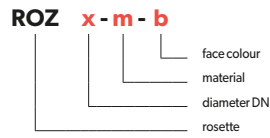

Destination	W	W	W	W - ventilation ducts
Material	CH	-	-	CH - chrome steel H17
Sheet thickness	-	OC	-	OC - galvanised steel sheet
	-	-	ML	ML - mild steel powder coated*

\* powder coated - white colour standard

### 36. INNER CONNECTOR ZWS

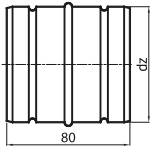

"Spiro" diameter	ø80	ø100	ø110	ø115	ø120	ø125	ø130	ø140	ø150	ø160	ø180	ø200
dz	78	98	108	113	118	123	128	138	148	158	178	198
Weight [kg]	0.10	0.12	0.13	0.14	0.15	0.16	0.16	0.17	0.19	0.20	0.23	0.26



Destination	W	W - ventilation
Material	O	O - air heating
	OC	OC - galvanised steel sheet

### 37. REDUCER RDS

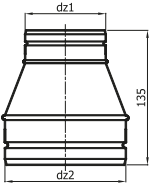

"Spiro" diameter	ø80	ø100	ø110	ø115	ø120	ø125	ø130	ø140	ø150	ø160	ø180	ø200
dz1	78	98	108	113	118	123	128	138	148	158	178	198
dz2	98	108	113	118	123	128	133	143	158	178	198	223

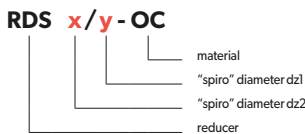

Destination	W	W - ventilation
Material	O	O - air heating
	OC	OC - galvanised steel sheet

### 38. MOUNTING BRACKET UMO

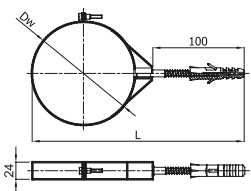

Diameter DN	ø80	ø100	ø110	ø120	ø130	ø140	ø150	ø160	ø180	ø200	ø250
Dw	80	100	110	120	130	140	150	160	180	200	250
L	180	200	210	220	230	240	250	260	280	300	350
Weight [kg]	0.08	0.10	0.12	0.12	0.12	0.13	0.14	0.21	0.28	0.30	0.34



Destination	W	W - ventilation
Material	O	O - air heating
	CH	CH - chrome-nickel steel sheet 1.4301

### 39. MOUNTING BRACKET WITH TUBING CLAMP UMS

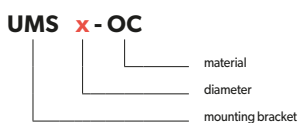
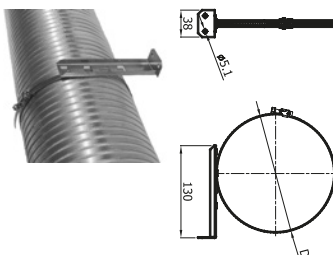

"Spiro" d diameter range	ø80-160
Weight [kg]	0.07

Destination	W	W - ventilation
Material	O	O - air heating
	OC	OC - galvanised steel sheet