

Note: All rights reserved. Specifications, terms and pictures on the catalogue are subject to change.
Please consult us for more products information.

BIOBASE[®]

Specialist in Lab Freezers and Refrigerators



BIOBASE GROUP

Add: No.9 Gangxing Road, High-tech Zone,
Jinan City, Shandong Province, China
Tel: +86-531-81219803
Email: export@biobase.com
Website: www.biobase.cc / www.biobase.com



Version 2024-1

CERTIFICATES

INTRODUCTION

BIOBASE Group is a professional manufacturer of laboratory equipments since 1999. We are certified by CE, ISO13485, ISO9001, etc. Our main cold chain system products are Blood bank refrigerator, Laboratory refrigerator, -25°C Freezer, -40°C Freezer, -60°C Freezer, -86°C Ultra-low temperature Freezer, Freezer racks and boxes, Car refrigerator, Portable refrigerator, Freeze Dryer, Portable refrigerator, Ice maker, etc. We have 25 factories, our customers are located in more than 190 countries around the world. Pursuing the highest quality is the tenet of BIOBASE.

E-mail: export@biobase.com
www.biobase.cc / www.biobase.com



ISO9001



ISO13485



CE



Screenshot of FDA Query Link



Content

	4°C Blood Bank Refrigerator-----	2
	2~8°C Laboratory Refrigerator-----	6
	-25°C Freezer-----	15
	-30°C Freezer-----	21
	-40°C Freezer-----	22
	-60°C Freezer-----	29
	-86°C Freezer-----	32
	-150°C Freezer-----	39
	Freezer Racks and Boxes-----	40
	Platelet Incubator-----	42
	Freeze Dryer-----	44
	Blood Transport Box-----	50
	Portable Refrigerator-----	51
	Biosafety Transport Box-----	52
	Flake Ice Maker & Cube Ice Machine-----	54

Blood Bank Refrigerator(4±1°C)

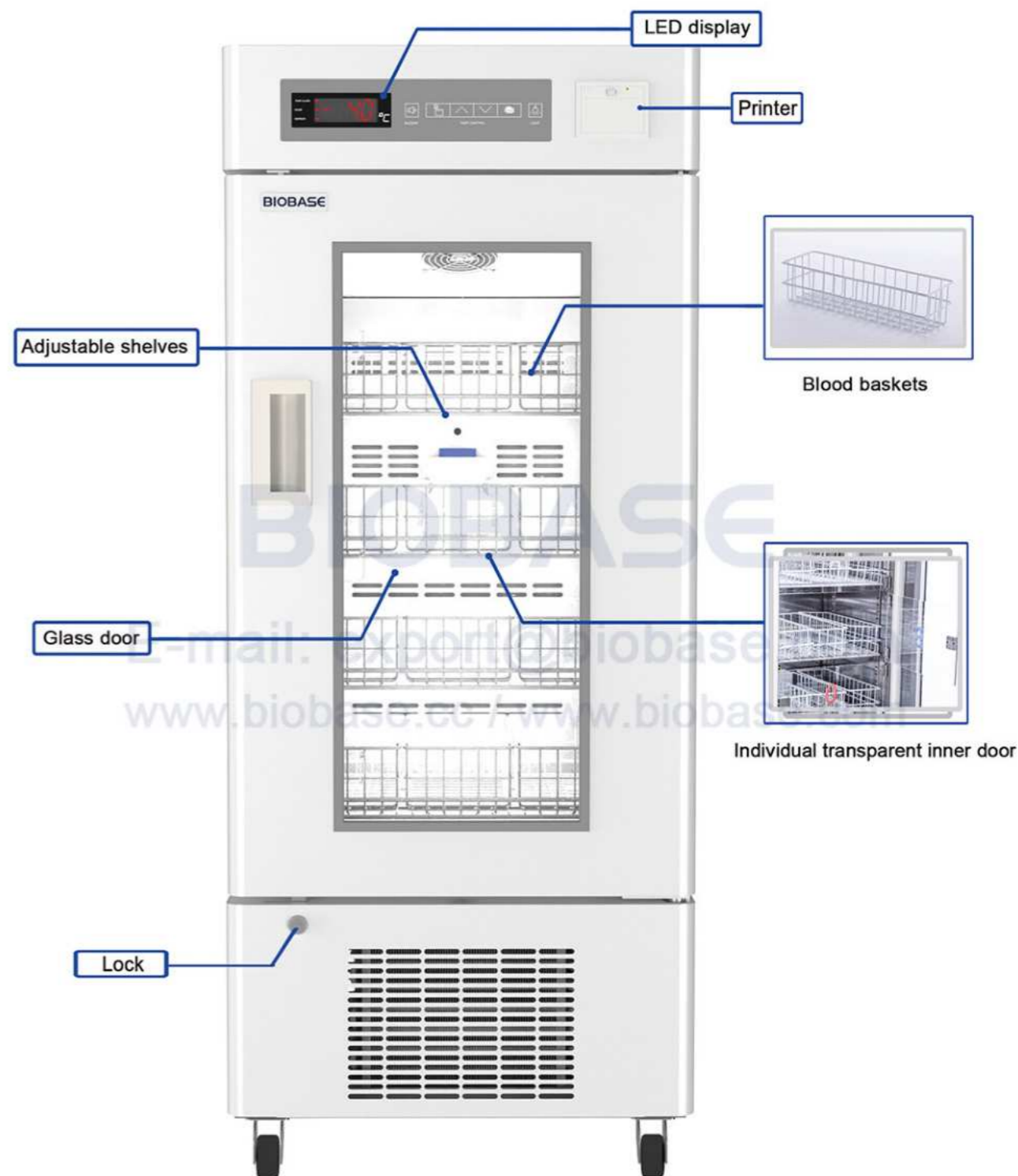

Blood Bank Refrigerator

Advantage

1. Multiple sensors design: make sure the precise monitoring and programming.
2. Unibody Design, Mono-assembly foaming (Rigid polyurethane insulation material).
3. Forced air refrigeration system, ensure inner temperature constant and uniform.
4. Adjustable shelves, improve space utilization; blood storage baskets can be classified.
5. Individual transparent inner door, effectively reduce cool air loss when opening the door.



86L

136L

296L

356L

466L

Technical Parameters

Model	BBR-4V86	BBR-4V136	BBR-4V296	BBR-4V356	BBR-4V466
Capacity	86L	136L	296L	356L	466L
Temp. Range	4±2°C				
Temp. Accuracy	0.1°C				
Control System	Microprocessor control				
Display	LED display				
Alarm	Audio and visual alarm for: High or low temperature, Sensor & system failure; Door ajar, Power failure				
Refrigeration Type	Forced air refrigeration system				
Refrigerant	R134a, CFC-Free				
Compressor	International famous compressor				
Condenser & Evaporator	High efficiency air-cooled condenser; Made of copper				
Defrost	Frostless design				
Construction	Unibody Design, Mono-assembly foaming (Rigid polyurethane insulation material)				
Material	Internal Material	Stainless steel			
	External Material	Sprayed steel plate			
Door	Electric heated glass semi-foamed door with lock, Acrylic inner door		Electric heating glass outer door; Acrylic inner door; Outer door with locking buckle		Electric heated glass semi-foamed door with lock, Acrylic inner door
Consumption	245W	252W	267W	352W	380W
Power Supply	AC220V±10%, 50Hz (Standard); AC110/220V,60Hz (Optional)				AC220V±10%, 50Hz (Standard)
Casters	Two universal casters with brakes, two directional casters				
Adjustable Shelves	2pcs	4pcs	4pcs	5pcs	5pcs
Baskets	6pcs	12pcs	12pcs	15pcs	20pcs
Blood Bags (450ml)	66pcs (450ml)	99pcs (450ml)	156pcs (450ml)	195pcs (450ml)	300pcs (450ml)
Standard Accessory	Thermal printer, LED lamp, The temperature test box, probe access port, door key				
Optional Accessory	Temperature recorder				
External Size(W*D*H) mm	530*660*1037	530*660*1287	630*720*1658	630*720*1886	680*747*1886
Package Size(W*D*H)mm	680*740*1330	685*750*1560	780*840*1910	770*830*2070	820*910*2080
Gross Weight	103kg	120kg	160kg	175kg	199kg

Blood Bank Refrigerator (Double Door)



Introduction:

Blood bank refrigerator series products are applied to places needing storage at constant temperature, such as hospitals, epidemic prevention stations, blood banks, scientific research institutions, colleges and universities, biological pharmacies, genetic engineering, etc. The storing temperature in the body can be regulated by the temperature button on the control panel. The application is convenient and the performance is reliable.

Advantage:

1. Multiple sensors design: make sure the precise monitoring and programming.
2. Electric heated glass semi-foamed door, easy to observe, also keep a better cooling temperature.
3. Forced air refrigeration system, ensure inner temperature constant and uniform.
4. Adjustable shelves, improve space utilization; blood storage baskets can be classified.
5. Individual transparent inner door, effectively reduce cool air loss when opening the door.

Technical Parameters

Model	BBR-4V626	BBR-4V966
Capacity	626L	966L
Temp. Range	4±2℃	
Temp. Accuracy	0.1℃	
Control System	Microprocessor control	
Display	LED display	
Alarm	Audio and visual alarm for: High or low temperature, Sensor & system failure; Door ajar, Power failure, Low battery	
Refrigeration Type	Forced air refrigeration system	
Refrigerant	R134a, CFC-Free	
Defrost	Frostless Design	
Construction	Unibody Design, Mono-assembly foaming (Rigid polyurethane insulation material)	
Material	Internal Material	Stainless steel
	External Material	Cold-rolled steel with anti-bacteria powder coating
Door	Electric heated glass semi-foamed door with lock, Heating film preventing frosting, Sealing joint strip with magnetic force. Transparent plastic inner door*6	
Shelves	6*2, Adjustable shelves	
Casters	4 casters	
Consumption	550W	560W
Power Supply	AC110V/220V±10%, 50/60Hz	
Blood Bags (450ml)	10*36=360 pcs	16*36=576 pcs
Standard Accessory	Temperature printer, 12 shelves, 36 baskets, LED lamp, probe access port, door key	
Optional Accessory	Temperature recorder	
External Size (W*D*H) mm	1220*665*1885	1220*895*1885
Package Size (W*D*H) mm	1340*750*2100	1340*980*2100
Gross Weight	250kg	286kg

Laboratory Refrigerator(2-8°C)

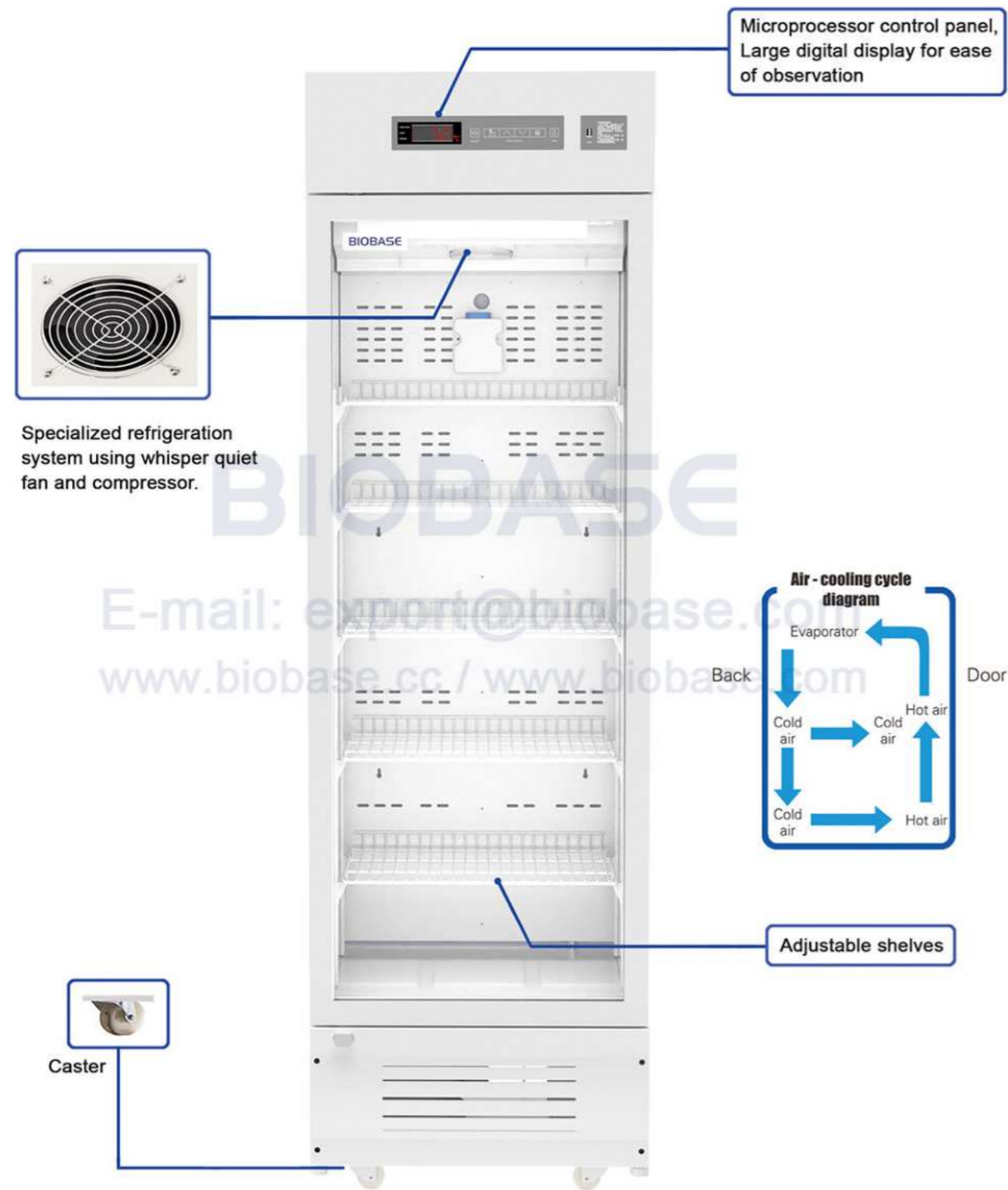

Laboratory Refrigerator(2-8°C)

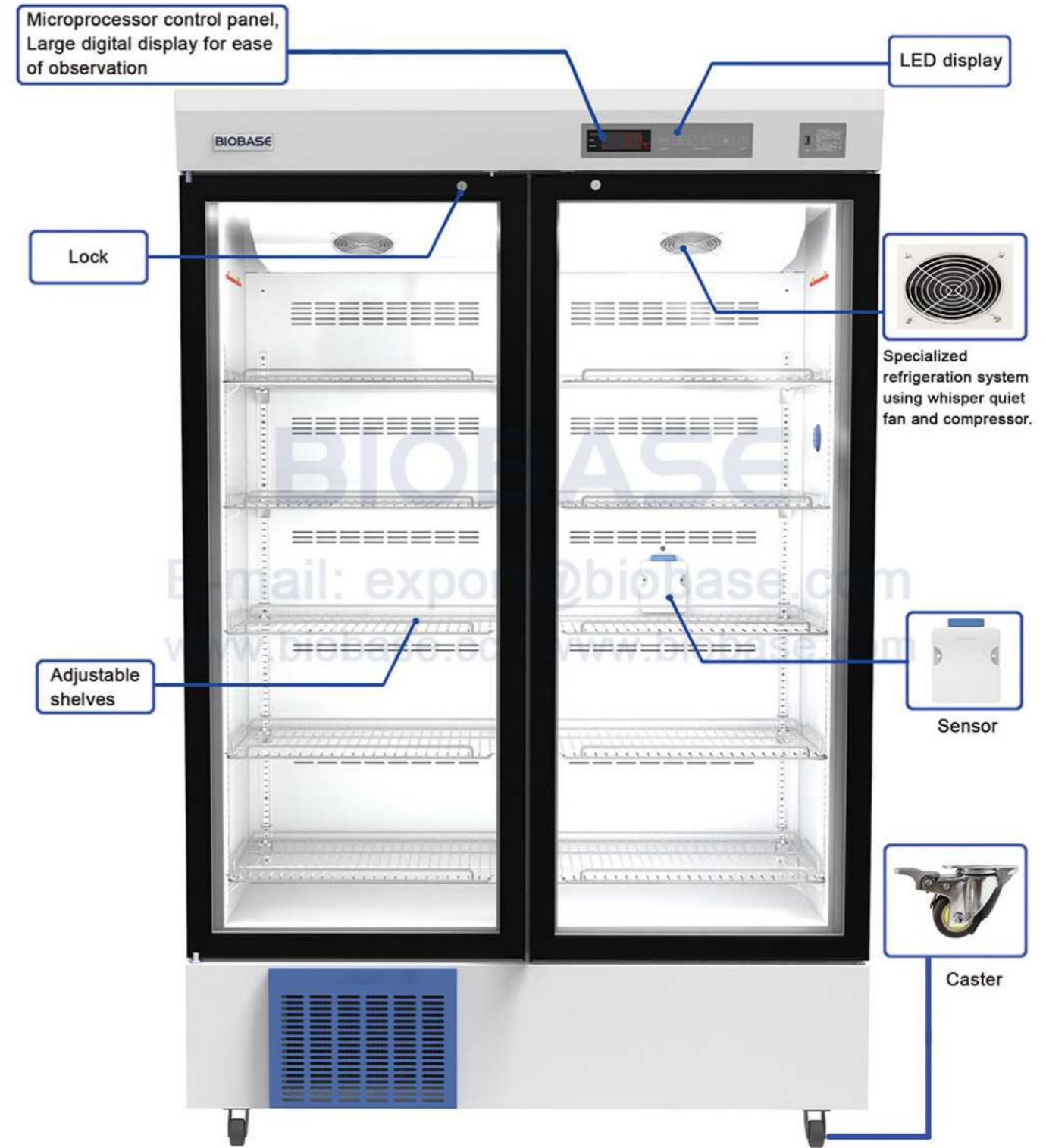

Laboratory Refrigerator



BPR-5V68F/108F



BPR-5V288F/358F/468F

Technical Parameters

Model	BPR-5V68F	BPR-5V108F	BPR-5V288F	BPR-5V358F	BPR-5V468F
Type (shelf/drawer)	2 pcs shelves	3 pcs shelves	4 pcs shelves, S.S.	5 pcs shelves, S.S.	5 pcs shelves, S.S.
Refrigeration Mode	Air-cooled				
Defrosting Mode	Frost-free				
Refrigerant/g	R600a, 21g	R600a, 27g	R290, 55g	R290, 75g	R290, 97g
Noise	55dB(A)				
Ambient Temp.	10~32°C				
Temp. Range	5±3°C				
Temp. Accuracy	0.1°C				
Evaporator	Plate and tube type; copper tube and aluminum fin				
Condenser	Bundy tube		Copper tube and aluminum fin		
Sensor	NTC				
Thermostat	Electronic thermostat				
Door	Foamed cyclopentane				
Display	LCD				
Interface	USB				
Power Supply	110~220V/50~60Hz				
Power	85W	95W	220W	260W	380W
Current	0.7A		1A		
Internal Material	Spray steel plate				
External Material	Spray steel plate				
Lagging	Foamed polyurethane cyclopentane				
Volume	68L	108L	288L	358L	468L
Standard Accessories	High and low temperature alarm, Power fault alarm, Thermostat fault alarm, Door switch alarm, LED lamp, USB port				
Optional Accessories	Printer, 485 port				
Net Weight	38kg	49kg	101kg	111kg	123kg
Gross Weight	49kg	61kg	116kg	126kg	138kg
Internal Size(W*D*H)	415*405*455mm	415*405*706mm	530*520*1096mm	530*520*1325mm	580*613*1325mm
External Size(W*D*H)	495*548*683mm	495*548*934mm	630*653*1658mm	630*653*1886mm	680*747*1886mm
Package Size(W*D*H)	560*668*858mm	560*668*1109mm	730*780*1813mm	730*780*2038mm	780*880*2048mm

Laboratory Refrigerator



Technical Parameters

Model	BPR-5V628F	BPR-5V1008F
Volume	628L	1008L
Type (shelf/drawer)	5 layers, 10 pcs shelves, S.S.	
Refrigeration Mode	Air-cooled	
Defrosting Mode	Automatic	
Refrigerant/g	R290, 150g	
Noise	60dB(A)	
Ambient Temp.	10~32°C	
Temp. Range	5±3°C	
Temp. Accuracy	0.1°C	
Humidity Accuracy	5°C	
Evaporator	Copper tube and aluminum fin	
Condenser	Bundy tube	Copper tube and aluminum fin
Sensor	NTC	
Thermostat	Electronic thermostat	
Door	Foamed cyclopentane	
Display	LED	
Interface	USB (Optional 485 port)	
Power Supply	110~220V/50~60Hz	
Power	537W	
Current	1.4A	
Internal Material	Sprayed steel plate	
External Material	Sprayed steel plate	
Lagging	Foamed polyurethane cyclopentane	
Standard Accessories	High and low temperature alarm, Power fault alarm, Thermostat fault alarm, Door open alarm	
Net Weight	181kg	204kg
Gross Weight	227kg	254kg
Internal Size(W*D*H)	1100*454*1305mm	1100*684*1360mm
External Size(W*D*H)	1220*598*1886mm	1220*828*1886mm
Package Size(W*D*H)	1340*750*2100mm	1340*980*2100mm

Laboratory Refrigerator



118L

238L

298L

E-mail: export@biobase.com



468L

628L/968L

Technical Parameters

Model	BPR-5V118	BPR-5V238	BPR-5V298	BPR-5V468	BPR-5V628	BPR-5V968
External Size(W*D*H) mm	500*550*1300	580*575*1810	620*575*1980	680*747*1885	1220*630*1885	1220*860*1885
Capacity	118L	238L	298L	468L	628L	968L
Temp. Range	2℃~8℃					
Temp. Accuracy	0.1℃					
Control System	Microprocessor Control, Large Screen LED Display					
Alarm	Audible and visual alarm for: High and low temperature, Power failure alarm, Door ajar, Thermostat failure					
Refrigeration Type	Forced air refrigeration system					
Refrigerant	R600a, CFC Free		R290a, 97g		R134a, 175g	
Condenser & Evaporator	Bundy tube condenser					
Defrost	Auto defrost					
Construction	Structure	Unibody Design & Mono-assembly foaming (Rigid polyurethane insulation material)			Unibody Design & Mono-assembly foaming (Polyurethane cyclopentane insulation material)	
	Internal Material	Embossed aluminum sheet			Spraying steel plate	
	External Material	Spraying steel plate				
Shelves	4 pcs	4pcs	5 pcs	5 pcs	10 pcs	
Door	Glass door with electric heating					
Consumption	162W	162W	189W	380W	537W	
Power Supply	AC220V±10%, 50/60Hz(only for BPR-5V118) ,AC110/220V±10%, 50/60Hz					
Standard Accessories	LED Lamp,USB port, probe access port(BPR-5V628 & BPR-5V968)					
Optional Accessory	Temperature recorder, Temperature printer(USB port can not be selected at the same time), probe access port					
Package Size(W*D*H) mm	610*620*1510	670*650*2000	720*660*2160	830*880*2050	1340*750*2100	1340*980*2100
Gross Weight	57kg	80kg	88kg	158kg	223kg	256kg

Laboratory Refrigerator



BPR-5V68



BPR-5V108



BPR-5V650



BPR-5V368



BPR-5V1000

Technical Parameters

Model	BPR-5V68	BPR-5V108	BPR-5V368	BPR-5V650	BPR-5V1000
Type (Shelf/Drawer)	2 pcs shelves	3 pcs shelves	5 pcs shelves	5 layers, 10 pcs shelves	
Refrigeration Mode	Air-cooled				
Defrosting Mode	Automatic				
Refrigeration/g	R600a, CFC free, 21g	R600a, CFC free, 27g	R134a, CFC free, 120g	R134a, CFC free, 175g	
Noise	55dB(A)			60dB(A)	
Ambient Temp.	10~32°C				
Temp. Range	5±3°C				
Temp. Accuracy	0.1°C				
Evaporator	Copper tube and aluminum fin				
Condenser	Bundy tube				
Sensor	NTC				
Thermostat Control	Microprogram control				
Door	Electric-heating glass door, no condensation				
Display	LED				
Interface	USB				
Power Supply	220V, 50/60Hz; 110V, 60Hz				
Consumption	92W		230W	537W	
Internal Material	Sprayed steel plate		Rolled aluminum board	Sprayed steel plate	
External Material	Spray steel plate				
Lagging	Foamed polyurethane cyclopentane				
Capacity	68L	108L	368L	650L	1000L
Standard Accessories	High and low temperature alarm, Power fault alarm, Thermostat fault alarm, Door ajar alarm				
Optional Accessories	Temperature recorder, Printer (USB port cannot be selected at the same time, except BPR-5V68)				
Gross Weight	49kg	60kg	90kg	235kg	262kg
Internal Size(W*D*H)	415*405*455mm	415*405*706mm	566*475*1290mm	1100*454*1339mm	1100*684*1351mm
External Size(W*D*H)	495*548*683mm	495*548*934mm	650*600*2010mm	1220*630*1885mm	1220*860*1885mm
Package Size(W*D*H)	620*700*860mm	630*700*1110mm	740*692*2230mm	1340*750*2100mm	1340*980*2100mm

Laboratory Refrigerator



Technical Parameters

Model	BPR-5V1500	
External Size(W*D*H) mm	1800*775*1965	
Capacity	1500L	
Temp. Range	2~8℃	
Temp. Accuracy	0.1℃	
Control System	Microprocessor Control & Large Screen LED Display	
Alarm	Senor fault, door Ajar	
Refrigeration Type	Forced air refrigeration system	
Refrigerant	R134a, CFC Free	
Condenser&Evaporator	High efficiency air-cooled condenser, made of copper	
Defrost	Frostless design	
Construction	Structure	Unibody design & Mono-assembly foaming (rigid polyurethane insulation material)
	Internal Material	Stainless steel
	External Material	Stainless steel
Shelves	Adjustable shelves made of high quality steel wire 12 pcs	
Consumption	1040W	
Power Supply	AC110/220V±10%, 50/60Hz	
Standard Accessory	LED lamp, Shelves, Door keys, Testing hole (only for BPR-5V650), Battery	
Package Size(W*D*H) mm	1880*820*2150	
Gross Weight	319kg	

-25℃ Freezer (Separate Refrigerator)



BRF-25V300



BRF-25V318



BRF-25V368

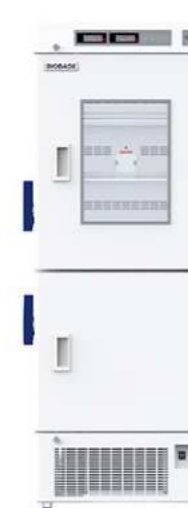

BRF-25V450

Technical Parameters

Model	BRF-25V300	BRF-25V318	BRF-25V368	BRF-25V450
External Size(W*D*H) mm	595*600*1700	741*631*1889	750*736*1884	741*881*1889
Capacity	Refrigerator:174L Freezer:126L	Refrigerator:208L Freezer:110L	Refrigerator:183L Freezer:185L	Refrigerator: 295L, internal size 590*675*746mm Freezer:155L, internal size 520*647*460mm
Temp. Range	Refrigerator: 2℃~8℃; Freezer: -10℃~-25℃			
Temp. Accuracy	0.1℃			
Control System	Microprocessor control			
Alarm	High or low temperature alarm, open the door alarm; Thermostat failure, power failure alarm			
Cooling Method	Refrigerator: Air cooling Freezer: Direct cooling	Refrigerator: Air cooling Freezer: Direct cooling	Refrigerator: Air refrigeration Freezer: Direct cooling	Refrigerator: Air refrigeration Freezer: Direct cooling
Refrigerant	R600a	R290/39g R290/55g	R290/25g R290/40g	Refrigerator: R290/50g Freezer: R290/57g
Condenser	Bundy tube	Bundy tube	Wire tube condenser	
Construction	Structure	Unibody design and thickened environmental protection foam insulation layer		
	Internal Material	HIPS	304 stainless steel	
	External Material	Pre-coated galvanized plate	Sprayed steel plate	Steel plate with powder
Shelf / Drawer	Refrigerator: 2 shelves Freezer: 3 shelves		Refrigerator:2 shelves Freezer:2 shelves	Refrigerator: 3 shelves Freezer: 1 shelve
Consumption	160W	390W	594W	410W
Power Supply	Standard:220V 50Hz, optional:110V 60Hz			
Package Size(W*D*H) mm	630*645*1740mm	880*770*2090	890*880*2100	880*950*2090
Gross Weight	75kg	175kg	195kg	197kg

-25°C Freezer



Technical Parameters

Model	BDF-25V270	BDF-25V350
External Size(W*D*H) mm	690*744*1631	690*744*1885
Capacity	270L	350L
Type	Vertical	
Temp. Range	-10°C~-25°C	
Temp. Accuracy	0.1°C	
Control System	Microprocessor Control & LED Display	
Alarm	High or low temperature alarm, power outage alarm, Thermostat alarm, Door switch alarm, battery switch alarm	
Refrigeration Type	Direct Refrigeration	
Refrigerant	R290, CFC free	
Compressor	International famous compressor	
Condenser & Evaporator	Wire tube condenser; Coil type evaporator	
Construction	Structure	Unibody Design & Mono-assembly foaming (Rigid polyurethane insulation material)
	Internal Material	SUS304
	External Material	Cold-rolled steel coated with bacterial powder
Shelve	3pcs	4pcs
Consumption	290W	305W
Power Supply	220V±10%, 50Hz; 110V±10%, 60Hz (Optional)	
Package Size(W*D*H) mm	810*860*1820	810*860*2100
Gross Weight	145kg	165kg

-25°C Freezer



Technical Parameters

Model	BDF-25V100	BDF-25V936
External Size(W*D*H) mm	600*620*870	1304*1000*2017
Internal Size(W*D*H) mm	410*440*630	1000*700*1335
Capacity	100L	936L
Type	Vertical	
Temp. Range	-10°C~-25°C	
Temp. Accuracy	0.1°C	
Control System	Microprocessor control, LED Digital Display	
Audible and Visual Alarm	High and low temperature alarm, sensor failure alarm, door open alarm, etc.	High and low temperature alarm, sensor failure alarm, thermostat failure alarm, power failure alarm, door open alarm, ambient temperature alarm, condenser failure alarm, filter inspection alarm, abnormal voltage alarm, low battery alarm.
Alarm Method	Sound beeps and lights flash	
Refrigeration type	Direct refrigeration	
Refrigerant	R600A	R404A
Construction	Foam Layer Thickness	75mm
	Internal Material	HIPS
	External Material	Sprayed steel plate
Consumption	100W	1000W
Power Supply	Standard: AC220V, 50Hz; Optional: AC220V, 60Hz; 110V, 60Hz	AC110V/220V±10%, 50/60Hz
Package Size (W*D*H) mm	630*645*905mm	1360*1135*2170
Gross Weight	40kg	421kg

-25°C Freezer



BDF-25H305

Technical Parameters

Model	BDF-25H305	
External Size(W*D*H) mm	1148*740*872	
Capacity	305L	
Temp. Range	-10°C~-25°C	
Temp. Accuracy	0.1°C	
Control System	Microprocessor control&LED display	
Alarm	High or low temperature alarm, sensor failure alarm, thermostat alarm, power failure alarm	
Refrigeration Type	Direct refrigeration	
Refrigerant	R134a	
Condenser&Evaporator	Internal-mounted condenser and finned evaporator	
Construction	Structure	Whole foaming, freon cyclopentane/isopentane high density polyurethane foam
	Internal Material	Spraying steel plate
	External Material	Spraying steel plate
Basket	none	
Consumption	106W	
Power Supply	AC220V±10%,50/60Hz; AC110V±10%,60Hz	
Package Size(W*D*H)mm	1223*777*1005	
Gross Weight	87kg	

-25°C Freezer



BDF-25V368D



BDF-25V528D

Technical Parameters

Model	BDF-25V368D	BDF-25V528D
External Size(mm)	750*736*1884	890*810*1884mm
Internal Size(mm)	Up:580*575*563; Down: 580*575*563	Up:720*649*563; Down: 720*649*563
Capacity	368L	528L
Type	Vertical	
Temp. Range	-10°C~-25°C	
Temp. Accuracy	0.1°C	
Control System	Electronic temperature control	
Alarm	Power failure alarm, door ajar alarm, high or low temperature alarm, thermostat failure, battery switch alarm	
Cooling Method	Direct cooling	
Refrigerant	R290	
Condenser	Bundy tube	
Construction	Structure	Unibody design and thickened environmental protection foam insulation layer
	Internal Material	304 stainless steel
	External Material	Pre-coated galvanized plate
Shelf	4pcs	
Consumption	718W	820W
Power Supply	Standard: AC220V±10% 50Hz; optional: AC110V±10% 60Hz	
Package Size(W*D*H) mm	890*880*2100	1030*950*2100
Gross Weight	195kg	220kg

-25°C Freezer



Technical Parameters

Model	BDF-25H110	BDF-25H210	BDF-25H310
External Size	705*705*885mm	945*785*885mm	1225*790*885mm
Capacity	110L	210L	310L
Temperature Range	-10°C~-25°C		
Temperature Accuracy	0.1°C		
Control System	Microprocessor Control		
Alarm	High or low temperature alarm, Sensor failure, Power failure, Battery switch alarm		
Refrigeration Type	Direct refrigeration		
Refrigerant	R290, 50g	R290, 45g	R290, 65g
Evaporator	Material of copper		
Construction	Structure	Unibody Design, Rigid polyurethane insulation material	
	Internal Material	304 Stainless steel	
	External Material	Powder coated cold rolled steel plate	
Consumption	270w	260w	345w
Power Supply	Standard: 220V 50Hz, optional: 220V 60Hz, 110V 60Hz		
Packing Size	805*800*1015mm	1045*880*1015mm	1325*885*1015mm
Gross Weight	73kg	88kg	101kg

-30°C Freezer



Technical Parameters

Model	BDF-30V368D	BDF-30V528D
External Size(mm)	750*736*1884	890*810*1884mm
Internal Size(mm)	Up:580*575*563; Down: 580*575*563	Up:720*649*563; Down: 720*649*563
Capacity	368L	528L
Type	Vertical	
Temp. Range	-10°C~-30°C	
Temp. Accuracy	0.1°C	
Control System	Electronic temperature control	
Alarm	Power failure alarm, door ajar alarm, high or low temperature alarm, thermostat failure, battery switch alarm	
Cooling Method	Direct cooling	
Refrigerant	R290	
Condenser	Bundy tube	
Construction	Structure	Unibody design and thickened environmental protection foam insulation layer
	Internal Material	304 stainless steel
	External Material	Pre-coated galvanized plate
Shelf	4pcs	
Consumption	718W	821W
Power Supply	Standard: AC220V±10% 50Hz; optional: AC110V±10% 60Hz	
Package Size(W*D*H) mm	890*880*2100	1030*950*2100
Gross Weight	195kg	220kg

-40°C Freezer



Technical Parameters

Model	BDF-40H110	BDF-40H210	BDF-40H310
External Size	705*705*885mm	945*785*885mm	1225*790*885mm
Capacity	110L	210L	308L
Temperature Range	-15°C~-40°C		
Temperature Accuracy	0.1°C		
Control System	Microprocessor Control		
Alarm	High or low temperature alarm, Sensor failure, Power failure, Battery switch alarm		
Refrigeration Type	Direct refrigeration		
Refrigerant	R290, 55g	R290, 60g	R290, 65g
Evaporator	Material of copper		
Construction	Structure	Unibody Design, Rigid polyurethane insulation material	
	Internal Material	304 Stainless steel	
	External Material	Powder coated cold rolled steel plate	
Consumption	270w	280w	290w
Power Supply	Standard: 220V 50Hz, optional: 220V 60Hz, 110V 60Hz		
Packing Size	805*800*1015mm	1045*880*1015mm	1325*885*1015mm
Gross Weight	73kg	88kg	101kg

-40°C Freezer



Technical Parameters

Model	BDF-40V90	BDF-40V268
External Size(W*D*H)	600*610*945mm	690*744*1631mm
Internal Size(W*D*H)	440*447*640mm	520*567*1013mm
Capacity	90L	268L
Type	Vertical	
Temp. Range	-15°C~-40°C	
Temp. Accuracy	0.1°C	
Control System	Microprocessor Control; LED Display	
Alarm	BDF-40V90: High or low temperature alarm,sensor failure alarm,power failure alarm,door open alarm.	High or low temperature alarm, door ajar alarm, power failure alarm, sensor failure alarm.
Refrigeration Type	Direct Refrigeration	
Refrigerant	R290	R290
Compressor	Unicompressor,imported famous brand compressor	International well-known brand
Construction	Structure	Uniboday design
	Internal Material	304 stainless steel
	External Material	Sprayed steel plate
Drawer/Shelf	2 pcs shelves	3pcs shelves,Stainless Steel
Consumption	252W	335W
Power Supply	AC220V±10%, 50/60HZ	AC220V±10%, 50Hz; 110V±10%, 60Hz (Optional)
Package Size	730*730*1140mm	810*860*1820mm
Gross Weight	82kg	145kg

-40°C Freezer



Technical Parameters

Model	BDF-40V362	BDF-40V450	BDF-40V398
External Size(W*D*H)	690*744*1885mm	750*905*1885mm	890*900*1780mm
Internal Size(W*D*H)	520*567*1266mm	522*683*1266mm	610*615*1120mm
Capacity	362L	450L	408L
Type	Vertical		
Temp. Range	-15°C~-40°C		-10°C~-40°C
Temp. Accuracy	0.1°C		
Control System	Microprocessor Control; LED Display		
Alarm	High or low temperature alarm, door ajar alarm, power failure alarm, sensor failure alarm, battery switch alarm		High or low temperature alarm, sensor failure alarm
Refrigeration Type	Direct cooling		Direct Refrigeration
Refrigerant	R290		CFC free
Compressor	Well-known brand		International well-known brand
Construction	Structure	Uniboday design	Uniboday design
	Internal Material	Spraying steel plate	Stainless steel
	External Material	Painted steel panel	Painted steel panel, 150mm foaming insulation
Shelf	4pcs	4pcs	3pcs shelves, Stainless Steel
Consumption	360W	500W	420W
Power Supply	AC220V±10%, 50Hz; 110V±10%, 60Hz	Standard: 220V 50Hz, optional: 220V 60Hz, 110V 60Hz	AC220V±10%, 50/60Hz; 110V±10%, 60Hz
Package Size	810*860*2100mm	855*1000*2080mm	980*1000*1950mm
Gross Weight	165kg	180kg	215kg

-40°C Freezer



Technical Parameters

Model	BDF-40V58	BRF-40V368	BRF-40V318	BRF-40V450
External Size(W*D*H)	540*620*1115mm	750*736*1884mm	741*631*1889mm	741*811*1889mm
Internal Size(W*D*H)	361*405*406mm	Upper:580*563*563mm Down:580*567*563mm	Refrigerator:590*495*746 Freezer:520*467*460	Refrigerator:590*675*746 Freezer:520*647*460
Capacity	58L	Upper:183L; Down:185L	318L (Refrigerator 208L, Freezer 110L)	450L (Refrigerator 295L, Freezer 155L)
Type	Vertical			
Temp. Range	-15°C~-40°C	Refrigerator: 2°C~8°C Freezer: -10°C~-40°C		
Temp. Accuracy	0.1°C			
Control System	Microprocessor Control			
Alarm	BDF-40V58: High or low temperature alarm, sensor failure alarm; BRF-40V368: High or low temperature alarm, sensor failure alarm, power failure alarm, door open alarm. BRF-40V318/BRF-40V450: Power failure alarm, door ajar alarm, high or low temperature alarm, thermostat failure alarm			
Refrigeration Type	Direct Refrigeration			
Refrigerant	R404a and R23	R290		
Compressor	Unicompressor, imported famous brand compressor			
Material	Structure	Uniboday design		
	Internal	304 stainless steel		
	External	Sprayed steel plate		
Shelf	1 pc shelf	Upper:2 pcs shelves Down:2 pcs shelves	Refrigerator: 3pcs Freezer: 1pc	
Consumption	340W	627W	460W	570W
Power Supply	AC220V±10%, 50HZ ; AC110V±10%, 60HZ			
Package Size	610*690*1275mm	890*880*2100mm	880*950*2090	880*950*2090
Gross Weight	98kg	195kg	178kg	200kg

-40°C Freezer



BDF-40V608

BDF-40V708

BDF-40V808

BDF-40V936

Technical Parameters

Model	BDF-40V608	BDF-40V708	BDF-40V808	BDF-40V936
External Size(W*D*H) mm	940*980*1920	1090*1000*1920	1090*1010*2025	1304*1000*2017
Internal Size(W*D*H) mm	700*680*1255	850*680*1255	850*735*1335	1000*700*1335
Capacity	598L	708L	808L	936L
Type	Vertical			
Temp. Range	-15°C~-40°C		-25°C~-40°C	
Temp. Accuracy	0.1°C			
Control System	Microprocessor control, LED Digital Display			
Audible and Visual Alarm	High and low temperature alarm, sensor failure alarm. (BDF-40V608, BDF-40V708, BDF-40V808)			
	High and low temperature alarm, sensor failure alarm, thermostat failure alarm, power failure alarm, door open alarm, ambient temperature alarm, condenser failure alarm, filter inspection alarm, abnormal voltage alarm, low battery alarm. (BDF-40V936)			
Alarm Method	Sound beeps and lights flash			
Refrigeration Type	Direct refrigeration			
Refrigerant	R404A and R23		R404A	
Construction	Foam Layer Thickness	120mm		150mm
	Internal Material	304 stainless steel		
	External Material	Sprayed steel plate		
Consumption	1000W			
Power Supply	AC110V/220V±10%, 50/60Hz			
Package Size (W*D*H) mm	1025*1050*2090	1220*1080*2070	1175*1075*2180	1360*1135*2170
Gross Weight	315kg	350kg	365kg	416kg

-40°C Freezer



BDF-40V368D

BDF-40V528D

Technical Parameters

Model	BDF-40V368D	BDF-40V528D
External Size(mm)	750*736*1884	890*810*1884mm
Internal Size(mm)	Up:580*575*563; Down: 580*575*563	
Capacity	368L	528L
Type	Vertical	
Temp. Range	-10°C~-40°C	
Temp. Accuracy	0.1°C	
Control System	Electronic temperature control	
Alarm	Power failure alarm, door ajar alarm, high or low temperature alarm, thermostat failure, battery switch alarm	
Cooling Method	Direct cooling	
Refrigerant	R290	
Condenser	Bundy tube	
Construction	Structure	Unibody design and thickened environmental protection foam insulation layer
	Internal Material	304 stainless steel
	External Material	Pre-coated galvanized plate
Shelf	4pcs	
Consumption	869W	909W
Power Supply	Standard: AC220V±10% 50Hz; optional: AC110V±10% 60Hz	
Package Size(W*D*H) mm	890*880*2100	1030*950*2100
Gross Weight	195kg	220kg

-40°C Freezer



Technical Parameters

Model	BDF-40H105	BDF-40H205	BDF-40H305	BDF-40H485
External Size(L*W*H) mm	680*580*935	1160*765*885	1530*765*885	1655*755*915
Capacity	105L	220L	320L	485L
Temperature Range	-10°C~-40°C	-15°C~-40°C		-20°C~-40°C
Temperature Accuracy	0.1°C			
Control System	Microprocessor Control, LED Display			
Alarm	BDF-40H100&BDF-40H485: High or low temperature alarm, sensor failure alarm, Power failure alarm, Temperature controller failure alarm BDF-40H200&BDF-40H300: High temperature alarm, sensor failure alarm			
Refrigeration Type	Direct Refrigeration			
Refrigerant	R290	R404a and R23		R290
Evaporator	Material of Copper			
Construction	Structure	Unibody Design & Mono-assembly foaming (Rigid polyurethane insulation material)		
	Internal material	304 Stainless Steel		
	External material	Powder coated cold rolled steel plate		
Consumption	160W	380W	460W	295W
Power Supply	AC220V±10%, 50/60Hz; 110V±10%, 60Hz			
Package Size(L*W*H) mm	750*700*1040	1230*835*1055	1600*835*1055	1775*900*1060
Gross Weight	65kg	143kg	170kg	138kg

-60°C Freezer



Technical Parameters

Model	BDF-60V30	BDF-60V608	BDF-60V708	BDF-60V808	BDF-60V938
External Size(W*D*H) mm	470*490*1120	940*980*1920	1090*1000*1920	1090*1010*2025	1240*1000*2000
Internal Size(W*D*H) mm	270*265*400	700*680*1255	850*680*1255	850*735*1335	1000*700*1335
Capacity	30L	598L	708L	808L	938L
Type	Vertical				
Temp. Range	-25°C~-60°C				
Temp. Accuracy	0.1°C				
Control System	Microprocessor control, LED Digital Display				
Audible and Visual Alarm	High and low temperature alarm, sensor failure alarm.				
Alarm Method	Sound beeps and lights flash				
Refrigeration Type	Direct refrigeration				
Refrigerant	R404A and R23				
Construction	Foam Layer Thickness	100mm	120mm		
	Internal Material	304 stainless steel			
	External Material	Sprayed steel plate			
Consumption	400W	1100W	1100W	1150W	1150W
Power Supply	AC110V/220V±10%, 50/60Hz				
Package Size(W*D*H) mm	540*560*1285	1025*1050*2090	1220*1080*2070	1175*1075*2180	1325*1070*2170
Gross Weight	85kg	315kg	350kg	365kg	405kg

-60°C Freezer



58L

108L

158L

408L

Technical Parameters

Model	BDF-60V58	BDF-60V108	BDF-60V158	BDF-60V398
External Size(W*D*H)mm	540*620*1115	700*730*1260	700*700*1580	850*960*1860
Internal Size(W*D*H)mm	361*405*406	460*460*510	460*455*800	610*660*1200
Capacity	58L	108L	158L	408L
Temp.Range	-25°C ~ -60°C, adjustable			
Temp.Accuracy	0.1°C			
Control System & Display	Microprocessor control, LED display			
Audio & Visual Alarm	High or low temperature alarm ;Sensor failure alarm			
Refrigeration Type	Optimized auto-cascade refrigerating system			
Refrigerant	Unique fluoride-free mixed refrigerant, CFC-Free			
Condenser & Evaporator	Optimized evaporation and condensation system, strong cooling and low energy consumption			
Construction	Structure	90mm ultra-thick foam layer	120mm ultra-thick foam layer	150mm ultra-thick foam layer
	Internal Material	304 stainless steel		
	External Material	Sprayed steel plate		
Consumption	450W	480W	500W	550W
Power Supply	AC110V/220V±10%,50/60Hz			
Package Size(W*D*H)mm	610*690*1275	785*800*1430	785*770*1750	935*1030*2030
Gross Weight	101kg	133kg	150kg	250kg

-60°C Freezer



60L

118L / 220L / 320L

458L

Safety system

1. Perfect alarm system with buzzer sound and lamp flashing alarm functions
2. High temperature alarm & Temperature sensor failure alarm
3. Multiple-protection function (Password protection, power-on delay, time between stops, refrigeration system operation protection during sensor failure)

Technical Parameters

Model	BDF-60H58	BDF-60H118A	BDF-60H218	BDF-60H318	BDF-60H458
External Size(W*D*H) mm	670*765*905	900*765*945	1160*765*885	1530*765*885	2115*895*1095
Internal Size(W*D*H) mm	470*470*300	696*470*385	960*470*595	1330*470*595	1380*500*660
Capacity	60L	118L	220L	320L	458L
Temp. Range	-25°C~-60°C, adjustable				
Temp. Accuracy	0.1°C				
Control System & Display	Microprocessor control, LED display				
Audio & Visual Alarm	High or low temperature alarm;Sensor failure alarm				
Refrigeration Type	Optimized auto-cascade refrigerating system				
Refrigerant	Unique fluoride-free mixed refrigerant, CFC-Free				
Condenser & Evaporator	Optimized evaporation and condensation system, strong cooling and low energy consumption				
Construction	structure	100mm(150mm only for BDF-60H458) ultra-thick foam layer, dual-sealing design of door, for effective temperature protection			
	Internal Material	304 stainless steel			
	External Material	Sprayed steel plate			
Consumption	330W	340W	400W	480W	520W
Power Supply	AC110V/220V±10%,50/60Hz				
Package Size(W*D*H) mm	740*835*1075	1020*830*1075	1230*835*1055	1600*835*1055	2215*935*1245
Gross Weight	101kg	128kg	143kg	170kg	255kg

-86°C Freezer



Technical Parameters

Model	BDF-86V28	
External Size(W*D*H) mm	505*520*1165	
Internal Size(W*D*H) mm	266*261*400	
Capacity	28L	
Type	Vertical	
Temp. Range	-40°C~86°C	
Temp. Accuracy	0.1°C	
Control System	Microprocessor control, LED Digital Display	
Audible and Visual Alarm	High and low temperature alarm, sensor failure alarm.	
Alarm Method	Sound beeps and lights flash	
Refrigeration Type	Direct refrigeration	
Refrigerant	R404A and R23	
Construction	Foam Layer Thickness	100mm
	Internal Material	304 stainless steel
	External Material	Sprayed steel plate
Chamber with Inner Door	1	
Shelf	1pc	
Test Port	Φ18mm*1	
Consumption	390W	
Power Supply	AC110V/220V±10%, 50/60Hz	
Package Size (W*D*H) mm	580*600*1325	
Gross Weight	85kg	

-86°C Freezer



BDF-86V58



BDF-86V108

Technical Parameters

Model	BDF-86V58	BDF-86V108
External Size(W*D*H) mm	635*757*1212	700*730*1260
Internal Size(W*D*H) mm	330*453*410	460*460*510
Capacity	58L	108L
Type	Vertical	
Temp. Range	-40°C~-86°C	
Temp. Accuracy	0.1°C	
Control System	Microprocessor control, LED Digital Display	
Audible and Visual Alarm	High and low temperature alarm, sensor failure alarm, thermostat failure alarm, power failure alarm, door open alarm, ambient temperature alarm, condenser failure alarm, filter inspection alarm, abnormal voltage alarm, low battery alarm. (BDF-86V58) High and low temperature, sensor failure. (BDF-86V108) High and low temperature alarm, sensor fault alarm, power alarm, open and close abnormal alarm function (BDF-86V168T)	
Alarm Method	Sound beeps and lights flash, remote alarm (BDF-86V168T optional)	
Refrigeration Type	Direct refrigeration	Auto-cascade refrigerating system
Refrigerant	R290 and R170	R404a and R23
Compressor	1 set	
Condenser& Evaporator	Made of copper	
Construction	Foam Layer Thickness	150mm
	Internal Material	304 stainless steel
	External Material	Sprayed steel plate
Door	Lockable door	
Caster	4 casters	
Chamber with Inner Door	1	2
Shelf	1pcs	1pcs
Temp. Test Port	1, Φ25mm	1, Φ18mm
Consumption	442W	520W
Power Supply	AC110V/220V±10%, 50/60Hz	
Package Size (W*D*H) mm	730*845*1400	785*800*1430
Gross Weight	155kg	133kg

-86°C Freezer



BDF-86V50

BDF-86V158

BDF-86V348

Technical Parameters

Model	BDF-86V50	BDF-86V158	BDF-86V348
Capacity	50L	158L	348L
Shelf	2 pcs, S.S.		3 pcs, S.S.
Refrigeration Type	Direct refrigeration		
Defrosting Type	Manual		
Refrigerant/g	Mixed refrigerant, CFC free		
Noise	55dB(A)	53dB(A)	55dB(A)
Ambient Temp.	10~32°C		
Temp. Range	-40°C~-86°C		
Evaporator	Built-in coil, copper pipe		
Condenser	Copper tube and aluminum fin		
Sensor	PT1000	PTC	
Thermostat	Electronic thermostat		
Display	LED		
Power Supply	110~220V/50~60Hz		
Power	540W	650W	650W
Current	2.5A	3.9A	3.9A
Internal Material	S.S. 304		
External Material	Sprayed cold-rolled steel plate		
Lagging	Foamed polyurethane cyclopentane		
Audible and Visual Alarm	High and low temperature alarm, Power fault alarm, Thermostat fault alarm, Door switch alarm		
Net Weight	92kg	196kg	264kg
Gross Weight	134kg	253kg	332kg
Internal Size(W*D*H)	360*456*395mm	465*455*820mm	490*612*1150mm
External Size(W*D*H)	660*715*1165mm	844*807*1594mm	869*989*1924mm
Package Size(W*D*H)	765*825*1350mm	1000*970*1790mm	1020*1180*2130mm

-86°C Freezer



BDF-86V168T

BDF-86V348T

Technical Parameters

Model	BDF-86V168T	BDF-86V348T
External Size(W*D*H) mm	844*807*1594mm	869*989*1924mm
Internal Size(W*D*H) mm	465*455*820mm	490*612*1150mm
Capacity	168L	348L
Type	Vertical	
Temp. Range	-40°C~-86°C	
Temp. Accuracy	0.1°C	
Control System	Microprocessor control, 8 inch touch LCD screen	
Audible and Visual Alarm	High and low temperature alarm, sensor fault alarm, power alarm, open and close abnormal alarm function	
Alarm Method	Sound beeps and lights flash, remote alarm(optional)	
Refrigeration Type	Auto- cascade refrigeration system	Double machine cascade refrigeration system
Refrigerant	R290 and R170	
Compressor	2 sets	
Condenser& Evaporator	Made of copper	
Construction	Foam Layer Thickness	189mm
	Internal Material	304 stainless steel
	External Material	Spray steel plate
Door	Lockable door	
Caster	4 casters	
Chamber with Inner Door	3	2
Shelf	2pcs	3pcs
Temp. Test Port	1, Φ30mm	
Consumption	830W	915W
Power Supply	Standard: 220V 50Hz Optional: 220V 60Hz, 110V, 60Hz	
Package Size (W*D*H) mm	880*840*1700	1020*1180*2130
Gross Weight	253kg	332kg

-86°C Freezer



BDF-86V418T

BDF-86V608T

Technical Parameters

Model	BDF-86V418T	BDF-86V608T
Capacity	418L	608L
Shelf	3 pcs, S.S.	
Refrigeration Type	Direct refrigeration	
Defrosting Type	Manual	
Refrigerant/g	Mixed refrigerant, CFC-free	
Noise	55dB(A)	
Ambient Temp.	10~32°C	
Temp. Range	-40°C~-86°C	
Evaporator	Built-in coil, copper pipe	
Condenser	Copper tube and aluminum fin	
Sensor	PTC	
Thermostat	Electronic thermostat	
Display	LCD	
Power Supply	110/220V, 50/60Hz	
Power	1870VA	
Current	4.86A	5.1A
Internal Material	S.S. 304	
External Material	Sprayed cold-rolled steel	
Lagging	Foamed polyurethane cyclopentane	
Audible and Visual Alarm	High and low temperature alarm, Power fault alarm, Thermostat fault alarm, Door ajar alarm	
Interface	RS485	
Door	Lockable outer door, 3 inner doors	
Temp. Test Port	1, φ30mm	
Net Weight	315kg	360kg
Gross Weight	345kg	390kg
Internal Size(W*D*H)	600*612*1150mm	620*755*1280mm
External Size(W*D*H)	980*988*1945mm	1000*1147*1996mm
Package Size(W*D*H)	1130*1170*2150mm	1150*1280*2210mm

-86°C Freezer



588L

728L

838L

Technical Parameters

Model	BDF-86V588	BDF-86V728	BDF-86V838
External Size(W*D*H) mm	880*1080*2000	1260*890*2010	1175*1075*1990
Internal Size(W*D*H) mm	606*738*1310	963*558*1350	894*718*1310
Capacity	588L	728L	838L
Type	Vertical		
Temp. Range	-40°C~-86°C		
Temp. Accuracy	0.1°C		
Control System	Microprocessor control, LCD touch screen		Microprocessor control, LED Digital Display
Audible and Visual Alarm	High and low temperature, Sensor failure, Door ajar, Power failure, Voltage abnormal, Ambient temperature abnormal, Low voltage, Filter blocking		
Refrigeration type	Direct refrigeration		
Refrigerant	R290 and R170		
Compressor	2 sets		
Condenser&Evaporator	Made of copper		
Construction	Structure	150mm ultra-thick foam layer	100mm ultra-thick foam layer
	Internal Material	SS 304	
	External Material	Sprayed steel plate	
Door	Lockable door		
Caster	4 casters		
Chamber with Inner Door	2		
Shelf	3 pcs		
Temp. Test Port	1, φ25mm	1, φ25mm	1, φ25mm
Consumption	815W	935W	1700W
Power Supply	AC110V/220V±10%, 50/60Hz		
Standard Accessory	72 hours battery backup for power failure alarm, USB port		
Max. Optional Storage Racks	16*LD5*5	24*LD5*4	24*LD5*5
Max. Optional Boxes	400	480	630
Package Size (W*D*H) mm	975*1140*2200	1320*970*2190	1270*1100*2185
Gross Weight	368kg	401.5kg	430kg

-86°C Freezer



BDF-86H50

BDF-86H118

Technical Parameters

Model	BDF-86H50	BDF-86H118
Capacity	50L	118L
Refrigeration Type	Direct refrigeration	
Defrosting Type	Manual	
Refrigerant/g	Mixed refrigerant, CFC free	
Noise	55dB(A)	
Ambient Temp.	10~32°C	
Temp. Range	-40°C~-86°C	
Evaporator	Built-in coil, copper pipe	
Condenser	Copper tube and aluminum fin	
Sensor	PT1000	
Thermostat	Electronic thermostat	
Display	LED	
Power Supply	110~220V/50~60Hz	
Power	295W	536W
Current	2.2A	3.6A
Internal Material	S.S. 304	S.S. 304
External Material	Spray cold-rolled steel plate	
Lagging	Foamed polyurethane cyclopentane	
Audible and Visual Alarm	High and low temperature alarm, Power fault alarm, Thermostat fault alarm, Door switch alarm	
Net Weight	83kg	103kg
Gross Weight	125kg	150kg
Internal Size(W*D*H)	400×400×355mm	540×400×580mm
External Size(W*D*H)	695×740×985mm	1140×730×930mm
Package Size(W*D*H)	810×830×1180mm	1240×800×1065mm

-150°C Freezer



BDF-150H58

BDF-150H128

Technical Parameters:

Model	BDF-150H58	BDF-150H128
External Size(W*D*H) mm	670*765*1040	1560*957*1178
Internal Size(W*D*H) mm	410*410*385	500*450*578
Capacity	58L	128L
Type	Horizontal	
Temp. Range	-100~-145°C	-40~-150°C
Temp. Accuracy	0.1°C	0.1°C
Control System	Microprocessor control, LED Digital Display	Microprocessor control, LCD touch screen
Audible and Visual Alarm	Over temperature alarm	High temperature alarm, low temperature alarm, abnormal power supply alarm, sensor failure alarm, thermostat failure alarm, filter screen inspection alarm, ambient temperature alarm, condenser failure alarm.
Alarm Method	Sound beeps and lights flash	
Refrigeration type	Direct refrigeration	
Refrigerant	Mixed refrigerants	
Compressor	1 set	1 set
Construction	Foam Layer Thickness	130mm
	Internal Material	304 stainless steel
	External Material	Sprayed steel plate
Consumption	1800W	2550W
Power Supply	380V, 50Hz	
Package Size (W*D*H) mm	710*810*1080	1637*970*1383
Gross Weight	115kg	340kg

Freezer Racks



LD4X4



LD5X4



LD5X5



LD7X5



PC Freezer Box

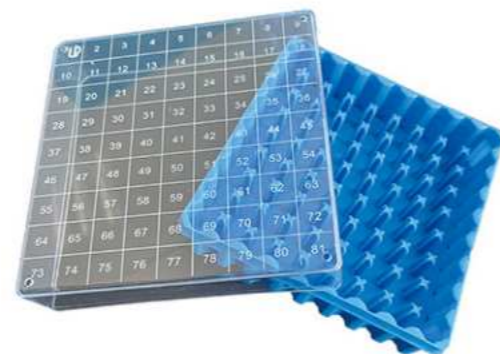

PP Freezer Box

Features

- * Made of corrosion-resistant 304 stainless steel, it can be frozen and thawed repeatedly and stored for a long time.
- * Products can be used for sample storage in ultra-low temperature upright refrigerators.
- * The product can withstand temperature range: -196°C to 121°C.

Freezer Racks Parameters

Model	Specification	Material	Size(L*W*H)	Thickness
LD4X4	4 layers and 4 columns	304 stainless steel	560*140*242mm	1.2mm
LD5X4	5 layers and 4 columns	304 stainless steel	560*140*295mm	1.2mm
LD5X5	5 layers and 5 columns	304 stainless steel	685*140*295mm	1.2mm
LD7X5	7 layers and 5 columns	304 stainless steel	685*140*406mm	1.2mm

Freezer Box Parameters

Material	Specification	Size
PC	81 squares	133*133*52mm
	100 squares	
PP	81 squares	
	100 squares	

Platelet Incubator



BJPX-SP05



BJPX-SP08/SP18



BJPX-SP10



BJPX-SP36

Applications

After thawing, platelets need to be kept swinging in a constant temperature environment of 20°C-24°C while waiting for infusion to patients. The platelet incubator is a device made according to this requirement. When the thawed platelets are placed on the inner chamber storage shelf, the machine can continuously output the continuous left-right reciprocation with the amplitude of 50mm and the frequency of 60rpm, and the horizontal oscillation is achieved, which solves the problem of safe storage of platelets.

Features

- * Microprocessor control system, LCD display
- * UV lamp for disinfection, the interlock for UV lamp and door
- * Power on/off switch, more convenient for operation
- * High efficiency refrigeration system, fast cooling speed and uniformity temperature inside
- * Double-layer glass observation window, filled with gas, to ensure the cooling performance
- * Alarm for high/low temperature, door ajar, etc

Technical Parameters

Model	BJPX-SP05	BJPX-SP08	BJPX-SP10	BJPX-SP18	BJPX-SP36	
Door	Single door				Double door	
Temp Range(°C)	22±2.0					
Resolution(°C)	0.1					
Temp Display Error(°C)	±1.0					
Temp Fluctuation (°C)	±1.0					
Temp Uniformity (°C)	±2.0					
Oscillation Frequency (rpm)	60±5					
Shock Range (mm)	50±5					
Refrigerant	R134a, CFC free					
Operate Mode	Continuous left and right reciprocation, horizontal oscillation					
Layer/Bag (400ml for reference)	5(1-10)	8(1-16)	3(1-12)	18(1-36)	36(1-72)	
Power	Standard:220V 50Hz Optional:110V 60Hz					
Size (mm)	Internal	448*369*448	485*310*569	498*450*578	500*337*970	1018*343*895
	External	700*800*630	632*612*1225	645*730*1225	632*612*1600	1140*612*1600
	Package	824*924*772	740*853*1360	740*853*1360	726*706*1755	1235*706*1755
Weight (kg)	Net weight	70	110	138	120	180
	gross weight	90	130	160	145	215

Freeze Dryer



Introduction

Vacuum freeze-drying technology is also known as sublimation drying. The principle is to freeze a sample containing water in advance, and then sublimate its moisture under vacuum. The original biological, chemical and physical properties of the freeze-dried samples remain basically the same, and they are easy to be stored for a long time. After adding water, the samples can be restored to the state before freeze-drying, and their original biochemical characteristics can be maintained. Therefore, freeze-drying technology is widely used in medicine, food, chemical, biological products and other fields.

Features

- * Compressor, energy saving and high efficiency, low noise, long life.
- * Vacuum pump, small volume, pumping speed, low noise, can achieve higher vacuum.
- * Integrated design, compact structure, easy to use.
- * Environmentally friendly refrigerant, ODP=0.
- * With defrosting function, safe and reliable.
- * The cold trap and operating table are made of stainless steel, corrosion resistant and easy to clean.
- * The transparent cover of the drying chamber is made of aviation acrylic material, with high strength and no bonding.
- * Large cold trap opening size, with pre-freezing function, no need for low temperature refrigerator.
- * Professional gas diversion technology, high freeze-drying efficiency, and uniform ice capture.

Accessories

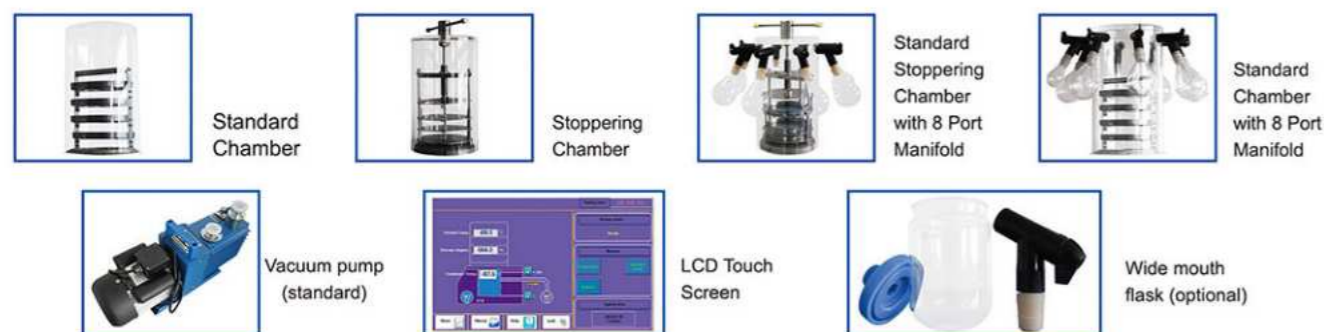

Technical Parameters

Model	BK-FD10S	BK-FD10P	BK-FD10T	BK-FD10PT
Type	Standard chamber	Standard chamber with 8 port manifold	Stopping chamber	Stopping chamber with 8 port manifold
Freeze Drying Area	0.12m ²		0.08m ²	
Tray	4 pcs		3 pcs	
Height Between Trays	50mm		/	
Cold Trap Temperature	≤-60°C (No load) (-80°C optional)			
Cold Trap Capacity	6L			
Cold Trap Size (Diameter*H)	Φ219*140mm			
Vacuum Degree	≤5 Pa			
Water Capture Capacity	3-4L/24h			
Tray Size (D*H)	Φ200*20mm		Φ180*20mm	
Freeze Drying Time	36h			
Loading Capacity/Shelf (Liquid)	1.2L		0.9L	
Total Loading Capacity (Liquid)	2.4L		1.6L	
Drying Chamber Size (Diameter*H)	Φ260*420mm		Φ260*465mm	
Total Qty. Of Vial Φ22	/	/	147	147
Total Qty. Of Vial Φ16	/	/	297	297
Total Qty. Of Vial Φ12	/	/	492	492
Refrigerant	-60°C: R600a, R23 -80°C: R404a, R23			
Cooling System	Standard: Air cooling Optional: Water cooling			
Power Supply	Standard: 220V 50Hz Optional: 220V 60Hz			
Power Consumption	1300W			
Standard Accessory	Vacuum pump 2L/S, Material tray*4 (Material tray*3 for T/PT), Drying rack*1, Cover*1, Acrylic bucket*1 (all models) Conical-mouth flask 100ml*2pcs, 200ml*2pcs, 250ml*2pcs, 500ml*2pcs, Switch valve*8 pcs (only for model BK-FD10P/PT)			
Optional Function & Accessory	Equipment moving frame, vacuum pump of other specifications, vacuum regulation, oil mist filter, automatic air intake, automatic water discharge and other customization (for all models) 600ml/1200ml Wide-mouth flask (for BK-FD10P/PT)			
External Size (W*D*H), mm	640*610*550			
Package Size (W*D*H), mm	Main Body	735*720*760mm		
	Accessory	720*605*560mm		
Gross Weight (kg)	Main Body	-60°C: 80kg		-80°C: 98kg
	Accessory	45kg	49kg	54kg

Vertical Freeze Dryer



BK-FD12S



BK-FD12P



BK-FD12T



BK-FD12PT

Technical Parameters

Model	BK-FD12S	BK-FD12P	BK-FD12T	BK-FD12PT
Type	Standard chamber	Standard chamber with 8 port manifold	Stoppering chamber	Stoppering chamber with 8 port manifold
Freeze Drying Area	0.12m ²		0.08m ²	
Tray	4 pcs		3 pcs	
Height Between Trays	50mm		/	
Cold Trap Temperature	≤-60°C(No load)(-80°C optional)			
Cold Trap Capacity	9L			
Cold Trap Size (Diameter*H)	Φ219*240mm			
Vacuum Degree	≤5 Pa			
Water Capture Capacity	3-4L/24h			
Tray Size (D*H)	Φ200*20mm		Φ180*20mm	
Freeze Drying Time	36h			
Loading Capacity/Shelf (Liquid)	1.2L		0.8L	
Total Loading Capacity (Liquid)	2.4L		1.6L	
Drying Chamber Size (Diameter*H)	Φ260*420mm		Φ260*465mm	
Total Qty. Of Vial Φ22	/	/	147	147
Total Qty. Of Vial Φ16	/	/	297	297
Total Qty. Of Vial Φ12	/	/	492	492
Refrigerant	-60°C: R600a, R23 -80°C: R404a, R23			
Cooling System	Standard: Air cooling Optional: Water cooling			
Power Supply	Standard: 220V 50Hz Optional: 220V 60Hz			
Power Consumption	1400W			
Standard Accessory	Vacuum pump 2L/S, Material tray*4(Material tray*3 for T/PT), Drying rack*1, Cover*1, Acrylic bucket*1(all models) Conical-mouth flask 100ml*2pcs, 200ml*2pcs, 250ml*2pcs, 500ml*2pcs, Switch valve*8 pcs (only for model BK-FD12P/PT)			
Optional Function & Accessory	Equipment moving frame, vacuum pump of other specifications, vacuum regulation, oil mist filter, automatic air intake, automatic water discharge and other customization(for all models) 600ml/1200ml Wide-mouth flask (for BK-FD12P/PT)			
External Size (W*D*H), mm	520*625*865mm			
Package Size (W*D*H),mm	Main Body	665*765*1140mm		
	Accessory	720*605*560mm		
Gross Weight(kg)	-60°C: 95kg			
	-80°C: 114kg			
	45kg	49kg	54kg	56kg



BK-FD18S



BK-FD18P



BK-FD18T



BK-FD18PT

Technical Parameters

Model	BK-FD18S	BK-FD18P	BK-FD18T	BK-FD18PT
Type	Standard chamber	Standard chamber with 8 port manifold	Stoppering chamber	Stoppering chamber with 8 port manifold
Freeze Drying Area	0.18m ²		0.09m ²	
Tray	4 pcs		3 pcs	
Height Between Trays	80mm		/	
Cold Trap Temperature	≤-60°C(No load)(-80°C -110°C optional)			
Cold Trap Capacity	28L			
Cold Trap Size (Diameter*H)	Φ300*410mm			
Vacuum Degree	≤5 Pa			
Water Capture Capacity	6L/24h			
Tray Size (D*H)	Φ240*20mm		Φ200*20mm	
Freeze Drying Time	36h			
Loading Capacity/Shelf (Liquid)	1.8L		0.9L	
Total Loading Capacity (Liquid)	3.6L		1.8L	
Drying Chamber Size (Diameter*H)	Φ300*445mm		Φ300*465mm	
Total Qty. Of Vial Φ22	/	/	183	183
Total Qty. Of Vial Φ16	/	/	345	345
Total Qty. Of Vial Φ12	/	/	615	615
Refrigerant	-60°C: R600a, R23 -80°C: R404a, R23			
Cooling System	Standard: Air cooling Optional: Water cooling			
Power Supply	Standard: 220V 50Hz Optional: 220V 60Hz			
Power Consumption	1800W			
Standard Accessory	Vacuum pump 4L/S, Material tray*4(Material tray*3 for T/PT), Drying rack*1, Cover*1, Acrylic bucket*1(all models) Conical-mouth flask 100ml*2pcs, 200ml*2pcs, 250ml*2pcs, 500ml*2pcs, Switch valve*8 pcs (only for model BK-FD18P/PT)			
Optional Function & Accessory	Equipment moving frame, vacuum pump of other specifications, vacuum regulation, oil mist filter, automatic air intake, automatic water discharge and other customization(for all models) 600ml/1200ml Wide-mouth flask (for BK-FD18P/PT)			
External Size (W*D*H), mm	545*686*938			
Package Size (W*D*H),mm	Main Body	835*680*1230mm		
	Accessory	725*665*705mm		
Gross Weight(kg)	-60°C: 118kg			
	-80°C: 136kg			
	52kg	54kg	60kg	62kg

Pilot Freeze Dryer



BK-FD20S



BK-FD20T



BK-FD30S



BK-FD30T

Technical Parameters

Model	BK-FD20S(Standard)	BK-FD20T(Stoppering)	BK-FD30S(Standard)	BK-FD30T(Stoppering)
Freeze Drying Area	0.3m ²	0.2m ²	0.4m ²	0.3m ²
Shelf Temperature	-50°C~+70°C(no-loading)			
Cold Trap Temperature	<-75°C(no-loading)			
Vacuum Degree	≤5 Pa(no-loading)			
Water Capture Capacity	≥6		≥8	
Cold Trap Volume	14L		/	26L
Cold Trap Size (Diameter*H)	Φ200*460mm		Φ320*520mm	
Drying Chamber Size (W*D*H)	330*325*470mm		340*500*420mm	
Shelf & Tray Size(W*D*H)	Shelf: 400*270*18mm		Shelf: 300*340*18mm	
	Tray: 395*265*25mm		Tray: 295*335*25mm	
Qty. Of Shelf & Tray	Shelf: 3+1, Tray: 3		Shelf: 4+1, Tray: 4	
Sample Loading Capacity (Liquid)	3L	2L	4L	3L
Height Between Trays	70mm	70mm	50mm	70mm
Tray Temperature Difference	±1°C			
Refrigerant	R404A + R23			
Condenser Cooling Mode	Air cooling			
Defrost Mode	Electric defrosting		Natural defrosting (option electric defrosting)	Electric defrosting
Stoppering Mode	/	manual	/	automatic
Total Qty. Of Vial	Φ22mm	/	440	/
	Φ16mm	/	868	/
	Φ12mm	/	1554	/
Vacuum Pump	4L/S(14.4m ³ /h)		6L/S(22m ³ /h)	
Electric Defrosting Consumption	800W	800W	/	1000W
Silicone Oil Heating Rods Consumption	800W	800W	1000W	1000W
Hydraulic Pressure Station Consumption	/	500W	/	1000W
Total Consumption	3KW	3KW	4.5KW	5.5KW
Power Supply	AC220V, 50Hz/60Hz (single phase)			
Main Body Weight	300kg		400kg	
External Size(W*D*H) mm	840*750*1580mm		920*780*1350mm	
Package Size(W*D*H)mm	Main Body	980*860*1720mm/400kg	980*860*1720mm/470kg	1100*980*1570mm/450kg
	Vacuum Pump	950*420*500mm (37kg)		790*340*460mm (57kg)
Gross Weight	950*420*500mm (37kg)		790*300*470mm (52kg)	

Optional: Import vacuum pump, Vacuum pump anti-return valve, Eutectic point tester, Oil mist filtration system, Vacuum adjustment device



BK-FD50S



BK-FD50T



BK-FD100S



BK-FD100T

Technical Parameters

Model	BK-FD50S(Standard)	BK-FD50T(Stoppering)	BK-FD100S(Standard)	BK-FD100T(Stoppering)
Freeze Drying Area	0.7m ²	0.5m ²	1.04m ²	1.15m ²
Shelf Temperature	-50°C~+70°C(no-loading)			
Cold Trap Temperature	<-75°C(no-loading)			
Vacuum Degree	≤5 Pa(no-loading)			
Water Capture Capacity	≥10kg		≥15kg	
Cold Trap Volume	/	70L	/	/
Cold Trap Size (Diameter*H)	/		Φ400*560mm	
Drying Chamber Size (W*D*H)	410*510*590 mm		620*510*580mm	
Shelf & Tray Size(W*D*H)	Shelf: 480*360*18mm		Shelf: 410*410*18mm	
	Tray: 475*355*25mm		Tray: 405*405*25mm	
Qty. Of Shelf & Tray	Shelf: 4+1, Tray: 4		Shelf: 6+1, Tray: 6	
Sample Loading Capacity (Liquid)	7L	5L	10L	11L
Height Between Trays	70mm	70mm	100mm	100mm
Tray Temperature Difference	±1°C			
Refrigerant	R404A + R23			
Condenser Cooling Mode	Air cooling			
Defrost Mode	Natural defrosting (option electric defrosting)	Electric defrosting	Electric defrosting	Electric defrosting
Stoppering Mode	/	automatic	/	automatic
Total Qty. Of Vial	/	1050	/	2460
	/	2058	/	4788
	/	3075	/	8624
	/	3075	/	8624
Vacuum Pump	8L/S(29m ³ /h)		15L/S(54m ³ /h)	
Electric Defrosting Consumption	/	1000W	1500W	
Silicone Oil Heating Rods Consumption	1000W	/	1600W	
Hydraulic Pressure Station Consumption	/	1000W	/	1500W
Total Consumption	5.5KW	6.5KW	6.5KW	7.5KW
Power Supply	AC380V, 50Hz/60Hz (three phase) BK-FD50S:AC220V, 50Hz/60Hz (single phase)			
Main Body Weight	600kg	800kg	700kg	1000kg
External Size(W*D*H) mm	1000*850*1420mm		1490*850*1620mm	
Package Size(W*D*H)mm	1130*980*1620mm/565kg		1320*990*1855mm/900kg	
	790*330*445mm (73kg)		830*370*600mm (88kg)	
Gross Weight	790*330*445mm (73kg)		830*370*600mm (88kg)	

Optional: Import vacuum pump, Vacuum pump anti-return valve, Eutectic point tester, Oil mist filtration system, Vacuum adjustment device

Blood Transport Box



Applications:

There is a cooling and heating system in the working room of the blood transport box, and the fan drives the hot and cold air in the working room, which is evenly distributed around the working room to keep the temperature in the box constant. Putting the thawed blood flat into the working room solves the problem of safe storage of blood in emergency transportation.

Features

- * Small size, light weight, easy to transport.
- * The use adopts microcomputer control, semiconductor refrigeration, manual adjustment, automatic cooling and heating.
- * The insulation layer of the box is made of polyurethane foam, which has strong heat insulation ability.
- * Multiple choices of power supply mode: 220V AC power supply, 12V vehicle power supply.
- * Using high-efficiency refrigeration sheet and high-precision temperature control system, it can reach the set temperature in a short time.

Technical Parameters

Model	BJPX-PZ8	BJPX-PZ12	BJPX-PZ15	BJPX-PZ19	BJPX-PZ30
Capacity	8L, 8bags of 200ml	12L, 10bags of 200ml	15L, 13bags of 200ml	19L, 17bags of 200ml	30L, 28bags of 200ml
Temp. Control Range	4±2°C				
Heating Power	80W				
Cooling Power	80W				
Power Supply	220V, 50Hz, DC12V				
External Size(mm)	440*310*340	400*280*330	400*300*350	500*250*400	600*300*400
Net Weight(kg)	4.8	5	6	5.5	7.3
Packing Size(mm)	500*370*400	460*340*390	460*360*450	560*310*490	665*360*490
Gross Weight(kg)	6.3	6.5	8	7.5	10.3

Portable Refrigerator



Technical Parameters

Model	BJPX-L6	BJPX-L8	BJPX-L12	BJPX-L15
External Size(mm)	330*235*275	335*225*205	425*262*305	425*262*305
Internal Size(mm)	240*145*180	295*167*168	325*170*225	363*203*244
Inner Capacity	6L	8L	12L	15L
Configuration	1pc refrigerator 4pcs Crystal Ice 400ml 1pc digital thermometer	1pc refrigerator 4pcs Crystal Ice 400ml 1pc digital thermometer	1pc refrigerator 1pc tray 1pc partition 6 pcs Crystal storage ice box 400ml 1pc digital thermometer	1pc refrigerator 1pc strap 1pc digital thermometer 6 pcs Crystal storage ice box 400ml 1pc tray
Insulation Material	PU	EPS	PU	PU
External& Internal Material	External: PE Internal: PP			
Packing Size	380*270*300mm	380*270*300mm	460*340*340mm	460*340*340mm
Gross Weight	2.8kg	2.4kg	4kg	4.3kg

Model	BJPX-L20	BJPX-L33	BJPX-L55	BJPX-L65	BJPX-L85
External Size(mm)	450*330*300	580*310*360	640*395*395	620*485*375	640*520*375
Internal Size(mm)	370*235*240	480*270*265	590*335*320	540*425*315	580*465*320
Inner Capacity	20L	33L	55L	65L	85L
Configuration	1pc refrigerator 1pc strap 9pcs Crystal storage ice box 400ml 1pc partition 1pc tray 1pc digital thermometer	1pc refrigerator 12pcs Crystal ice box 400ml 1pc digital thermometer	1pc refrigerator 12pcs Crystal ice box 400ml 1pc digital thermometer	1pc refrigerator 15pcs Crystal ice box 400ml 1pc digital thermometer	1pc refrigerator 15pcs Crystal ice box 400ml 1pc digital thermometer
Insulation Material	PU	PU	PU	PU	PU
External& Internal Material	External: PE; Internal: PP				
Packing Size	490*360*340mm	580*320*380mm	670*430*430mm	640*505*395mm	650*540*400mm
Gross Weight	4.5kg	5.25kg	7.3kg	8kg	9.3kg

* Remarks: Each of BJPX-L6/15/20 has 1pc strap, other models not.

Biosafety Transport Box



BTB-L6



BTB-L8



BTB-L12 BTB-L15 BTB-L33



BTB-L20



BTB-L55



BTB-L65 BTB-L85

Technical Parameters:

Model	BTB-L6	BTB-L8	BTB-L12	BTB-L15
Outer Size(mm)	330*235*275	335*225*205	425*262*305	425*262*305
Inner Capacity	6L	8L	12L	15L
Product	1 box 1 strap 1 digital thermometer 1 95KPa biosafety transport tank	1 box 1 digital thermometer 2 95KPa biosafety transport tanks	1 box 1 strap 1 digital thermometer 2 95KPa biosafety transport tanks	1 box 1 strap 1 digital thermometer 3 95KPa biosafety transport tanks
Configuration	1 sponge reagent tube holder 1 piece of absorbent cotton 4 crystal ice boxes	2 sponge reagent tubes 2 pieces of absorbent cotton 4 crystal ice boxes	2 sponge reagent tubes 2 pieces of absorbent cotton 6 crystal ice boxes 1 tray	3 sponge reagent tubes 3 pieces of absorbent cotton 6 crystal ice boxes 1 tray
Material	PP+PE	PP	PP	PP
Insulation Material	PU	EPS	PU	PU
Gross Weight(kg)	3.2	2.9	4.5	4.8
Packing Size(mm)	380*270*300	380*270*300	460*340*340	460*340*340

Application

It can be used for the transportation of biological products requiring physical insulation, such as un2814, un2900, un3373 biological samples, pathogenic microorganism (virus) species, blood, etc

Features

- * Real time temperature value display
- * Refrigeration and temperature control to ensure the consistency of samples
- * Easy to operate and could be used repeatedly
- * Meet the basic requirements of cold chain transportation and storage of vaccines

Technical Parameters:

Model	BTB-L20	BTB-L33	BTB-L55	BTB-L65	BTB-L85
Outer Size(mm)	450*330*300	580*310*360	640*395*395	620*485*375	640*520*375
Inner Capacity	20L	33L	55L	65L	85L
Product	1 box 1 strap 1 digital thermometer 4 95KPa biosafety transport tanks	1 box 1 digital thermometer 5 95KPa biosafety transport tanks (6 cans are optional)	1 box 1 digital thermometer 8 95KPa biosafety transport tanks (optional 12 tanks)	1 box 1 digital thermometer 12 95KPa biosafety transport tanks	1 box 1 digital thermometer 20 95KPa biosafety transport tanks
Configuration	4 sponge reagent tubes 4 pieces of absorbent cotton 9 crystal ice boxes 1 partition 1 tray	5 sponge reagent tubes 5 pieces of absorbent cotton 11 crystal ice boxes	8 sponge reagent tubes 8 pieces of absorbent cotton 11 crystal ice boxes	12 sponge reagent tubes 12 pieces of absorbent cotton 15 crystal ice boxes	20 sponge reagent tubes 20 pieces of absorbent cotton 15 crystal ice boxes
Material	PP	PP	PP+PE	PP+PE	PP+PE
Insulation Material	EPS/PU	PU	PU	PU	PU
Gross Weight(kg)	5.5	6.5	9.3	11	14.3
Packing Size(mm)	490*360*340	580*320*380	670*430*430	640*505*395	650*540*400

Flake Ice Maker



FIM20/30/40/50

FIM60/70/85

E-mail: export@biobase.com
www.biobase.cc / www.biobase.com

Technical Parameters

Model	FIM20	FIM30	FIM40	FIM50	FIM60	FIM70	FIM85
Ice Making Capacity(kg/24h)	20	30	40	50	60	70	85
Max. Ice Storage Capacity(kg)	10	10	15	15	25	25	25
Ice Shape	Small particle of irregular snow ice						
Input Current(W)	280	300	360	380	420	460	480
Way of Condensation	Air cooling						
Ambient Temperature	10~35°C						
Water Temperature	2~15°C						
Tank Shell	Stainless steel						
Compressor	Donper		Panasonic Wanbao (for FIM40-100)				
Refrigerant	R290		R290				
Standard Accessories	Water inlet pipe*1, Drainage pipe*1, Ice spoon*1						
Optional Accessories	Filter						
Power Supply	AC 220V±10%, 50/60HZ; 110V±10%, 60HZ						
Net Weight(kg)	26		36		42		
Gross Weight(kg)	42		56		62		
External Size(W*D*H)mm	330*470*605		400*543*720		400*510*875		
Package Size(W*D*H)mm	460*590*740		520*660*840		520*640*960		

Flake Ice Maker



FIM100/120/150

FIM200/250

E-mail: export@biobase.com
www.biobase.cc / www.biobase.com

Technical Parameters

Model	FIM100	FIM120	FIM150	FIM200	FIM250
Ice Making Capacity(kg/24h)	100	120	150	200	250
Max. Ice Storage Capacity(kg)	40	40	40	60	60
Ice Shape	Small particle of irregular snow ice				
Input Current(w)	520	550	680	1040	1100
Way of Condensation	Air cooling				
Ambient Temperature	10~35°C				
Water Temperature	2~15°C				
Tank Shell	Stainless steel				
Compressor	Panasonic Wanbao		Donper		Panasonic Wanbao
Refrigerant	R290				
Standard Accessories	Water inlet pipe*1, Drainage pipe*1, Ice spoon*1				
Optional Accessories	Filter				
Power Supply	AC 220V±10%,50/60HZ ; 110V±10%, 60HZ				
Net Weight(kg)	58		60		80
Gross Weight(kg)	82		84		105
External Size(W*D*H)mm	500*611*940			680*611*1100	
Package Size(W*D*H)mm	720*620*1160			730*790*1320	

Various types of experiments, hospitals, schools, laboratories,medical, chemical applications, supermarkets, hotels and other seafood products stores etc.

Split-Type Flake Ice Maker



Applicable area

Various types of experiments, hospitals, schools, laboratories, medical, chemical applications, supermarkets, hotels and other seafood products stores etc.

Technical Parameters

Model	FIM300	FIM500
Ice Making Capacity(kg/24h)	300	500
Max. Ice Storage Capacity(kg)	150	200
Ice Shape	Small particle of irregular snow ice	
Input Current(w)	1360	2100
Way of Condensation	Air cooling	
Ambient Temperature	10~35°C	
Water Temperature	2~15°C	
Tank Shell	Stainless steel	
Refrigerant	SECOP /R404a	Embraco/R404a
Standard Accessories	Water inlet pipe*1, Drainage pipe*1, Ice spoon*1	
Optional Accessories	Filter	
Power Supply	AC 220V±10%,50/60HZ ; 110V±10%, 60HZ	
Net Weight(kg)	95	125
Gross Weight(kg)	125	155
External Size (W*D*H)mm	Head Size 560*550*570 Ice Tank Size 570*830*1020	600*760*740 770*765*1130
Package Size (W*D*H)mm	Head Size 640*660*890 Ice Tank Size 640*860*990	700*850*995 860*870*1050

Cube Ice Machine



CIM-65/80/120

CIM-180/210/260

Application

- * Cube ice, large contact area, adjustable ice thickness.
- * Stainless steel and ABS engineering plastic shell, beautiful shape, strong, practical.
- * Nickel-plated copper ice plate, flowing vertical ice making, high ice making efficiency, energy saving.
- * "Intelligent core" control system, automatic ice making, automatic ice falling, ice full detection.
- * One-button cleaning function, convenient daily maintenance.
- * LED screen, clear operation, accurate understanding of the machine's working conditions.
- * The tank, sink, and water distribution pipe all meet the food grade standards, safe and hygienic.
- * Built-in refrigerator.
- * The three basic parts(computer board, fan, condenser) are guaranteed for five years.

Technical Parameters

Model	CIM-65	CIM-80	CIM-120	CIM-180	CIM-210	CIM-260
Ice Making Capacity(kg/24h)	30	40	60	80	100	120
Max. Ice Storage Capacity(kg)	15			45		
Ice Shape	Standard: Cube Ice 22*22*22mm 10g Optional: Cube Ice 28*13*23mm 7g, Cube Ice 28*28*23mm 15g Choose one of the three Types.					
Ice Grid	4*9	4*10	5*12	5*16	5*18	6*18
Way of Condensation	Standard: Air cooling Optional: Water cooling					
Ambient Temperature	1°C~40°C					
Water Temperature	5°C~35°C					
Compressor	Wanbao					
Refrigerant	R404A/R290					
Optional Accessories	UV lamp					
Power Supply	Standard: AC220V±10%, 50Hz Optional: AC220V±10%, 60Hz AC110V±10%, 60Hz					
Input Current(W)	280	300	360	580	600	650
Net Weight(kg)	34	34	35	54	55	56
Gross Weight(kg)	38	38	39	59	60	61
External Size(W*D*H)mm	500*450*800	500*450*800	500*450*800	660*680*930	660*680*930	660*680*930
Package Size(W*D*H)mm	580*510*850	580*510*850	580*510*850	740*750*920	740*750*920	740*750*920