

Q Series

Instrumentation Quick Connectors



Applications

- Gauge Calibration
- Sampling System
- Portable Test Equipment
- Laboratory Equipment
- Gas Distribution
- Biopharmaceutical

Design and Engineering

- End Connection Size from 1/4" ~ 1/2" (6mm~12mm)
- Working pressure up to 3,000psig (206bar)
- Temperature up to 400°F (204°C) with Viton O-Ring
- Long Life cycle.

Operation of Hy-Lok Quick Connectors

- Use filters in front of quick connectors.
- Protect uncoupled body and stem with body and stem protectors or dust caps.
- Keep body and stem aligned when coupling and uncoupling.
- Couple and uncouple the quick connectors at room temperature.
- Couple and uncouple the quick connectors during system cleaning operation.
- Support hanging hoses or other equipments to prevent side load.
- Re-lubricate stem seal o-ring periodically.

Pressure-Temperature Ratings

Temperature °F (°C)	316 SS			Brass		
	Q1	Q2	Q3	Q1	Q2	Q3
Pressure Rating, psig(bar)						
Coupled						
70(20)	3000 (206)	1500 (103)	750 (52)	2000 (137)	1000 (69)	500 (34)
400 (204)	250 (17)					
Uncoupled and When Coupling and Uncoupling						
70 (20)	250 (17)					

Option of O-Ring Materials

Various O-ring materials, available whose temperature ratings are shown below.

Material	Temperature Rating
NBR	-10°F to 250°F (-23°C to 121°C)
Kalrez	-10°F to 600°F (-23°C to 315°C)
Neoprene	-40°F to 250°F (-40°C to 121°C)
Ethylene Propylene	-50°F to 300°F (-46°C to 149°C)

Features & Benefits

- Easy to use
- Minimum equipment shutdown.
- No tools required to make or break a connection.
- No probability of cross threading, galling, under or over-tightening.
- Interchangeable with same type of Swagelok, Parker, Hoke and TOMCO components.
- Single End shut-Off : This type of quick connector offers body shut-off valve function instead of stem shut-off.
- Double End shut-Off : This type of quick connector has same function with single End shut-off but, it has a small poppet valve in the stem. The pressure is automatically shut-off when the stem is removed from the body. It minimizes a spillage.

Spillage and Air Inclusion

Series	Spillage cm ³	Air Inclusion cm ³
Q1	0.3	0.3
Q2	1.0	1.0
Q3	3.0	3.0

Spillage - Spillage is the amount of system fluid that emit when a quick connector is uncoupled(DES0 only)

Air Inclusion - Air inclusion is the amount of air trapped between the body and stem that enter the system when a quick connect is coupled(DES0 only)

Maximum Flow Cv Rate at 70 °F(20 °C)

Series	Water Flow u.s. gal/min (L/min)
Q1	4 (15.1)
Q2	6 (22.7)
Q3	10 (37.8)

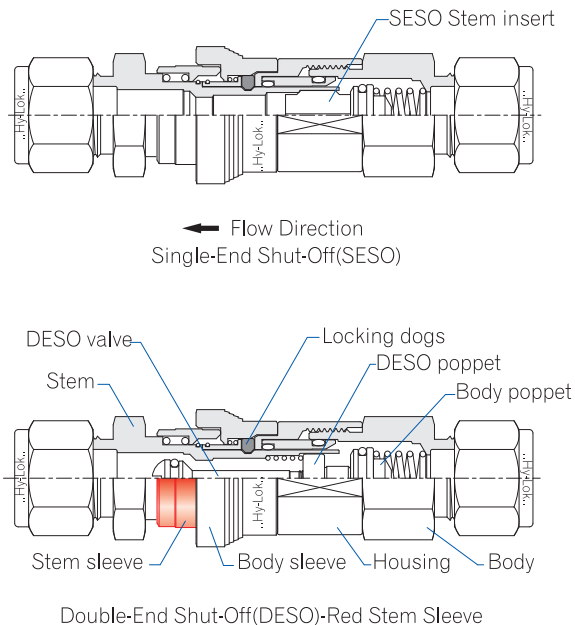

Technical Data

Materials of Construction

Description	Material	
	316 SS	Brass
Locking dogs	PTFE -coated 316SS powdered metal	
SESO stem sleeve	316 SS	Brass
DES0 stem sleeve	Polyurethane enamel coated 316	Polyurethane enamel coated brass
Body sleeve	316 SS powdered metal	Brass
Snap rings	Stainless Steel	
Springs*	Stainless Steel	
O-rings*	Viton	
SESO stem insert*	316 SS	Brass
Body poppet, Body insert, DES0 valve, DES0 poppet*	316 SS	Brass
Body, housing, stem*	316 SS	Brass

Note : "*" marked are wetted parts, Lubricant is silicone based.

Stems

Hy-Lok Tube Ends

Part number		Tube O.D	Series	Flow Coefficient(Cv)		Dimensions					
SESO	DESO			SESO	DESO	L				H	
						Width across flat		mm		in.	
Q1SSH- 2T	Q1DSH- 2T	1/8"	Q1	0.08	0.08	58.9	2.32	60.4	2.77	15.8	5/8
Q1SSH- 4T	Q1DSH- 4T	1/4"	Q1	0.30	0.20	59.9	2.36	61.5	2.42	15.8	5/8
Q2SSH- 6T	Q2DSH- 6T	3/8"	Q2	1.00	0.50	64.0	2.52	67.1	2.64	19.1	3/4
Q3SSH- 8T	Q3DSH- 8T	1/2"	Q3	2.40	1.50	75.2	2.96	80.3	3.16	23.8	15/16
Q1SSH- 6M	Q1DSH- 6M	6mm	Q1	0.30	0.20	59.9	2.36	61.5	2.42	15.8	5/8
Q2SSH-10M	Q2DSH-10M	10mm	Q2	1.00	0.50	67.3	2.65	70.4	2.79	19.1	3/4
Q3SSH-12M	Q3DSH-12M	12mm	Q3	2.40	1.50	75.2	2.96	80.3	3.16	23.8	15/16

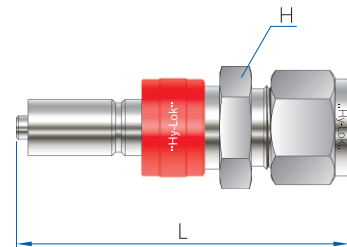

Male Pipe

Part number		Pipe Size	Series	Flow Coefficient(Cv)		Dimensions					
SESO	DESO			SESO	DESO	L				H	
						Width across flat		mm		in.	
Q1SSM-01N	Q1DSM-01N	1/8"NPT	Q1	0.3	0.2	52.6	2.07	54.1	2.13	15.8	5/8
Q1SSM-02N	Q1DSM-02N	1/4"NPT	Q1	0.3	0.2	56.4	2.22	57.9	2.28	15.8	5/8
Q2SSM-02N	Q2DSM-02N	1/4"NPT	Q2	0.9	0.5	58.9	2.32	61.9	2.44	19.1	3/4
Q2SSM-03N	Q2DSM-03N	3/8"NPT	Q2	0.8	0.5	59.7	2.35	62.7	2.47	19.1	3/4
Q3SSM-04N	Q3DSM-04N	1/2"NPT	Q3	2.0	1.3	72.1	2.84	77.2	3.04	23.8	15/16
Q1SSM-02R	Q1DSM-02R	1/4"PT	Q1	0.3	0.2	56.4	2.22	57.9	2.28	15.8	5/8
Q2SSM-03R	Q2DSM-03R	3/8"PT	Q2	0.8	0.5	59.7	2.35	62.7	2.47	19.1	3/4
Q3SSM-04R	Q3DSM-04R	1/2"PT	Q3	2.0	1.3	72.1	2.84	77.2	3.04	23.8	15/16

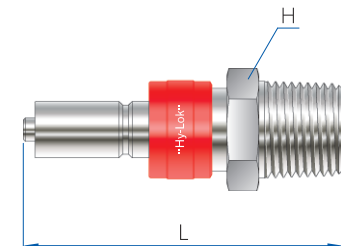

Female Pipe

Part number		Pipe Size	Series	Flow Coefficient(Cv)		Dimensions					
SESO	DESO			SESO	DESO	L				H	
						Width across flat		mm		in.	
Q1SSF-01N	Q1DSF-01N	1/8"NPT	Q1	0.3	0.2	51.1	2.01	52.6	2.07	15.8	5/8
Q1SSF-02N	Q1DSF-02N	1/4"NPT	Q1	0.3	0.2	57.4	2.26	58.9	2.32	19.1	3/4
Q2SSF-02N	Q2DSF-02N	1/4"NPT	Q2	0.9	0.5	59.7	2.35	62.7	2.47	19.1	3/4
Q2SSF-03N	Q2DSF-03N	3/8"NPT	Q2	0.8	0.5	59.7	2.35	62.7	2.47	22.2	7/8
Q3SSF-04N	Q3DSF-04N	1/2"NPT	Q3	2.0	1.3	71.6	2.82	76.7	3.02	26.9	1 1/16
Q1SSF-02R	Q1DSF-02R	1/4"PT	Q1	0.3	0.2	57.4	2.26	58.9	2.32	19.1	3/4
Q2SSF-03R	Q2DSF-03R	3/8"PT	Q2	0.8	0.5	59.7	2.35	62.7	2.47	22.2	7/8
Q3SSF-04R	Q3DSF-04R	1/2"PT	Q3	2.0	1.3	71.6	2.82	76.7	3.02	26.9	1 1/16

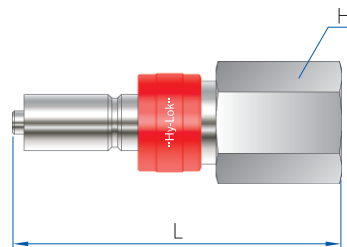

Red colored stem sleeve : DESO type.
Dimensions are for reference only, subject to change.

37° Flared Tube Ends

Part number		Tube O.D	Series	Flow Coefficient(Cv)		Dimensions					
SESO	DESO			SESO	DESO	L				H	
						mm	in.	mm	in.	mm	in.
Q1SS3F-4T	Q1DS3F-4T	1/4"	Q1	0.3	0.2	56.1	2.21	57.7	2.27	15.8	5/8
Q2SS3F-6T	Q2DS3F-6T	3/8"	Q2	1.0	0.5	58.8	2.31	61.9	2.44	19.1	3/4
Q3SS3F-8T	Q3DS3F-8T	1/2"	Q3	2.4	1.5	70.1	2.76	75.2	2.96	23.8	15/16

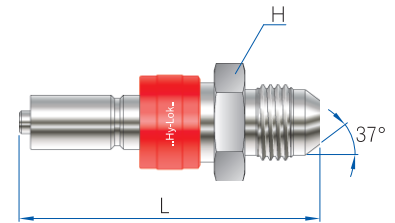

Hose Barb

Part number		Tube O.D	Series	Flow Coefficient(Cv)		Dimensions					
SESO	DESO			SESO	DESO	L				H	
						mm	in.	mm	in.	mm	in.
Q1SSHB-4T	Q1DSHB-4T	1/4"	Q1	0.3	0.2	62.2	2.45	63.8	2.51	15.8	5/8
Q2SSHB-6T	Q2DSHB-6T	3/8"	Q2	1.0	0.5	66.8	2.63	69.9	2.75	19.1	3/4
Q3SSHB-8T	Q3DSHB-8T	1/2"	Q3	2.0	1.3	77.3	3.04	82.4	3.24	23.8	15/16

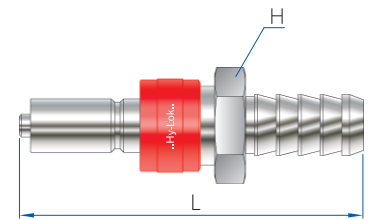

Hy-Lok Bulkhead Tube Ends

Part number		Tube O.D	Series	Dimensions									
SESO	DESO			L				Min Panel Hole Dia		Max Panel Thickness		H	
				SESO		DESO		mm	in.	mm	in.	mm	in.
				mm	in.	mm	in.						
Q1SSBH- 4T	Q1DSBH- 4T	1/4"	Q1	69.6	2.74	71.1	2.80	11.9	15/32	6.4	0.25	15.8	5/8
Q2SSBH- 6T	Q2DSBH- 6T	3/8"	Q2	74.2	2.92	78.0	3.27	15.1	19/32	6.9	0.27	19.1	3/4
Q3SSBH- 8T	Q3DSBH- 8T	1/2"	Q3	87.1	3.43	92.2	3.63	19.8	25/32	6.6	0.26	23.8	15/16
Q1SSBH- 6M	Q1DSBH- 6M	6mm	Q1	69.6	2.74	71.1	2.80	11.9	29/64	6.4	0.25	16.0	-
Q2SSBH-10M	Q2DSBH-10M	10mm	Q2	77.7	3.06	78.7	3.10	16.7	21/32	6.9	0.27	22.0	-
Q3SSBH-12M	Q3DSBH-12M	12mm	Q3	87.1	3.43	92.2	3.63	19.6	49/64	6.6	0.26	24.0	-

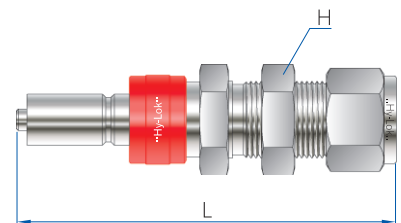

Red colored stem sleeve : DESO type.
Dimensions are for reference only, subject to change.

Bodies

Hy-Lok Tube Ends

Part number	Tube O.D	Series	L		D		H Width across flat	
			mm	in.	mm	in.	mm	in.
Q1BH - 2T	1/8"	Q1	57.4	2.26	23.1	0.91	15.8	5/8
Q1BH - 4T	1/4"	Q1	58.4	2.30	23.1	0.91	15.8	5/8
Q2BH - 6T	3/8"	Q2	65.5	2.58	26.2	1.03	19.1	3/4
Q3BH - 8T	1/2"	Q3	78.5	3.09	30.7	1.21	23.8	15/16
Q1BH - 6M	6mm	Q1	58.4	2.30	23.1	0.91	15.8	5/8
Q2BH - 10M	10mm	Q2	68.1	2.68	26.2	1.03	19.1	3/4
Q3BH - 12M	12mm	Q3	78.5	3.09	30.7	1.21	23.8	15/16

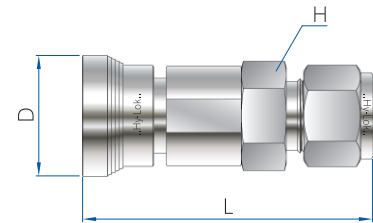

Male Pipe

Part number	Pipe Size	Series	L		D		H Width across flat	
			mm	in.	mm	in.	mm	in.
Q1BM - 01N	1/8" NPT	Q1	51.1	2.01	23.1	0.91	15.8	5/8
Q1BM - 02N	1/4" NPT	Q1	54.9	2.16	23.1	0.91	15.8	5/8
Q2BM - 02N	1/4" NPT	Q2	60.5	2.38	26.2	1.03	19.1	3/4
Q2BM - 03N	3/8" NPT	Q2	60.5	2.38	26.2	1.03	19.1	3/4
Q3BM - 04N	1/2" NPT	Q3	75.4	2.97	30.7	1.21	23.8	15/16
Q1BM - 02R	1/4" PT	Q1	54.9	2.16	23.1	0.91	15.8	5/8
Q2BM - 03R	3/8" PT	Q2	60.5	2.38	26.2	1.03	19.1	3/4
Q3BM - 04R	1/2" PT	Q3	75.4	2.97	30.7	1.21	23.8	15/16

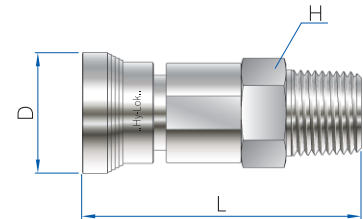

Female Pipe

Part number	Pipe Size	Series	L		D		H Width across flat	
			mm	in.	mm	in.	mm	in.
Q1BF - 01N	1/8" NPT	Q1	54.9	2.16	23.1	0.91	15.8	5/8
Q1BF - 02N	1/4" NPT	Q1	61.5	2.42	23.1	0.91	19.1	3/4
Q2BF - 02N	1/4" NPT	Q2	64.5	2.54	26.2	1.03	19.1	3/4
Q2BF - 03N	3/8" NPT	Q2	65.3	2.57	26.2	1.03	22.2	7/8
Q3BF - 04N	1/2" NPT	Q3	81.8	3.22	30.7	1.21	26.9	1 1/16
Q1BF - 02R	1/4" PT	Q1	61.5	2.42	23.1	0.91	19.1	3/4
Q2BF - 03R	3/8" PT	Q2	65.3	2.57	26.2	1.03	22.2	7/8
Q3BF - 04R	1/2" PT	Q3	81.8	3.22	30.7	1.21	26.9	1 1/16

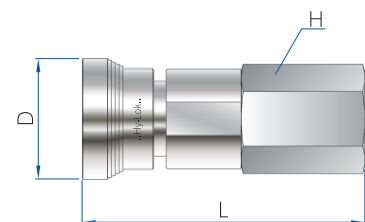

Dimensions are for reference only, subject to change.

37° Flared Tube Ends

Part number	Tube O.D	Series	L		D		H Width across flat	
			mm	in.	mm	in.	mm	in.
Q1B3F-4T	1/4"	Q1	54.6	2.15	23.1	0.91	15.8	5/8
Q2B3F-6T	3/8"	Q2	60.3	2.37	26.2	1.03	19.1	3/4
Q3B3F-8T	1/2"	Q3	73.4	2.89	30.7	1.21	23.8	15/16

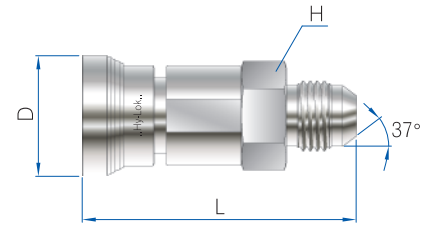

Hose Barb

Part number	Tube O.D	Series	L		D		H Width across flat	
			mm	in.	mm	in.	mm	in.
Q1BHB-4T	1/4"	Q1	60.7	2.39	23.1	0.91	15.8	5/8
Q2BHB-6T	3/8"	Q2	68.3	2.69	26.2	1.03	19.1	3/4
Q3BHB-8T	1/2"	Q3	80.6	3.17	30.7	1.21	23.8	15/16

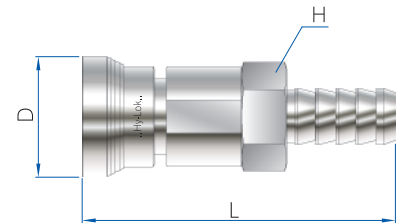

Hy-Lok Bulkhead Tube Ends

Part number	Tube O.D	Series	L		D		Min Panel Hole Dia		Max Panel Thickness		H Width across flat	
			mm	in.	mm	in.	mm	in.	mm	in.	mm	in.
Q1BBH - 4T	1/4"	Q1	67.8	2.67	23.1	0.91	11.9	15/32	6.4	0.25	15.8	5/8
Q2BBH - 6T	3/8"	Q2	75.7	2.98	26.2	1.03	15.1	19/32	6.9	0.27	19.1	3/4
Q3BBH - 8T	1/2"	Q3	90.4	3.56	30.7	1.21	19.8	25/32	6.6	0.26	23.8	15/16
Q1BBH - 6M	6mm	Q1	67.8	2.67	23.1	0.91	11.9	29/64	6.4	0.25	16.0	-
Q2BBH - 10M	10mm	Q2	75.9	2.99	26.2	1.03	16.7	21/32	6.9	0.27	22.0	-
Q3BBH - 12M	12mm	Q3	90.4	3.56	30.7	1.21	19.6	49/64	6.6	0.26	24.0	-

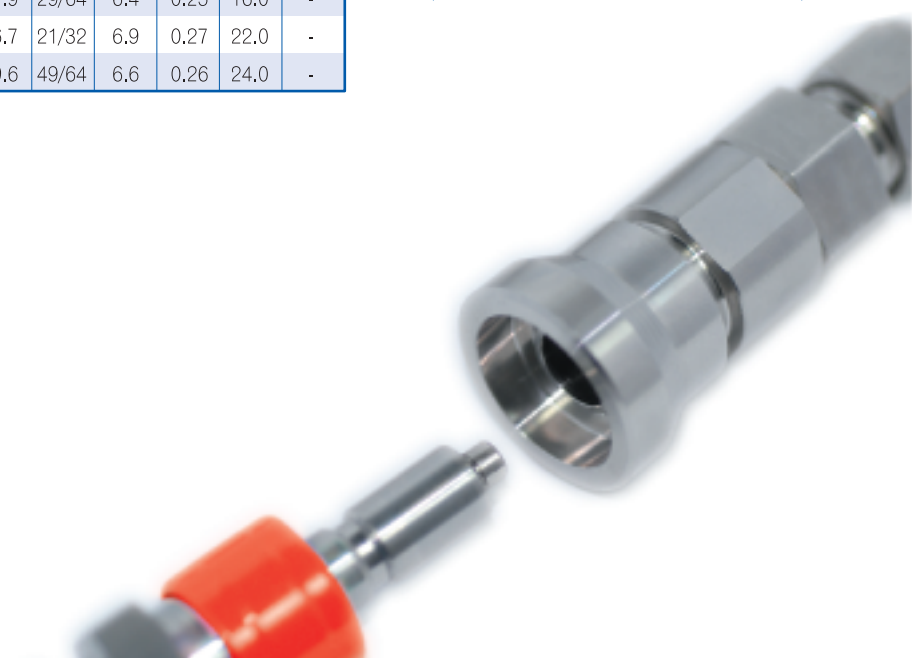
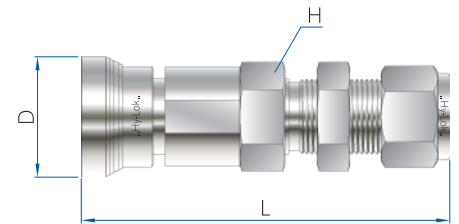

Dimensions are for reference only, subject to change.

Insertion Depth

Series	Depth, mm(in)			
	SESO		DESO	
	mm	in.	mm	in.
Q1	27.7	1.09	29.2	1.15
Q2	30.0	1.18	33.0	1.30
Q3	37.6	1.48	42.7	1.68

To calculate overall length in the coupled position, subtract the insertion depth from any overall stem and body combination length.

Accessory

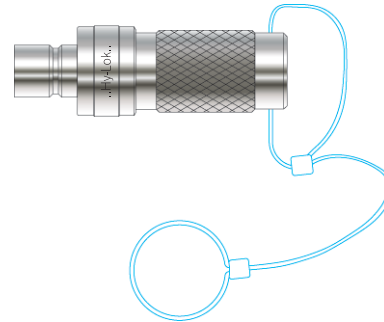
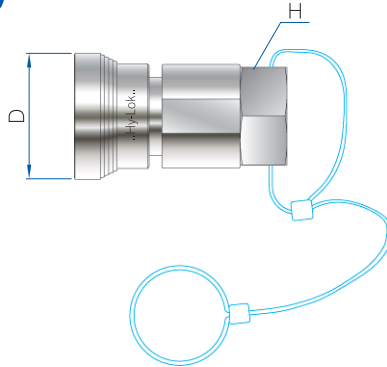

Stem Protectors

Part number	Series	D		H Width across flat	
		mm	in.	mm	in.
		Q1SP	Q1	23.1	0.91
Q2SP	Q2	26.2	1.03	19.1	3/4
Q3SP	Q3	30.7	1.21	23.8	15/16

Body Protectors

Part number	Series
Q1BP	Q1
Q2BP	Q2
Q3BP	Q3

Installation Instruction

⚠ Warning :

System pressure must not exceed 250psig (17.2bar) at 70°F (20°C) when coupling and uncoupling the product. When uncoupling single-end shutoff quick-connectors, system pressure on stem side will be vent to atmosphere.

To couple :

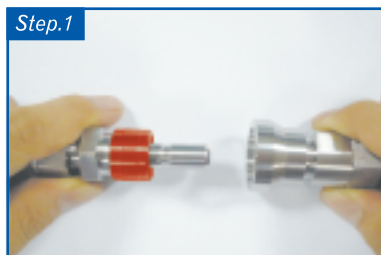

Align stem and body.

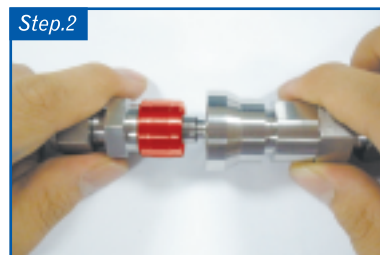

Push the stem into the body.

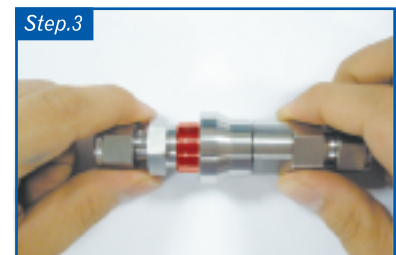

Connections is complited when it "clicks"

To uncouple :

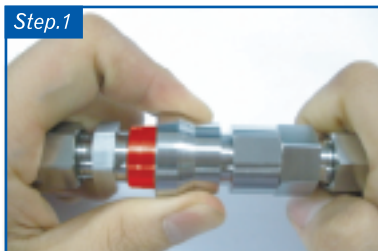

Pull the body sleeve toward the stem.

Caution :

- Do not rotate quick connectors while coupled.
- Do not insert a foreign objects into the uncoupled bodies or stems.

Ordering Informations

Q1

Series Designator

- Q1 - 1/4"
- Q2 - 3/8"
- Q3 - 1/2"

B

Component Designator

- B - Body
- SS - SESO Stems
- DS - DESO Stems
- SP - Stem Protectors
- BP - Body Protectors

H

End Connection Designator

- H - Hy-Lok Tube Ends
- M - Male Pipe
- F - Female Pipe
- 3F - 37Flared Tube Ends
- HB - Hose Barb
- BH - Hy-Lok Bulkhead Tube Ends

4T

Size Designator

EP

O-ring Material Designator

- BU - NBR(Buna N)
- KA - Kalez
- NE - Neoprene
- EP - Ethylene Propylene

S316

Body Material Designator

- S316 - 316 Stainless Steel
- BRAS - Brass

Tube

Fractional Tube	O.D.(in.)	1/8	1/4	3/8	1/2
	Designator	2T	4T	6T	8T
Metric Tube	O.D.(in.)	6	8	10	12
	Designator	6M	8M	10M	12M

Thread

Thread	1/8" NPT	1/4" NPT	3/8" NPT	1/2" NPT
Designator	01N	02N	03N	04N
Thread	1/8" PT	1/4" PT	3/8" PT	1/2" PT
Designator	01R	02R	03R	04R
Thread	1/8" PF	1/4" PF	3/8" PF	1/2" PF
Designator	01G	02G	03G	04G

