



SURFACE CLEANER

operation manual



Model #
1011.0030.00
1011.0040.00



Attention: Read through the complete manual prior to the initial use of your surface cleaner

Using the Operator's manual

The operating manual is an important part of your surface cleaner and should be read thoroughly before initial use, and referred to often to make sure adequate safety and service concerns are being addressed.

Reading the owner's manual thoroughly will help avoid any personal injury or damage to your pump. The information in this manual will offer you the most effective tools for cleaning as well as the safest. By knowing how best to operate this machine you will be better positioned to show others who may also operate the unit.

This manual contains information for the complete range of our surface cleaners and is placed in order starting from the safety requirements to the operating functions of your pump. You can refer back to the manual at any time to help troubleshoot any specific operating functions, so store it with the machine at all times.



Set-Up

1. Fit the lower portion of the handle into the mounting brackets on the cover and secure with the bolts or the pins & clips.
2. Next, tighten the “fixed” hose end into the gun mounted onto the upper portion of the handle. Use teflon tape on the hose ends.
3. Once this is complete, join the two sections of the handle together and secure with the bolt or the pin & clip. Tighten the swivel end of the hose into the top of the rotary head.
4. Turn the cover over and check to ensure that the nozzle tips are securely tightened and the spray pattern is in line with the rotary arm.

Operation

The Surface Cleaning System you have purchased connects directly to your high pressure hose and pressure washer , operating to a maximum of 4000 PSI-280bar .

This Surface Cleaner is designed to operate with both hot & cold water pressure washers. We do not recommend the use of hot water as the nylon brush skirt will soften and wear prematurely,

During operation, should you experience a buildup of small stones or other foreign material within the cover, we recommend that you simply tip the cleaner on its side at 45° which should expel any foreign materials. This will give longer wear to your tips and swivel arm.

The tips that have been installed on your surface cleaning system permit the use of your cleaner with a pressure washer producing up to 7 GPM-25L/M at 4000 PSI-280bar. Higher GPM tips should be installed if your pressure washer has a higher GPM/PSI rating. Periodically check the tips to ensure they are not plugged by dirt particles.

It is very important when operating your Surface Cleaner that you maintain a continuous motion.



While operating your surface cleaning system, please ensure that the nylon brush skirt remains in contact with the surface being cleaned. Do not operate on vertical or overhead surfaces. We strongly recommend that safety eye goggles, gloves and work boots be worn when operating this Surface Cleaner. Keep hands and feet away from the high pressure, high speed rotating arm that is protected by the plastic cover. Should your surface cleaner not be used for long periods of time, it is recommended that you remove the hose from the top of the rotary head

It is designed to give you a safe and rapid method for cleaning hard surfaces, and will save you time in comparison to using a conventional gun and wand. The durability of this surface cleaning system is enhanced by the way it is handled by the operator. Please take care to ensure that the Surface Cleaner is not continuously being swung against buildings, curbs, etc., which can damage the cover. Also, be aware that the high speed rotating arm must not come in contact with rigid protruding objects which can quickly damage or completely break off the steel arm. Finally, do not apply excessive weight to the plastic cover.

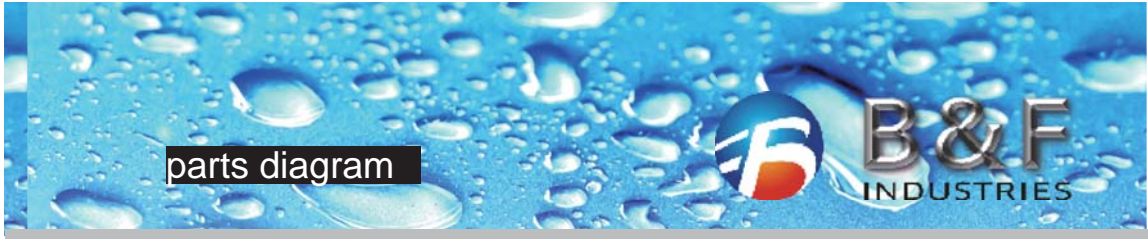

1011.0030.00

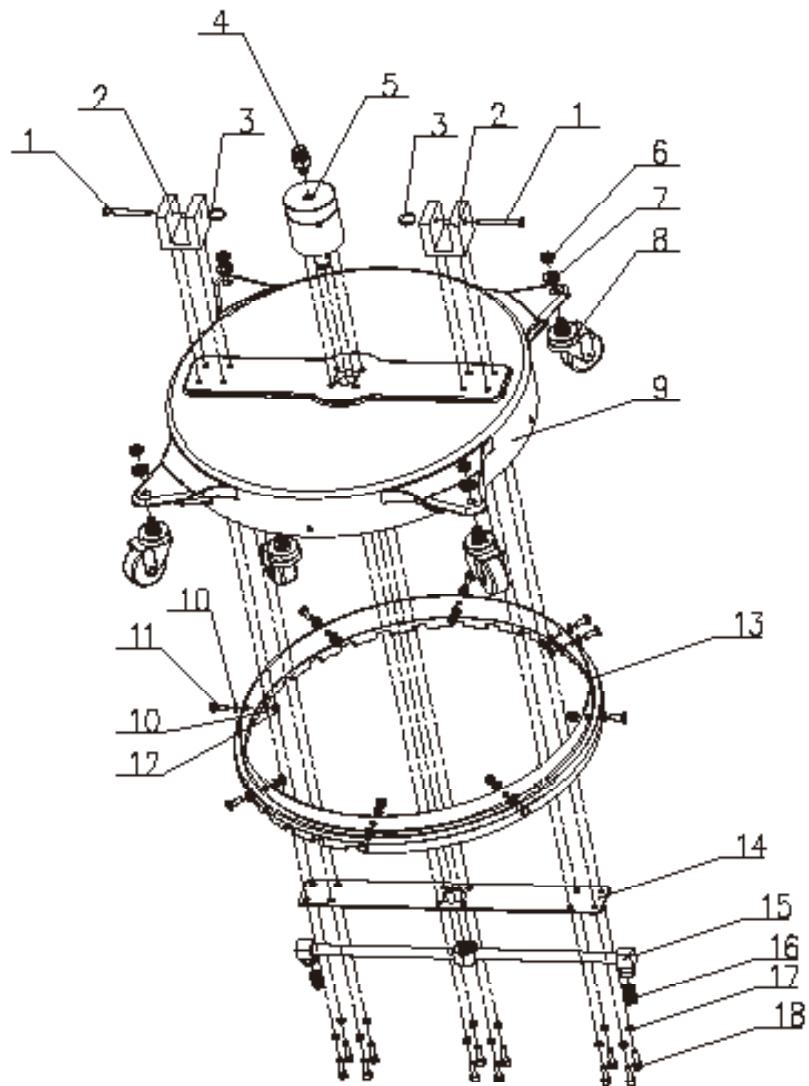

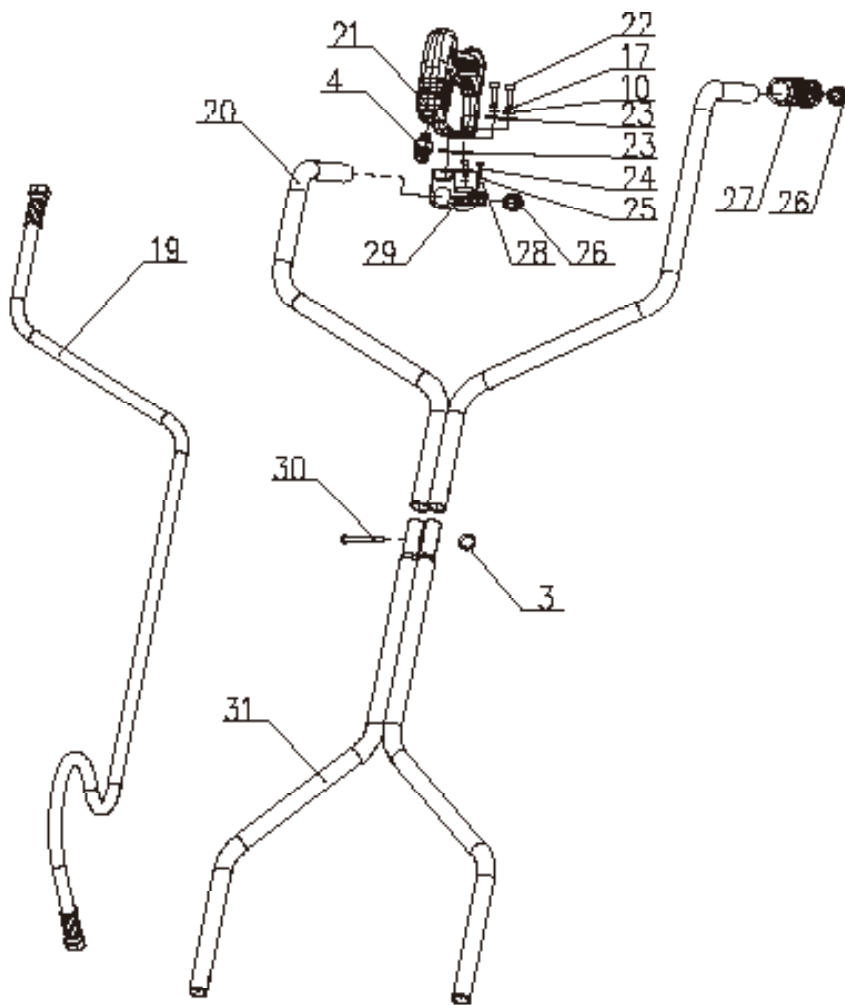



1011.0030.00

No#	Part #	Description	Qty. for unit
1	18-01	PIN L67	2
2	18-02	Bracket	2
3	18-03	O- Clip	3
4	18-04	Adaptor 3/8”M-1/4”M	2
5	18-05	Rotary head	1
6	18-06	D 10 Screw nut	4
7	18-07	D 10 Bush	4
8	18-08	Caster	4
9	18-09	Cover, Polypropylene 18”	1
10	18-10	D 6 Bush	10
11	18-11	Screw belt M6 x 20 hex.	9
12	18-12	Screw nut D10	9
13	18-13	Brush skirt 18”	1
14	18-14	Strengthen bar	1
15	18-15	Spray arm	1
16	18-16	Nozzle 25025	2
17	18-17	Spring bush D6	14
18	18-18	Screw belt M6 x 18 hex	12
19	18-19	Pressure hose	1
20	18-20	Handle , Upper	1
21	18-21	Spray gun	1
22	18-22	Screw belt M6 x 18 hex	2
23	18-23	Strengthen bar for gun	2
24	18-24	Screw belt M4 x 12 hex.	2
25	18-25	Spring bush D 4	2
26	18-26	Plastic block	2
27	18-27	Handle grip	1
28	18-28	Bush D 4	2
29	18-29	Plastic bracket	1
30	18-30	Pin L 52	1
31	18-31	Handle lower	1

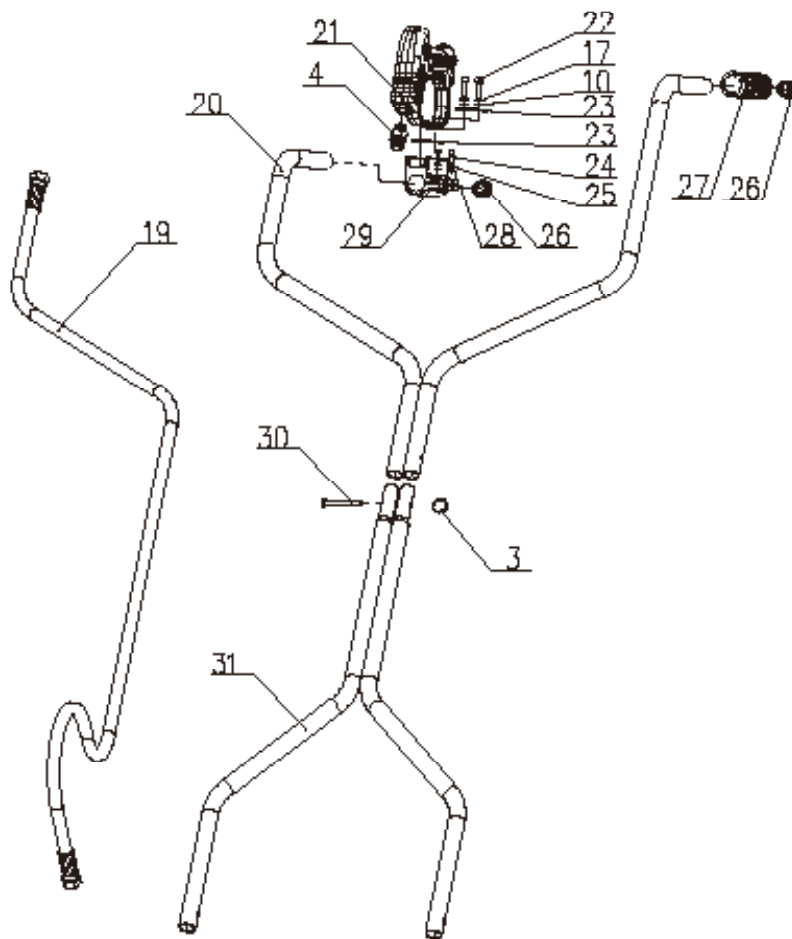
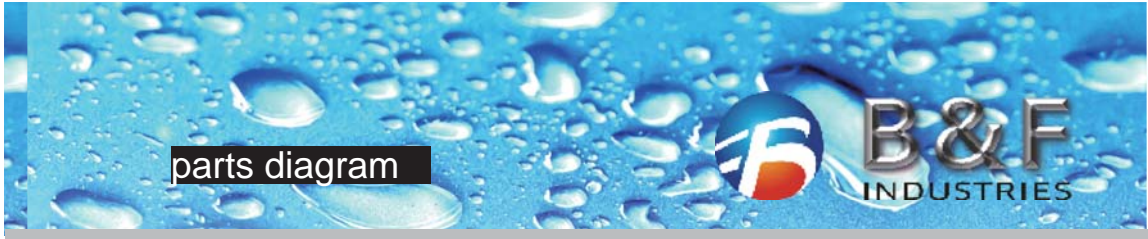



1011.0040.00

No#	Part #	Description	Qty. for unit
1	20-01	PIN L67	2
2	20-02	Bracket	2
3	20-03	O-clips	3
4	20-04	Adaptor 3/8"M-1/4"M	2
5	20-05	Rotary hed	1
6	20-06	Screw nut D10	4
7	20-07	Bush D10	4
8	20-08	Castor	4
9	20-09	Cover stainless steel	1
10	20-10	Bush D6	28
11	20-11	Screw belt M6 x 12	13
12	20-12	Screw nut D6	13
13	20-13	Brush skirt 20"	1
14	20-14	Brackct stainless steel for wheel	4
15	20-15	Spray arm	1
16	20-16	Spray nozzle	2
17	20-17	Spring bush D6	14
18	20-18	Screw belt M6 x 12	12
19	20-19	Pressure hose	1
20	20-20	Handle upper	1
21	20-21	Spray gun	1
22	20-22	Screw belt M6 x 18	2
23	20-23	Strengthen bar stainless steel	2
24	20-24	Scrw belt M4 x 12	2
25	20-25	Spring bush D 4	2
26	20-26	Plastic block	2
27	20-27	Handle grip	1
28	20-28	Bush D 4	2
29	20-29	Plastic bracket	1
30	20-30	Pin L 52	1
31	20-31	Handle lower	1



Warranty

The rotary head has a six-month warranty from the date of purchase. Should you encounter problems with the rotary head within that time period, simply return the defective part for replacement. If you encounter problems after the six month period has lapsed, we sell a rotary head, you can do the replacement very quickly.

There is no warranty on the nylon brush ring.

All other components of the surface cleaning system have a 30-day replacement warranty against manufacturer's defects only.

**If you need assistance with the
assembly or operation of your
Surface Cleaner pls. contact :
Tel:**