

PADEL

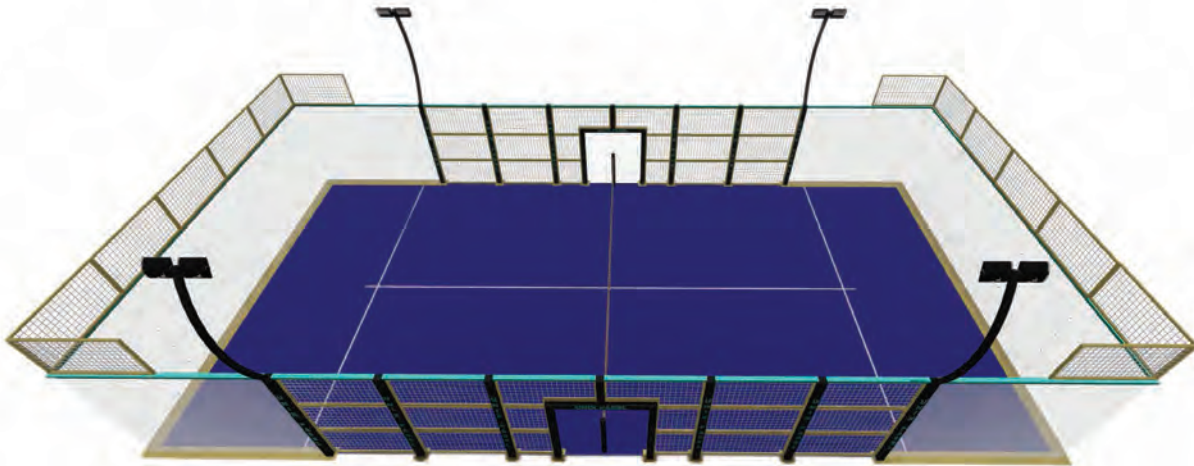

X FULL PANAROMIC COURT



- **Structure:** 120×120×4 mm. pillars duplicated at the corners and anchored to the ground with hilti type expansion plugs. Alternative solution is 160×160×4mm metallic structure.
- **Mesh:** Electrowelded 50×50×4 mm; embedded in the pillars, to avoid injuries and irregular bounces.
- **Color:** To be chosen by the client. (Blue, Black, Green, Terracotta, White, Silver,)
- **Finish:** Powder Electric galvanized paint. Optional: hot dip galvanized.
- **Lighting poles:** Straight T shape, Sigmoidal K shape or Oval D shape.
- **Lighting:** 200w LED spotlights (26,000 lumens).
- **Turf:** Monofilament or textured.
- **Glass:** Tempered glass 12 mm.

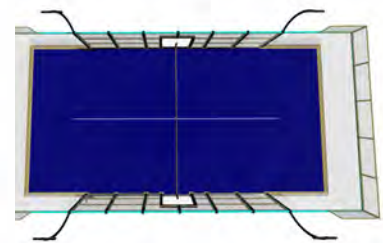
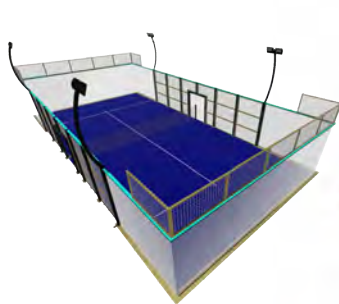
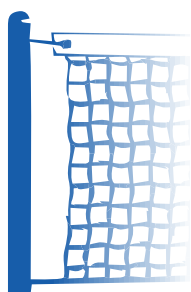
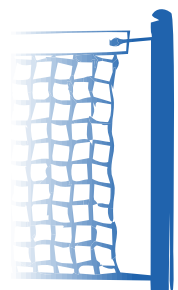

Table 1. TS498 Wind Load pressure values depending height



Height from ground m	Wind speed v m/s	Absorption q (kN/m ²)
0-8	28	0,5
9-20	36	0,8
21-100	42	1,1
<100	46	1,3



FULL PANAROMIC COURT



This is the King of all Panoramic Padel Courts in the market.

Full Panoramic Padel Court offers a very high structural strength against wind loads and the spectacular robust design allow you to enjoy Padel of the highest level. Unixpadel Padel Court structure study by Istanbul Technical University Technical departments againts wind loads and man power impact. Viewers have an optimal inside view to the playing surface. Recommended for an installation Outdoor and Indoor. Measurement of the padel Court 20mx10m inside game area and foundation area shall be 20,9m x 10,9m. For Indoor structure we are recommended 120x120x4mm metallic structure with 12mm tempered glass For outdoor structure we are recommended 160x160x4mm metallic structure 12mm tempered glass.

X PANAROMIC COURT



- **Structure:** 80×80×4 mm. pillars duplicated at the corners and anchored to the ground with hilti type expansion plugs.
- **Mesh:** Electrowelded 50×50×4 mm; embedded in the pillars, to avoid injuries and irregular bounces.
- **Color:** To be chosen by the client. (Blue, Black, Green, Terracotta, White, Silver,) Powder Electric galvanized paint. Optional: hot dip galvanized.
- **Lighting poles:** Straight T shape, Sigmoidal K shape or Oval D shape.
- **Lighting:** 200w LED spotlights (26,000 lumens).
- **Glass:** Tempered glass 10 or 12 mm.
- **Turf:** Monofilament or textured.

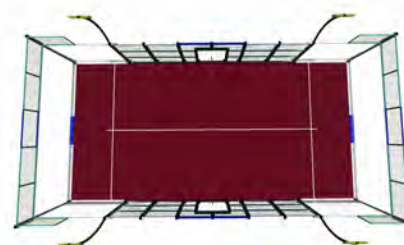
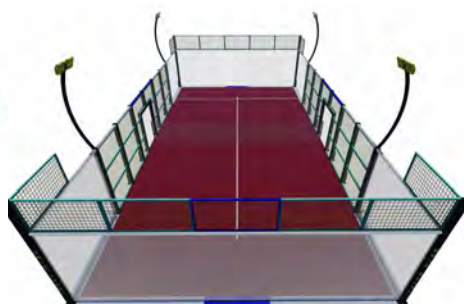
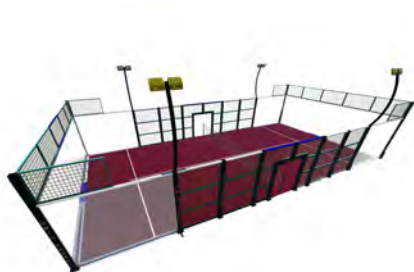

Table 1. TS498 Wind Load pressure values depending height

Height from ground m	Wind speed v m/s	Absorption q (kN/m ²)
0-8	28	0,5
9-20	36	0,8
21-100	42	1,1
<100	46	1,3

PANAROMIC COURT

Panaromic padel court offers excellent structural stability against wind loads. All vertical columns of this construction are reinforced by an additional tube of 80 x 80 x 4 mm. Reinforced and solid three-pillar frame construction and reinforced footplates to secure an optimal stability. This model is suitable for outdoors and indoors. We offer the Structural Analysis Report for this construction "Unixpadel Panaromic Padel Court structure" study by Istanbul Technical University Technical departments against wind loads and man power impact. Measurement of the padel Court 20mx10m inside game area and foundation area shall be 20,9m x 10,9m. See different strength classes. As general wind load value it is given as 0,5kN/m² on Table 12 of TS498 as the highest point of the height of building is lower than 8 meters. (Figure 6, Table 1). As all sides of Padel playground are closed with glass, crosswinds can be considered to be effective. Totally 1.2q horizontal force is applied as 0,8q pressure and 0,4q absorption on both of the sides. Thus wind force is formed as 0,8 x 0,5 = 0,4kN/m² pressure and 0,4 x 0,5 = 0,2kN/m² absorption. This line is specially designed for outdoor and indoor use.



X STANDARD PADEL COURT



- **Color:** To be chosen by the client. (Blue, Black, Green, Terracotta, White, Silver,)
- **Structure:** 80×60×3 mm. pillars duplicated at the corners and anchored to the ground with hilti type expansion plugs.
- **Finish:** Powder Electric galvanized paint. Optional: hot dip galvanized.
- **Mesh:** Electrowelded 50×50×4 mm; embedded in the pillars, to avoid injuries and irregular bounces.
- **Lighting poles:** Straight T shape, Sigmoidal K shape or Oval D shape
- **Lighting:** 200w LED spotlights (26,000 lumens).
- **Glass:** Tempered glass 10 or 12 mm.
- **Turf:** Monofilament or textured.



Table 1. TS498 Wind Load pressure values depending height

Height from ground m	Wind speed v m/s	Absorption q (kN/m ²)
0-8	28	0,5
9-20	36	0,8
21-100	42	1,1
<100	46	1,3

STANDARD PADEL COURT



Standard padel court offers excellent structural stability against wind loads. All vertical columns of this construction are reinforced by an additional tube of 80 x 60 x 3 mm. Reinforced and solid three-pillar frame construction and reinforced footplates to secure an optimal stability. This model is suitable for outdoors and indoors. We offer the Structural Analysis Report for this construction "Unixpadel Standard Padel Court structure" study by Istanbul Technical University Technical departments against wind loads and man power impact. Measurement of the padel Court 20mx10m inside game area and foundation area shall be 20,9m x 10,9m. See different strength classes. As general wind load value it is given as 0,5kN/m² on Table 12 of TS498 as the highest point of the height of building is lower than 8 meters. (Figure 6, Table 1). As all sides of Padel playground are closed with glass, crosswinds can be considered to be effective. Totally 1.2q horizontal force is applied as 0,8q pressure and 0,4q absorption on both of the sides. Thus wind force is formed as 0,8 x 0,5 = 0,4kN/m² pressure and 0,4 x 0,5 = 0,2kN/m² absorption. This line is specially designed for outdoor and indoor use.

X SINGLE COURT

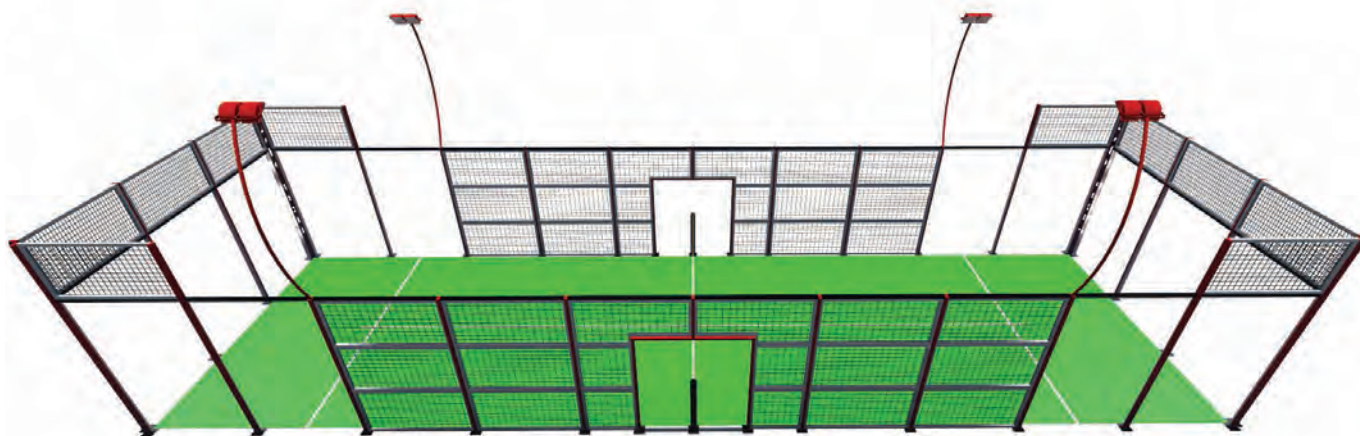

- **Color:** To be chosen by the client. (Blue, Black, Green, Terracotta, White, Silver,)
- **Structure:** 80x60x3 mm. pillars duplicated at the corners and anchored to the ground with hilti type expansion plugs.
- **Finish:** Powder Electric galvanized paint. Optional: hot dip galvanized.
- **Lighting poles:** Straight T shape, Sigmoidal K shape or Oval D shape
- **Mesh:** Electrowelded 50x50x4 mm; embedded in the pillars, to avoid injuries and irregular bounces.
- **Lighting:** 200w LED spotlights (26,000 lumens).
- **Glass:** Tempered glass 10 or 12 mm.
- **Turf:** Monofilament or textured.

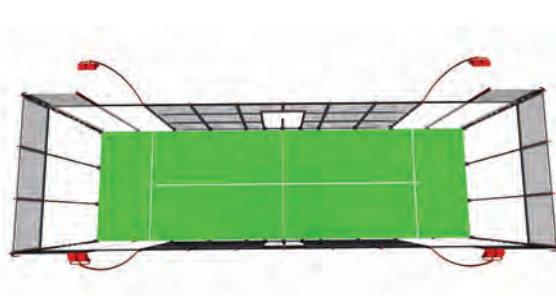
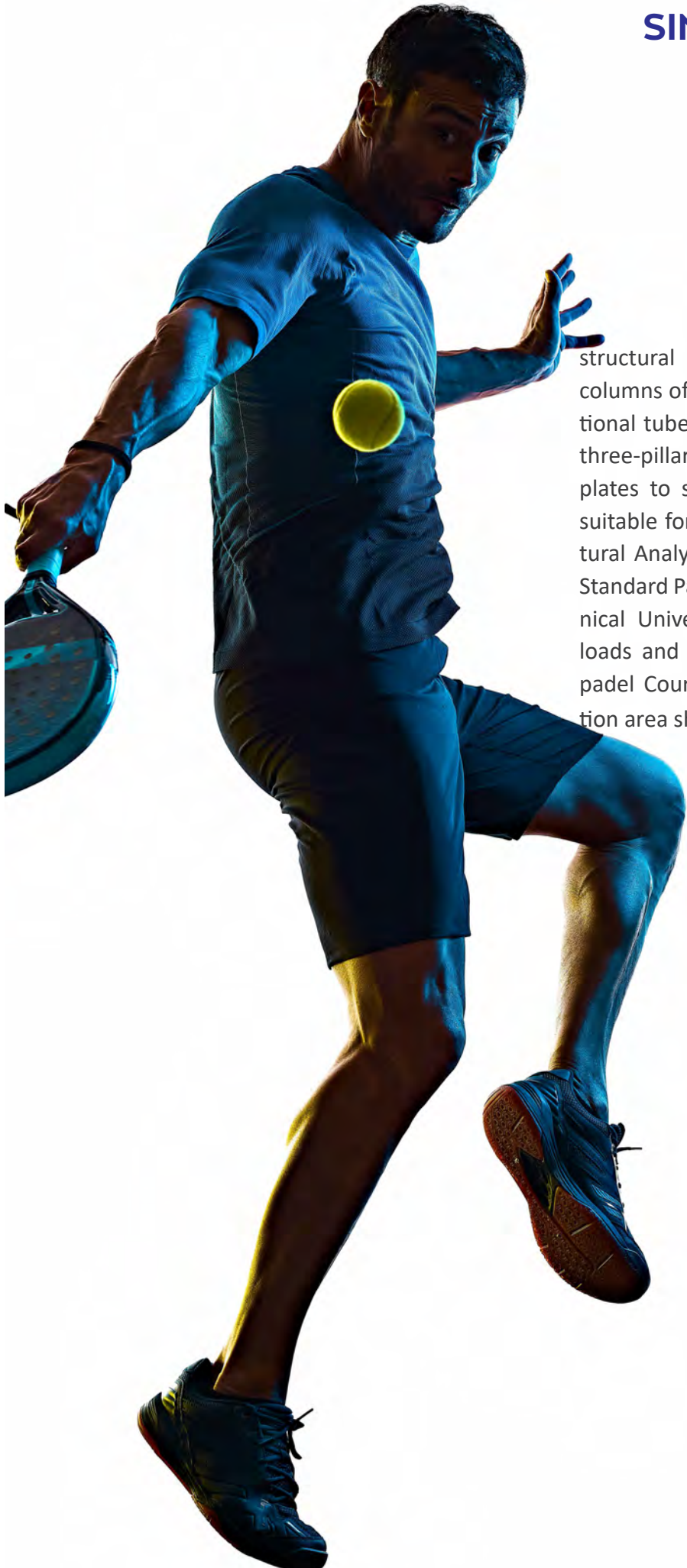

Table 1. TS498 Wind Load pressure values depending height

Height from ground m	Wind speed v m/s	Absorption q (kN/m ²)
0-8	28	0,5
9-20	36	0,8
21-100	42	1,1
<100	46	1,3

SINGLE COURT



Single padel court offers excellent structural stability against wind loads. All vertical columns of this construction are reinforced by an additional tube of 80 x 60 x 3 mm. Reinforced and solid three-pillar frame construction and reinforced foot-plates to secure an optimal stability. This model is suitable for outdoors and indoors. We offer the Structural Analysis Report for this construction "Unixpadel Standard Padel Court structure" study by Istanbul Technical University Technical departments against wind loads and man power impact. Measurement of the padel Court 20mx6,4m inside game area and foundation area shall be 20,9m x 10,9m.



WP CHALLENGE PADEL COURT



- **Glass Structure:** Exclusive Metakkic structure channel holding system for glass lift.
- **Mesh:** Electrowelded 50x50x3,65 mm; embedded in the pillars, to avoid injuries and irregular bounces.
- **Color:** To be chosen by the client. (Blue, Black, Green, Terracotta, White, Silver,)
- **Structure:** 160x160x4 mm. pillars duplicated at the corners and anchored to the ground with hilti type expansion plugs.
- **Finish:** Powder Electric galvanized paint. Optional: Hot Dip Galvanized.
- **Lighting poles:** Straight T shape, Sigmoidal K shape or Oval D shape.
- **Lighting:** 200w LED spotlights (26,000 lumens).
- **Turf:** 12mm Monofilament or textured.
- **Glass:** Tempered glass 12 mm.

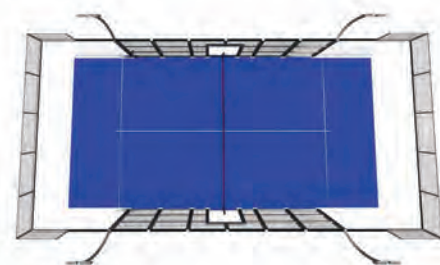
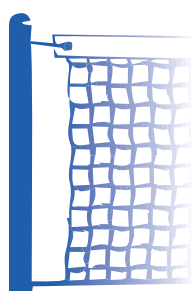
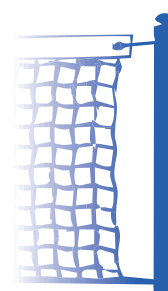

Table 1. TS498 Wind Load pressure values depending height



Height from ground m	Wind speed v m/s	Absorption q (kN/m ²)
0-8	28	0,5
9-20	36	0,8
21-100	42	1,1
<100	46	1,3





WP CHALLENGE padel court offers excellent structural stability against-wind loads. All vertical columns of this construction are reinforced by an additional tube of 160 x 160 x 4 mm. Reinforced and solid three-pillar frame construction and reinforced footplates to secure an optimal stability. This model is suitable for Indoors. We offer the Structural Analysis Report for this construction "padel WP CHALLENGE Padel Court structure" study by Istanbul Technical University Technical departments against wind loads and manpower impact. Measurement of the padel Court 20mx10m inside game area and foundation area shall be 20,9m x 10,9m. See different strength classes. As general wind load value it is given as 0,5kN/m² on Table 12 of TS498 as the highest point of the height of building is lower than 8 meters. (Figure 6, Table 1). As all sides of Padel play-ground are closed with glass, crosswinds can be considered to be effective. Total-ly 1.2q horizontal force is applied as 0,8q pressure and 0,4q absorption on both of the sides. Thus wind force is formed as $0,8 \times 0,5 = 0,4\text{kN/m}^2$ pressure and $0,4 \times 0,5 = 0,2\text{kN/m}^2$ absorption. This line is specially designed for outdoor and indoor use.

nix-



RETRACTABLE ROOF COVER SYSTEM

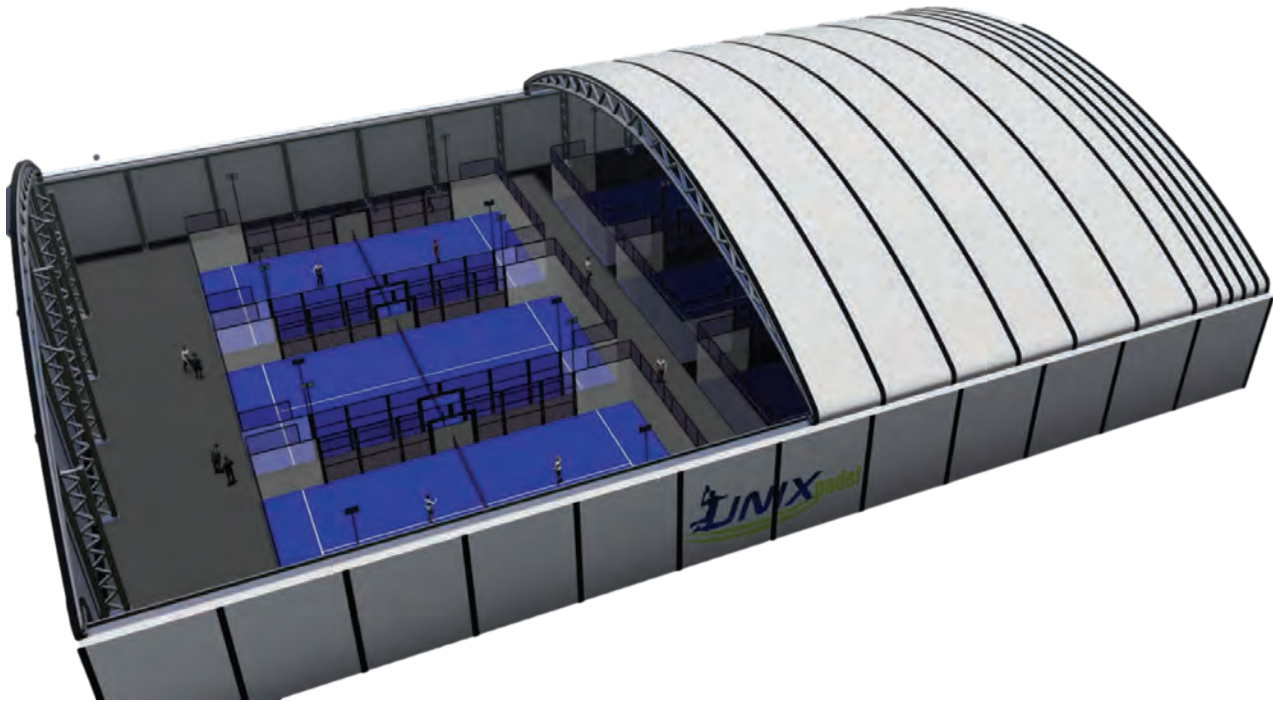

- **Retractable:** system on-off operation apply with automatically controlled motors.
- **Membrane:** 650 grm double layer. Membrane has flame impermeability feature.
- **Color:** To be chosen by the client. (Blue, Black, Green, Terrecoata, White, Silver,)
- **Retractable:** will made automaticcally open and close with special rail system.
- **Steel:** Will be subjected to painting and will gain anti-corrosion properties.
- **Structure:** Metallic construction system made by 30x30 profile trusses.
- **Finish:** Powder Electric galvanized paint. Optional: hot dip galvanized.
- **System:** Structure has Assembly and Disassembly feature

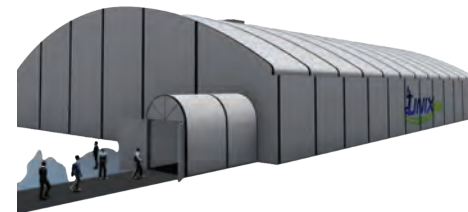
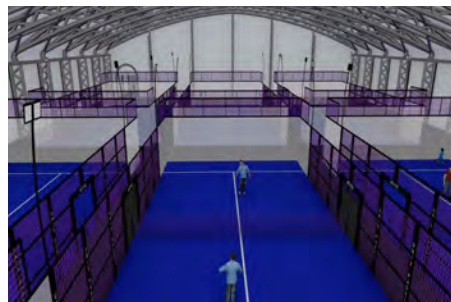
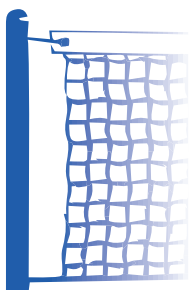
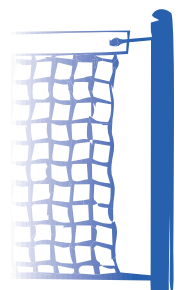

Table 1. TS498 Wind Load pressure values depending height



Height from ground m	Wind speed v m/s	Absorption q (kN/m ²)
0-8	28	0,5
9-20	36	0,8
21-100	42	1,1
<100	46	1,3



RETRACTABLE ROOF COVER SYSTEM

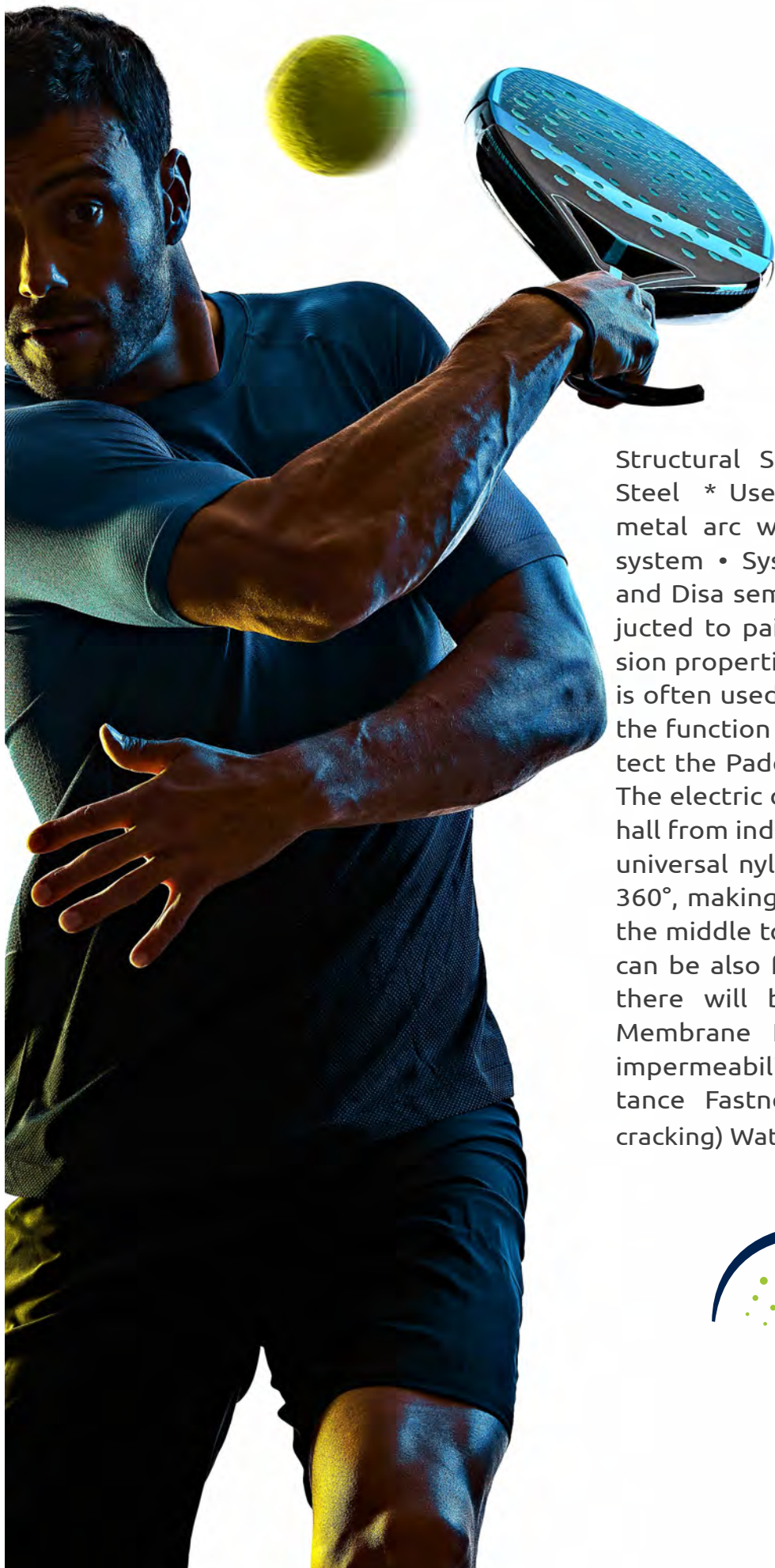

Structural Steel System Features. *ST37 Steel * Use production requirements gas metal arc welding and arc welding steel system • System: Structure has Assembly and Disassembly feature Steel: Will be subjected to painting and will gain anti-corrosion properties. Electric Push-Pull Structure is often used as the Padel court tent. It has the function of heat insulation and can protect the Padel court from the sun and rain. The electric design changes the padel court hall from indoor to outdoor easily. The solid universal nylon movable wheel can rotate 360°, making it easy to open the roof from the middle to both sides. The ceiling height can be also freely raised and lowered, and there will be a flexible internal space. Membrane Features: Unrobbed - Flame impermeability Anti-Fungal- High UV Resistance Fastness - Anti-Fracture (bending, cracking) Waterproof.



X HALF CLOSE CANOPY

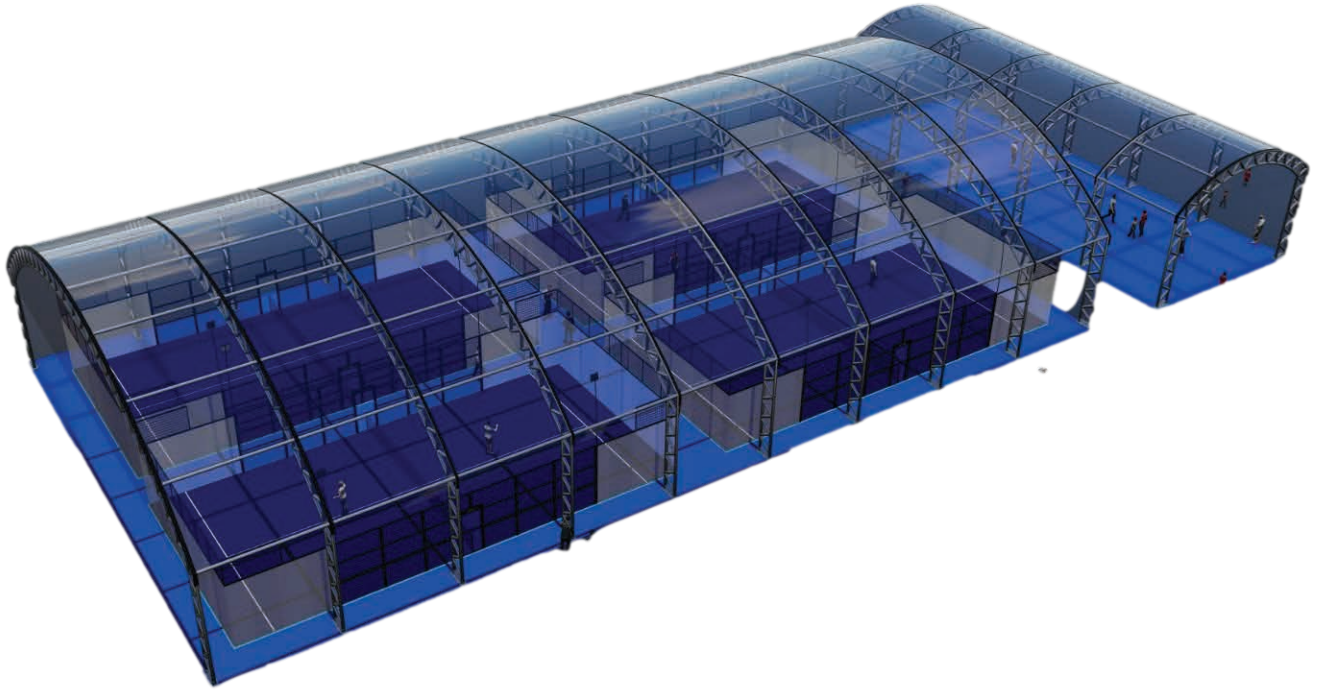

- **Bearers and Trusses:** ($\varnothing 89 \times 3 \text{mm}$ - $76 \times 3 \text{mm}$) Pipes are used.
- **Tarpaulin and wire Joints :** ($\varnothing 48 \times 3 \text{mm}$) Pipes are used
- **Truss Spacing Braces:** ($\varnothing 42 \times 2,5 \text{mm}$) Pipes are used
- **Wind Connectors:** ($42 \times 2,5 \text{mm}$) Pipes are used
- **Back-Goal Posts:**($\varnothing 76 \times 3 \text{mm}$)Pipes are used
- **Purlines:** ($\varnothing 34 \times 2 \text{mm}$) Pipes are used

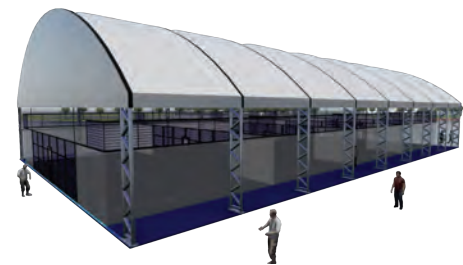
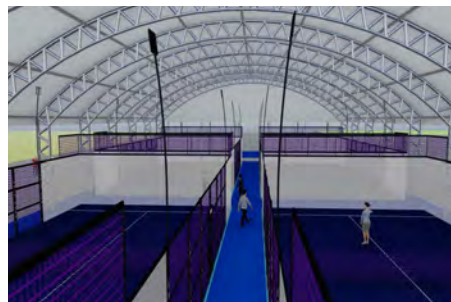
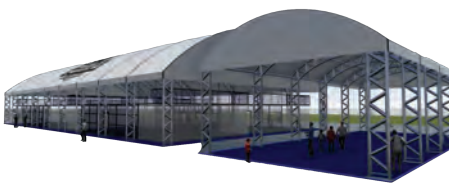
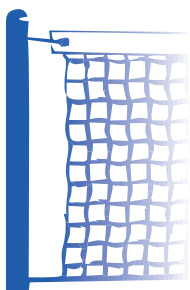
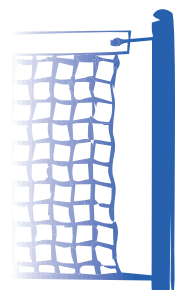

Table 1. TS498 Wind Load pressure values depending height



Height from ground m	Wind speed v m/s	Absorption q (kN/m ²)
0-8	28	0,5
9-20	36	0,8
21-100	42	1,1
<100	46	1,3





a-) 6m height vertical ($\varnothing 89 \times 3 \text{mm}$) paralleling pipes should be mounted by welding on 18 of gijon and nut (15mm) plates in metrics through an anchored with an interval of 3 meters of concrete right after the sub-base process.

b-) Steel plates (10 mm) are fixed by welding on the mounted columns.

c-) Truss will be welded in diagonal ($\varnothing 42 \times 2,5 \text{mm}$) shape between paralleling upper and lower pipes that are twisted ($\varnothing 76 \times 3 \text{mm}$) in accordance with the project.

d-) The Truss on the post is welded in to the bevelled sheet panels (10mm) by a lifter.

e-) Then the purlines ($\varnothing 34 \times 2 \text{mm}$) made by pipes should be mounted into the truss.

f-) The paralleling vertical pipes ($\varnothing 76 \times 3 \text{mm}$) should be mounted on the back-goal.

g-) After constructing the main frame, wind joints and braces ($\varnothing 42 \times 2,5 \text{mm}$) are mounted between the Truss in a suitable way.

h-) Taurpulin and wire connection pipes are mounted with welding by using ($\varnothing 48 \times 3 \text{mm}$) size of pipe.

i-) One hinged door made of ($\varnothing 48 \times 3 \text{mm}$) pipe size is installed at the proper place in to the steel construction.

j-) Also the goal post is installed by using pipe size ($\varnothing 89 \times 3 \text{mm}$) with desired measurement for the field.

k-) Whole iron production which combines the properties of the finish of lacquer and anti-rust is painted with special syhtethic resin based paint (light gray)

Membrane Features:

Unrobbed- Flame impermeability

Anti-Fungal- High UV Resistance

Fastness- Anti-Fracture (bending, cracking)

- **Membrane:** 650 grm double layer.

Waterproof Membrane has flame impermeability feature



CANOPY FULL MEMBRANE COVER

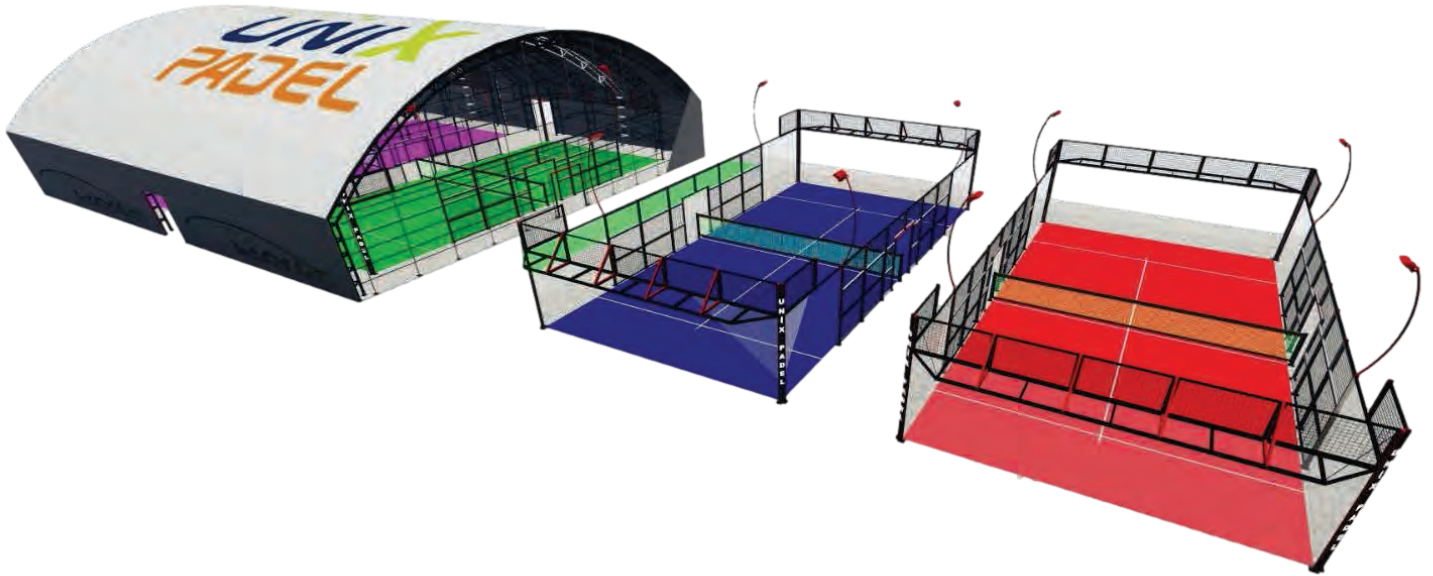

- **Structure:** PADEL Membrane is the unique Sport membrane system which ensures the structural stability, excellent thermal insulation, ultimate strength and amazing flexibility at the same time. The combination of the latest materials and technologies used in UNIXPAEL padel canopy will result in low operating costs.
- **Retractable:** system on-off operation apply with automatically controlled motors.
- **Membrane:** 650 grm double layer. Membrane has flame impermeability feature.
- **Color:** To be chosen by the client. (Blue, Black, Green, Terracotta, White, Silver,)
- **Retractable:** will made automaticcally open and close with special rail system.
- **Steel:** Will be subjected to painting and will gain anti-corrosion properties.
- **Finish:** Powder Electric galvanized paint. Optional: hot dip galvanized.
- **System:** Structure has Assembly and Disassembly feature.



Table 1. TS498 Wind Load pressure values depending height

Height from ground m	Wind speed v m/s	Absorption q (kN/m ²)
0-8	28	0,5
9-20	36	0,8
21-100	42	1,1
<100	46	1,3

CANOPY FULL MEMBRANE COVER



- Avoid direct sunlight in the central hours of the day
- Extremely low U-Value. Significant energy savings
- A unique system with two independent layers
- Rock-solid design with double pressure lock
- Electric cables hidden between membrane
- UV, chemical and weather resistant fabrics
- Effective system upgrade (at any time)
- Allows padel practice in rainy season
- Environmentally friendly, Recyclable
- Easy installation/dismantling
- No condensation
- Higher side walls
- Long lifespan

X CANOPY SIDE TRANSPARENT



- **Bearers and Trusses:** ($\varnothing 89 \times 3 \text{mm}$ - $76 \times 3 \text{mm}$) Pipes are used.
- **Tarpaulin and wire Joints :** ($\varnothing 48 \times 3 \text{mm}$) Pipes are used
- **Truss Spacing Braces :** ($\varnothing 42 \times 2,5 \text{mm}$) Pipes are used
- **Wind Connectors :** ($42 \times 2,5 \text{mm}$) Pipes are used
- **Back-Goal Posts:**($\varnothing 76 \times 3 \text{mm}$)Pipes are used
- **Purlines :** ($\varnothing 34 \times 2 \text{mm}$) Pipes are used

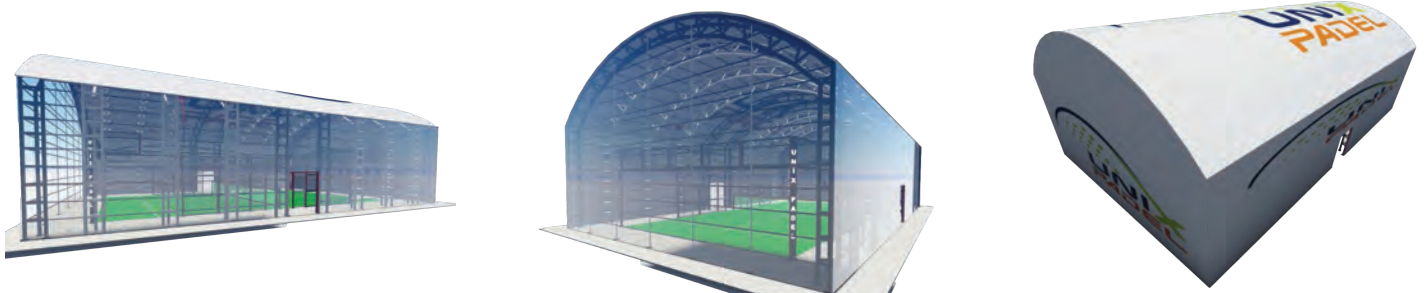

Table 1. TS498 Wind Load pressure values depending height

Height from ground m	Wind speed v m/s	Absorption q (kN/m ²)
0-8	28	0,5
9-20	36	0,8
21-100	42	1,1
<100	46	1,3

CANOPY SIDE TRANSPARENT



Frameworks: High strength Metal whose use life can be more than 20 years if maintains well. Surface anodized oxidation film thickness of 11μ m-17μm; Hardness reaches more than 14.5HW after oxidation; Wind load: 100km/hour Characteristic Of Padel Court Tent Cover: 850g/sq.m Double PVC coated polyester textile, opaque. It is high quality at waterproof, flame retardant to DIN4102 B1,M2,U V resistant. Lifespan is about 8 years. Sidewalls Of The Padel Court Tent:650g/sq.m white PVC fabric sidewalls, ABS plastic hard walls, tempered glass hard walls, Sandwich board hard walls, steel sheet hard wal



ADL X3T is a semi-sanded, very dense grass turf with texturized monofilament fibres. Thanks to the specific shape, the fibres remain in place which results in a stable playing surface with the perfect balance between grip and slide. Arsturf filament improves the characteristics related to the friction, the resilience and the resistance to abrasive wear. According to the characteristics of the filament and the models ensure the durability and the resistance. Padel is an intense sport on a small playing surface where movements are fast and effective.

Yarn Dtex: 7300 Dtex Curled PP filament
Yarn Height: 12mm
Approve: FIP
Infill: Sand

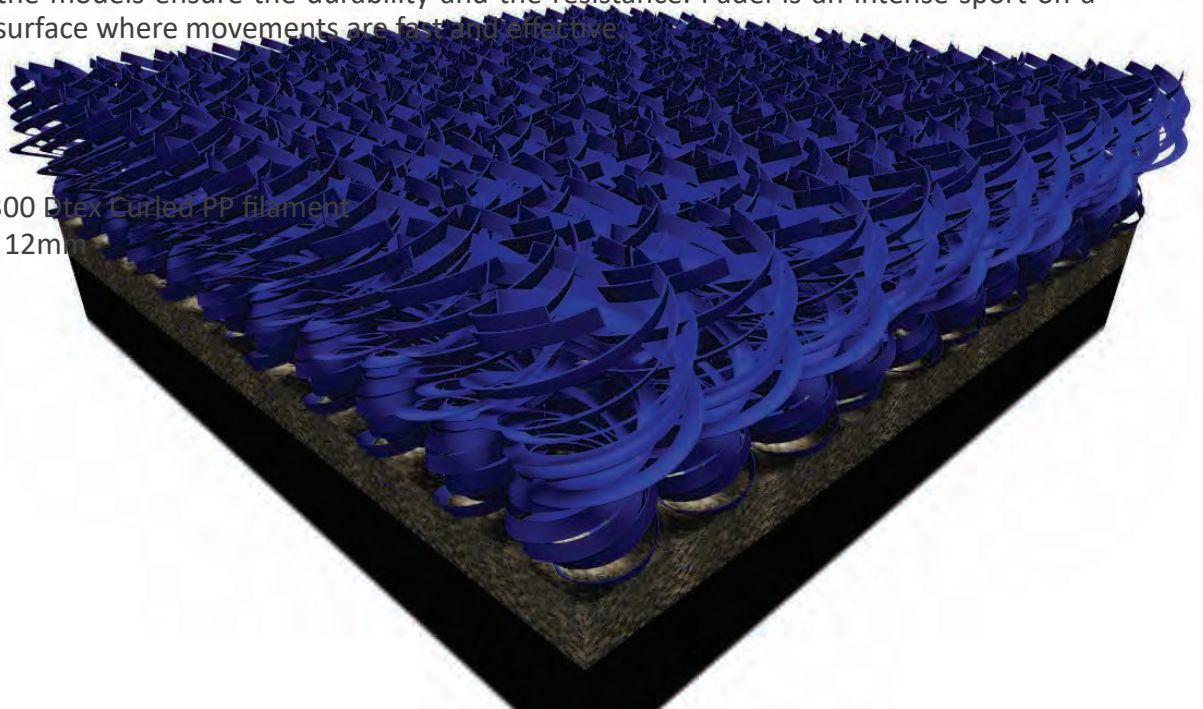



CLEEK Artificial turf system is consisting of Arstruf prefrillated polypropylene filaments. The Arsturf filament improves the characteristics related to the friction, the resilience and the resistance to abrasive wear. According to the characteristics of the filament and the models ensure the durability and the resistance. Cleek is designed specially by Ars Sport Padel for Tennis surface, multi-sport, Hockey or noninfill indoor sport surface.

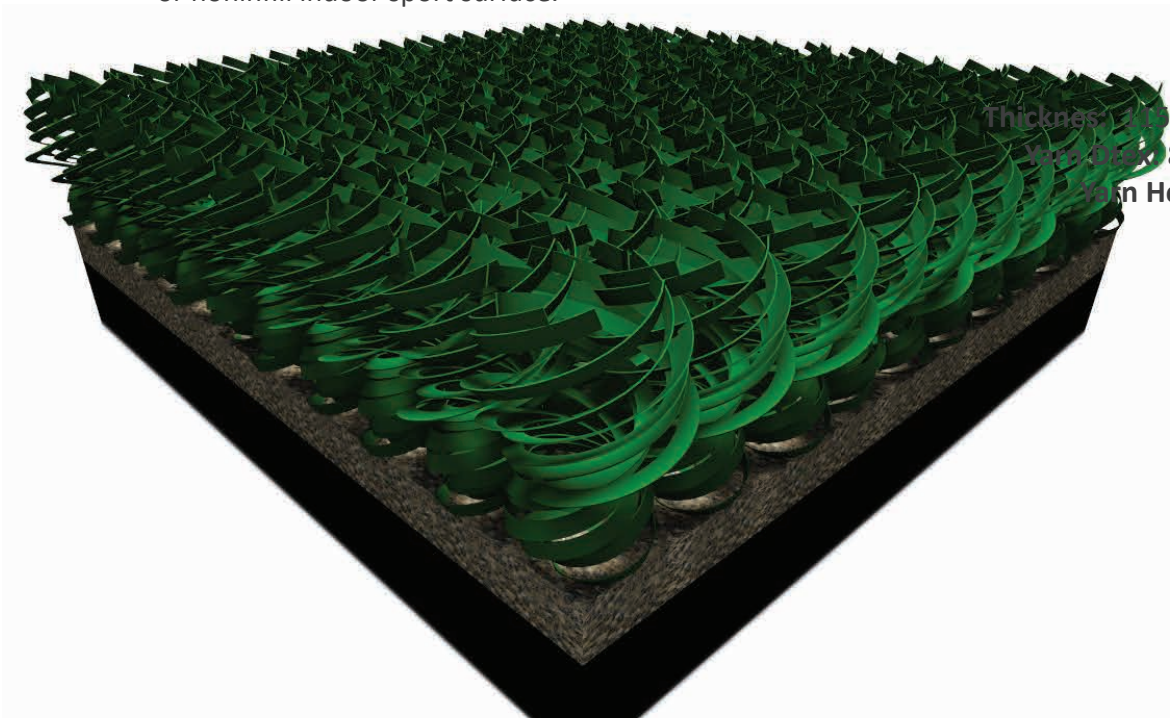

Thickness: 20 micron, 1mm width
Yarn Count: 8000 Mono filament
Stitch Height: 12mm-15mm
Flament: 1 filament
Infill: Sand



ADL X4T Artificial turf system is consisting of Arstruf prebrillated polypropylene filaments and fine tuned system with foam shockpad layer. The Arsturf filament improves the characteristics related to the friction, the resilience and the resistance to abrasive wear. According to the characteristics of the filament and the models ensure the durability and the resistance.

Approve: FIP Padel Federation Standart
Yarn Dtex: 9600 Dtex Curled
Yarn Height: 12mm-13mm
Infill: Sand

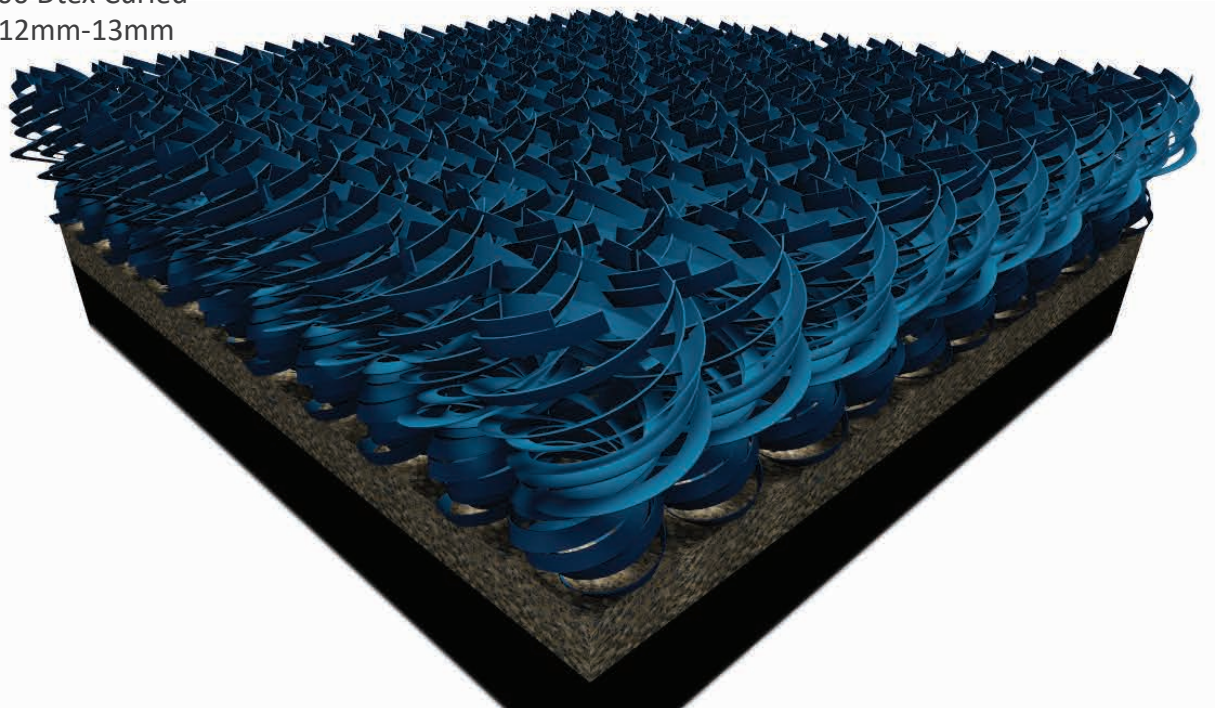



ADL X4T Artificial turf system is consisting of Ars turf prefibrillated curly polypropylene filaments. The Arsturf filament improves the characteristics related to the friction, the resilience and the resistance to abrasive wear. According to the characteristics of the filament and the models ensure the durability and the resistance. ADL X4T is designed and patented special by Ars Sport Padel for Tennis surface, non infill sport surface.

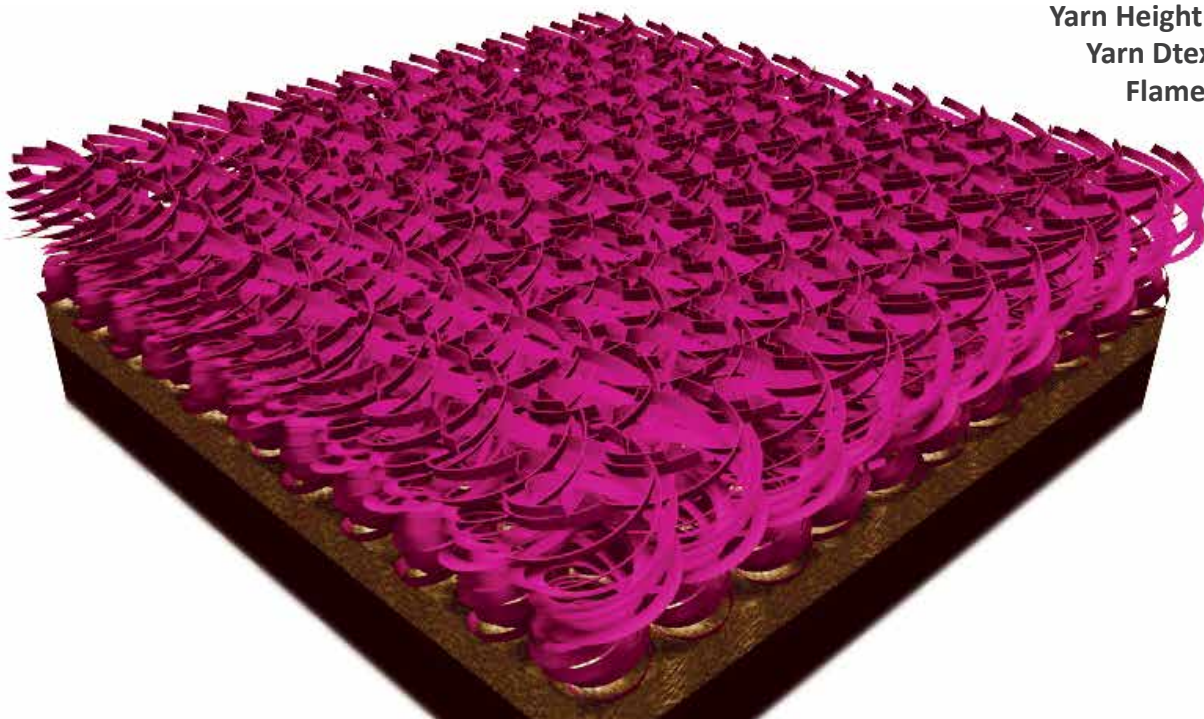

Yarn Height: 12-13-15mm

Yarn Dtex: 9600 Curled

Flament: 8 Flament

Approve: FIP

Infill: Sand



ADL 4XT Artificial turf system is consisting of Arstruf prebrillated polypropylene filaments. The Arsturf filament improves the characteristics related to the friction, the resilience and the resistance to abrasive wear. According to the characteristics of the filament and the models ensure the durability and the resistance. ADL 4XT is designed specially by Ars Sport Padel for Tennis surface, multi-sport, Hockey or noninfill indoor sport surface.

Thicknes: 115 micron, 1mm width
Yarn Dtex: 8000 Mono filament
Yarn Height: 12mm-15mm
Flament: 1 filament
Infill: Sand

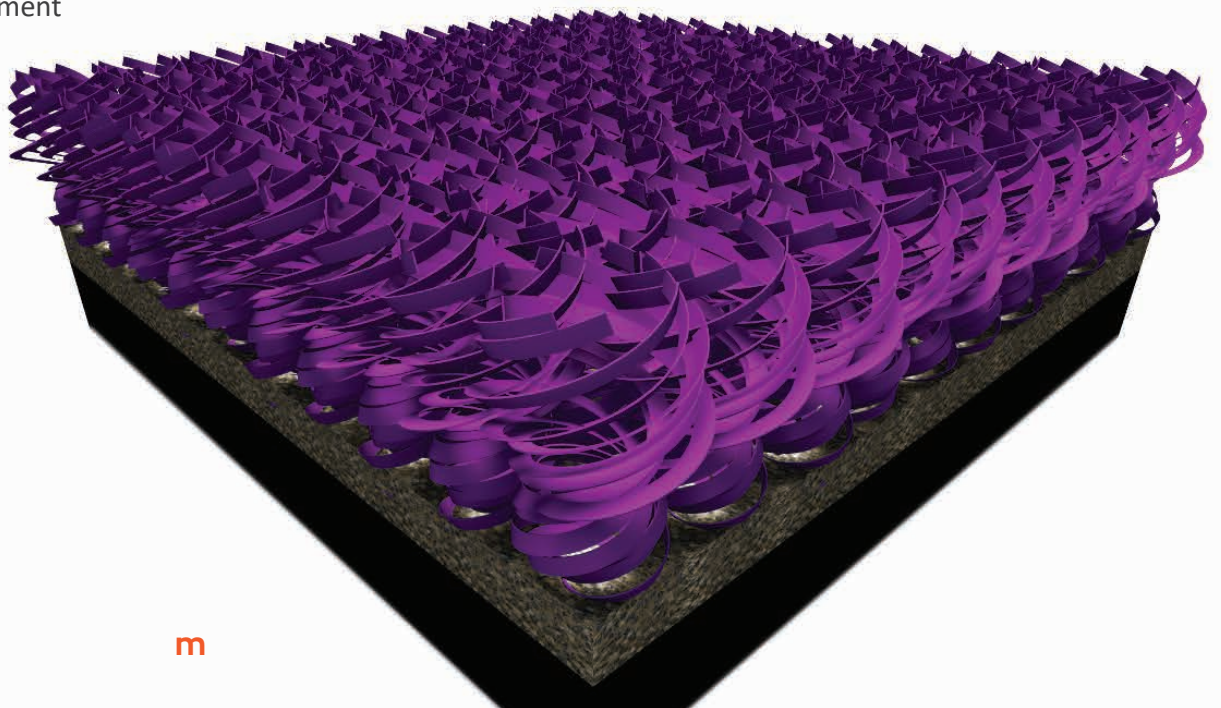



ADL X2T Artificial turf system is consisting of Ars turf prefibrillated curly polypropylene filaments. The Arsturf filament improves the characteristics related to the friction, the resilience and the resistance to abrasive wear. According to the characteristics of the filament and the models ensure the durability and the resistance. ADL X2T is designed and patented special by Ars Sport Padel for Tennis surface, non infill sport surface.

Yarn Height: 12-13-15mm

Yarn Dtex: 6800 Curled

Flament: 8 filament

Infill: Sand

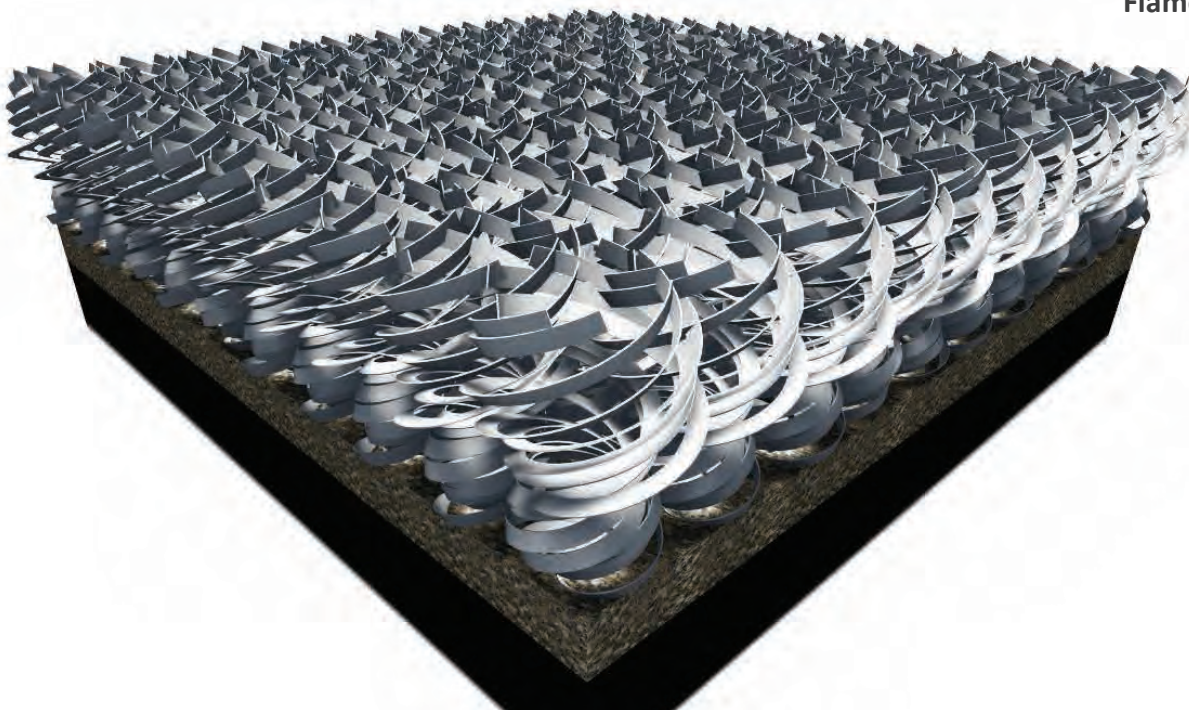



The net is made from our famous knotless polypropylene netting and has a diameter of 3mm with a mesh size of 45mm. Across the top of the net there is a PES headband measuring 50mm wide. Stitched into the headband is a PVC coated tension cable which can be used to hand the net to posts at each end. The measurements of this padel tennis net are 10m (w) x 0.92m (h)

High tenacity polypropylene,
knotless 45mm mesh
10m (w) x 0.92m (h)
Technical Specs
3mm diameter
Padel tennis net





Body	Aluminium injection	Input Voltage(V)	220-240	Frequency (Hz)	50-60
LED	SMD Mid Power, Power LED	Colour Ren. In. (CRI)	>70	IP Protection	IP65
Reflector	Highly reflective	Power Fac. (cos ϕ)	>0.95	RAL Code	9005
Diffuser	Tempered glass	Options	DALI and 1-10V dim application. Different RAL code electrostatic powder coating. Differently-angled lens and reflector application according to desired correlated colour temperature (CCT)		
Driver	ENEC certified				

Product Details

Code No	Power (W)	Luminus Flux (lm)	Colour Temp. (K)	Luminous Effic (lm/W)	Dimensions (mm) a b c	Pcs/Pack	Package Vol. (m ³)	Package Weight (kg)
106518	150	13750	6500	110	342x342x121	1	0,015	5
109536	200	20000	5700	100	415x360x85	1	0,017	4
109537	300	30000	5700	100	415x540x85	1	0,02	6

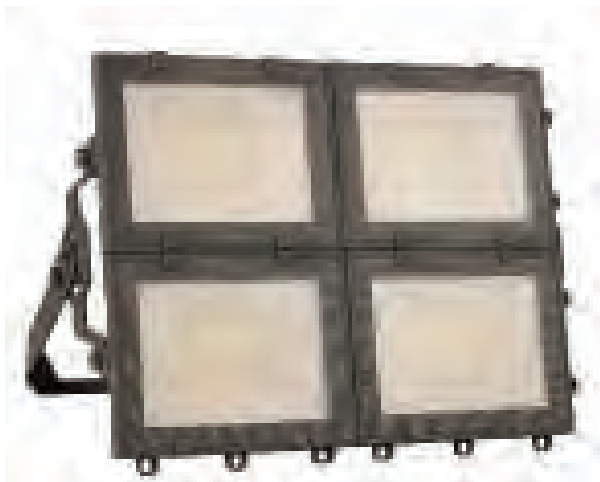



PADEL