

BOS 18M-PA-1PD-E5-C-S4
Ordering code: BOS0049

Diffuse sensor
 Series 18M
 Working Range: 0...400 mm

PNP (2x), NO-NC (pins 4-2)
 Infrared
 DC, direct current

BALLUFF
sensors worldwide

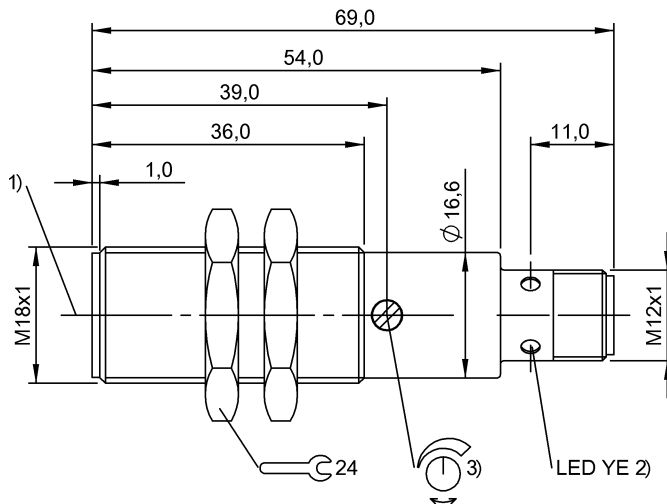
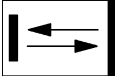

1) Optical axis, 2) Output function, 3) Sn

Characteristic data

Operating voltage	10...30 V DC
Connection	Connector, M12x1-S04
Switching freq. f max.	100 Hz
Indicator	Output function - LED RD
Setting	Switching distance (Sn)
Adjuster	Potentiometer 270° (1x)
Short-circuit protected	yes
Protected against polarity reversal	yes
Enclosure Type per IEC 60529	IP67

Optical data

Principle of optical operation	Light scanner, energetic
Switching function, optical	NO light-on - NC dark-on
Light type	Infrared
Wavelength	880 nm
Ambient light max.	5,000 Lux

Electrical data

Rated operating voltage Ue DC	24 V
Effective operating current Ie	200 mA
Rated insulation voltage Ui	75 V DC
Load capacitance max. (at Ue)	0,3 µF
Ripple max. (% of Ue)	10
Switching output	PNP (2x)
Switching function	NO-NC (pins 4-2)
Turn-off delay toff max.	5 ms
Turn-on delay ton max.	5 ms

No-load current max. Io at Ue	20 mA
Voltage drop Ud max. (at Ie)	2,5 V

Mechanical data

Eff. switching distance Sr	400 mm
Capture range Sd	0...400 mm
Beam characteristic	Divergent
Range Sn	Sn = 400 mm, adjustable
Minimum operating distance	0 mm
Connector type	M12x1-S04
Sensing surface material	PMMA
Housing material	Brass
Oberflächenschutz	Nickel-plated
Mounting type	Nut M18x1
Design	Cylinder, straight optics
Ambient temperature	-5...55 °C
Tightening torque	35 Nm

Basic data

Basic standard IEC 60947-5-2
 Additional features Base unit for fibre optics BFO 18..
 The sensor is functional again after the overload has been eliminated.
 Reference object (target): Gray card, 200 x 200, 90 % remission, axial approach.
 Only for NFPA 79 applications (machines with a supply voltage of maximum 600 volts). Device shall be connected only by using any R/C (CYJV2) cord, having suitable ratings.
 Order accessories separately.

BOS 18M-PA-1PD-E5-C-S4
Ordering code: BOS0049

Diffuse sensor
Series 18M
Working Range: 0...400 mm

PNP (2x), NO-NC (pins 4-2)
Infrared
DC, direct current

BALLUFF
sensors worldwide

